

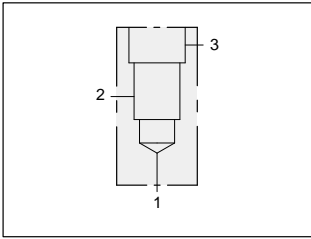

LINE MOUNT BODIES



- Aluminium rated to 210 bar and SG Iron rated to 350 bar.



90 degree body.

T-2A Cavity
Locating Shoulder
Depth 20,6 mm.

Mounting Holes:
10,7 mm. diameter
through hole.
2 places.

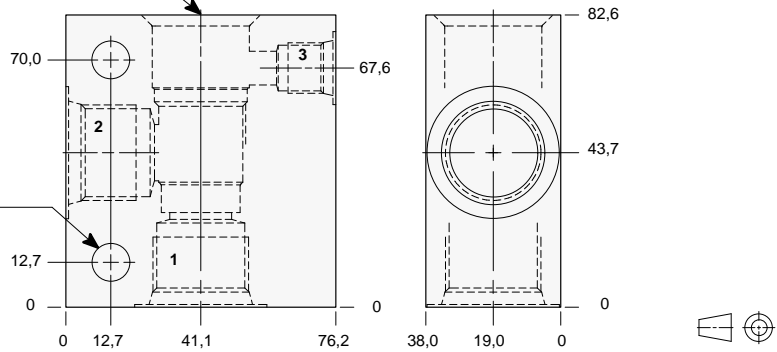

TYPICAL CARTRIDGES USED WITH THIS BODY

RVEA - ***	Page	1.18
RSFC - ***	Page	2.06
SQFB - ***	Page	2.08
RSFE - ***	Page	2.10
SCEA - ***	Page	2.12
PBFB - ***	Page	3.06
PBFC - ***	Page	3.08
CBEA - ***	Page	4.10
CBEG - ***	Page	4.12
CBEH - ***	Page	4.14
CKEB - ***	Page	4.14
LOFC - ***	Page	9.08
LKFC - ***	Page	9.10
LPFC - ***	Page	9.12
LRFC - ***	Page	9.14
COFA - ***	Page	10.12

Instructions for ordering complete cartridge and body assemblies. Page viii

Pressure ratings, material specifications. Page 11.02

Ports 1 & 2	Port 3	ALUMINIUM		SG IRON	
		Model Code	List Price	Model Code	List Price
.25 NPTF	.25 NPTF	BCA		BCA/S	
.375 NPTF	.25 NPTF	BCB		BCB/S	
.50 NPTF	.25 NPTF	BCC		BCC/S	
.75 NPTF	.25 NPTF	BCD		BCD/S	
SAE-6	SAE-6	BCI		BCI/S	
SAE-8	SAE-6	BCJ		BCJ/S	
SAE-10	SAE-6	BCK		BCK/S	
SAE-12	SAE-6	BCL		BCL/S	
.25 BSPP	.25 BSPP	BCT		BCT/S	
.375 BSPP	.25 BSPP	BCU		BCU/S	
.50 BSPP	.25 BSPP	BCV		BCV/S	
.75 BSPP	.25 BSPP	BCW		BCW/S	

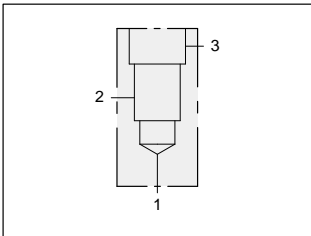

90 degree body with high capacity port 3.

T-2A Cavity
Locating Shoulder
Depth 20,6 mm.

Mounting Holes:
10,7 mm. diameter
through hole.
2 places.

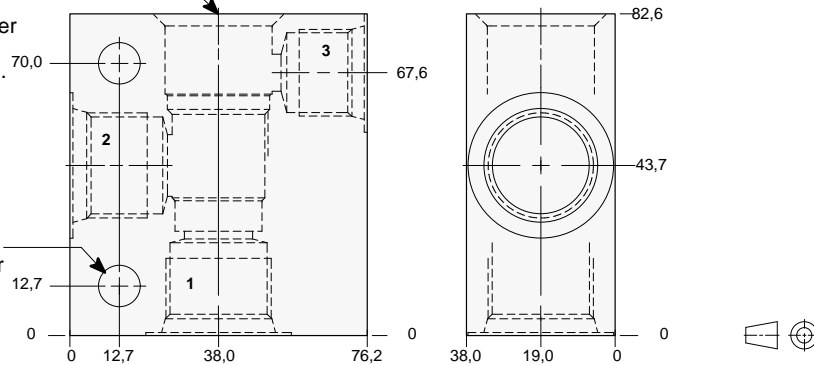

TYPICAL CARTRIDGES USED WITH THIS BODY

PPFB - ***	Page	3.10
PPFC - ***	Page	3.12
FRDA - ***	Page	6.02
DPCA - ***	Page	8.06
DPCB - ***	Page	8.07
DPCC - ***	Page	8.08
DPCD - ***	Page	8.09

Instructions for ordering complete cartridge and body assemblies. Page viii

Pressure ratings, material specifications. Page 11.02

Ports 1 & 2	Port 3	ALUMINIUM		SG IRON	
		Model Code	List Price	Model Code	List Price
.375 NPTF	.375 NPTF	BAB		BAB/S	
.50 NPTF	.50 NPTF	BAC		BAC/S	
.75 NPTF	.50 NPTF	BAD		BAD/S	
SAE-8	SAE-8	BAJ		BAJ/S	
SAE-10	SAE-10	BAK		BAK/S	
SAE-12	SAE-10	BAL		BAL/S	
.375 BSPP	.375 BSPP	BAU		BAU/S	
.50 BSPP	.50 BSPP	BAV		BAV/S	
.75 BSPP	.50 BSPP	BAW		BAW/S	



LINE MOUNT BODIES



- Aluminium rated to 210 bar and SG Iron rated to 350 bar.

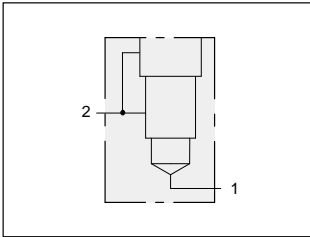

Body with port 3 connected to port 2.

T-2A Cavity
Locating Shoulder
Depth 18,3 mm.

Mounting Holes:
10,7 mm. diameter
through hole.
2 places.

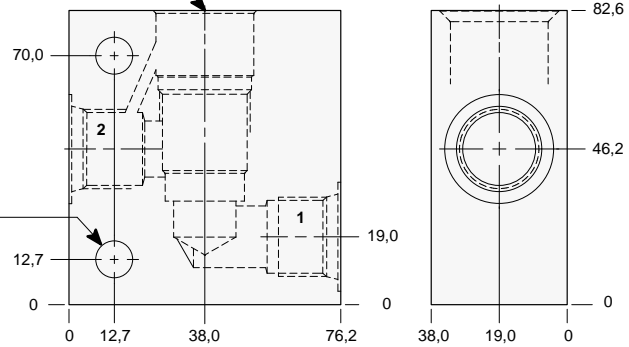

TYPICAL CARTRIDGES USED WITH THIS BODY

CBEA - ***	Page	4.10
CBEG - ***	Page	4.12
CBEH - ***	Page	4.14

Instructions for ordering complete cartridge and body assemblies. Page viii
Pressure ratings, material specifications. Page 11.02

All Ports	ALUMINIUM		SG IRON	
	Model Code	List Price	Model Code	List Price
.25 NPTF	BDA		BDA/S	
.375 NPTF	BDB		BDB/S	
.50 NPTF	BDC		BDC/S	
.75 NPTF	BDD		BDD/S	
SAE-6	BDI		BDI/S	
SAE-8	BDJ		BDJ/S	
SAE-10	BDK		BDK/S	
.25 BSPP	BDT		BDT/S	
.375 BSPP	BDU		BDU/S	
.50 BSPP	BDV		BDV/S	
.75 BSPP	BDW		BDW/S	



LINE MOUNT BODIES



- Aluminium rated to 210 bar and SG Iron rated to 350 bar.

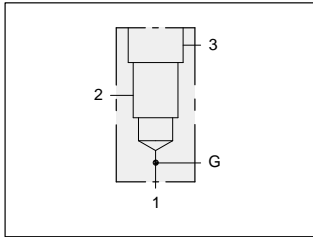

90 degree body with gauge port.

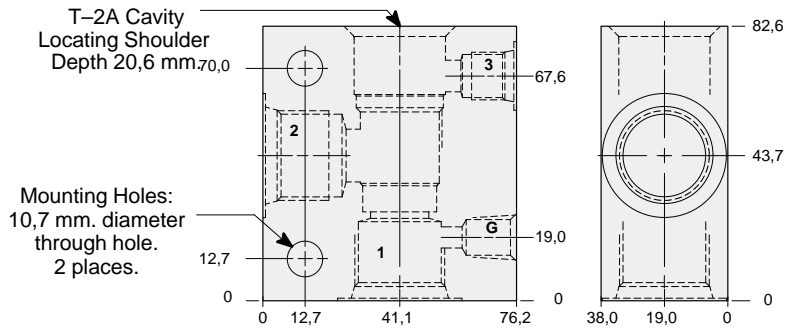

TYPICAL CARTRIDGES USED WITH THIS BODY

RVEA - ***	Page	1.18
RSFC - ***	Page	2.06
SQFB - ***	Page	2.08
RSFE - ***	Page	2.10
SCEA - ***	Page	2.12
PBFB - ***	Page	3.06
PBFC - ***	Page	3.08
LOFC - ***	Page	9.08
LKFC - ***	Page	9.10
LPFC - ***	Page	9.12
LRFC - ***	Page	9.14
COFA - ***	Page	10.12

Instructions for ordering complete cartridge and body assemblies. Page viii

Pressure ratings, material specifications. Page 11.02

Ports 1 & 2	Port 3	Gauge Port	ALUMINIUM		SG IRON	
			Model Code	List Price	Model Code	List Price
.25 NPTF	.25 NPTF	.25 NPTF	BFA		BFA/S	
.375 NPTF	.25 NPTF	.25 NPTF	BFB		BFB/S	
.50 NPTF	.25 NPTF	.25 NPTF	BFC		BFC/S	
.75 NPTF	.25 NPTF	.25 NPTF	BFD		BFD/S	
SAE-6	SAE-6	.25 NPTF	BFI		BFI/S	
SAE-8	SAE-6	.25 NPTF	BFJ		BFJ/S	
SAE-10	SAE-6	.25 NPTF	BFK		BFK/S	
SAE-12	SAE-6	.25 NPTF	BFL		BFL/S	
.25 BSPP	.25 BSPP	.25 BSPP	BFT		BFT/S	
.375 BSPP	.25 BSPP	.25 BSPP	BFU		BFU/S	
.50 BSPP	.25 BSPP	.25 BSPP	BFV		BFV/S	
.75 BSPP	.25 BSPP	.25 BSPP	BFW		BFW/S	

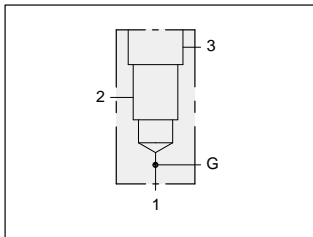

90 degree body with high capacity port 3 and gauge port.

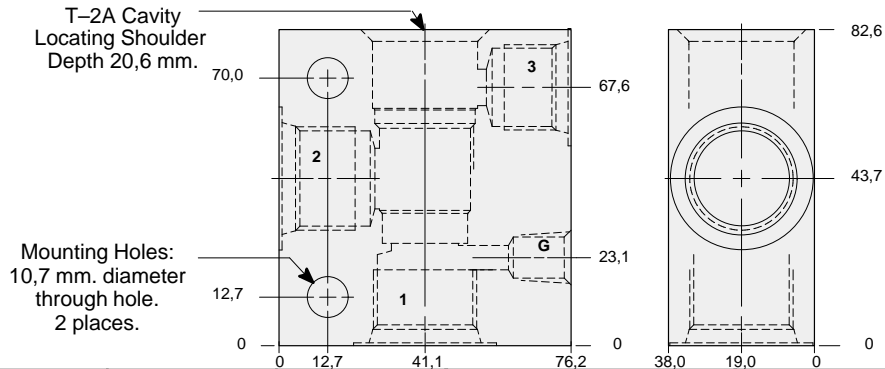

TYPICAL CARTRIDGES USED WITH THIS BODY

PPFB - ***	Page	3.10
PPFC - ***	Page	3.12
DPCA - ***	Page	8.06
DPCB - ***	Page	8.07
DPCC - ***	Page	8.08
DPCD - ***	Page	8.09

Instructions for ordering complete cartridge and body assemblies. Page viii

Pressure ratings, material specifications. Page 11.02

Ports 1 & 2	Port 3	Gauge Port	ALUMINIUM		SG IRON	
			Model Code	List Price	Model Code	List Price
.375 NPTF	.375 NPTF	.25 NPTF	BLB		BLB/S	
.50 NPTF	.50 NPTF	.25 NPTF	BLC		BLC/S	
.75 NPTF	.50 NPTF	.25 NPTF	BLD		BLD/S	
SAE-6	SAE-6	.25 NPTF	BLI		BLI/S	
SAE-8	SAE-8	.25 NPTF	BLJ		BLJ/S	
SAE-10	SAE-10	.25 NPTF	BLK		BLK/S	
SAE-12	SAE-10	.25 NPTF	BLL		BLL/S	
.375 BSPP	.375 BSPP	.25 BSPP	BLU		BLU/S	
.50 BSPP	.50 BSPP	.25 BSPP	BLV		BLV/S	
.75 BSPP	.50 BSPP	.25 BSPP	BLW		BLW/S	



LINE MOUNT BODIES



- Aluminium rated to 210 bar and SG Iron rated to 350 bar.

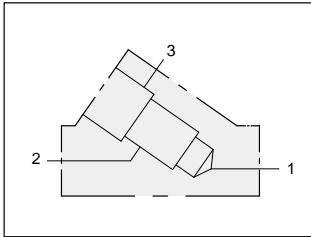

Inline body.

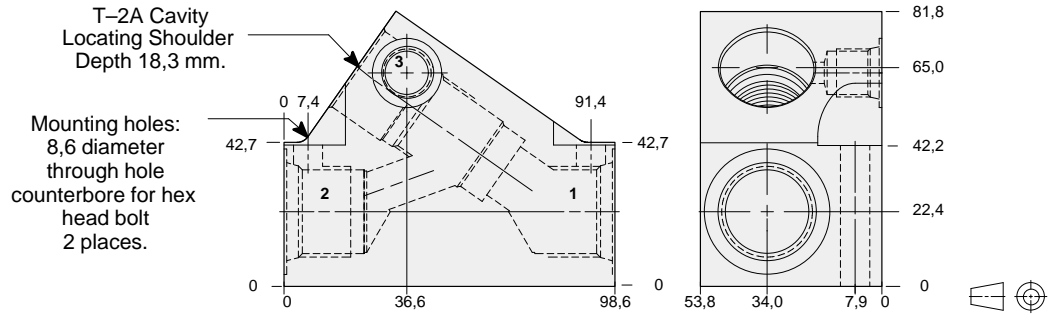

TYPICAL CARTRIDGES USED WITH THIS BODY

RVEA - ***	Page	1.18
RSFC - ***	Page	2.06
SQFB - ***	Page	2.08
RSFE - ***	Page	2.10
SCEA - ***	Page	2.12
PBFB - ***	Page	3.06
PBFC - ***	Page	3.08
CBEA - ***	Page	4.10
CBEG - ***	Page	4.12
CBEH - ***	Page	4.14
CKEB - ***	Page	4.14
LOFC - ***	Page	9.08
LKFC - ***	Page	9.10
LPFC - ***	Page	9.12
LRFC - ***	Page	9.14
COFA - ***	Page	10.12

Instructions for ordering complete cartridge and body assemblies. Page viii
 Pressure ratings, material specifications. Page 11.02

Ports 1 & 2	Port 3	ALUMINIUM		SG IRON	
		Model Code	List Price	Model Code	List Price
.25 NPTF	.25 NPTF	BVA		BVA/S	
.375 NPTF	.25 NPTF	BVB		BVB/S	
.50 NPTF	.25 NPTF	BVC		BVC/S	
.75 NPTF	.25 NPTF	BVD		BVD/S	
SAE-6	SAE-6	BVI		BVI/S	
SAE-8	SAE-6	BVJ		BVJ/S	
SAE-10	SAE-6	BVK		BVK/S	
SAE-12	SAE-6	BVL		BVL/S	
.25 BSPP	.25 BSPP	BVT		BVT/S	
.375 BSPP	.25 BSPP	BVU		BVU/S	
.50 BSPP	.25 BSPP	BVV		BVV/S	
.75 BSPP	.25 BSPP	BVW		BVW/S	

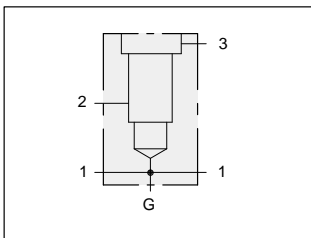

Through port body with gauge port.

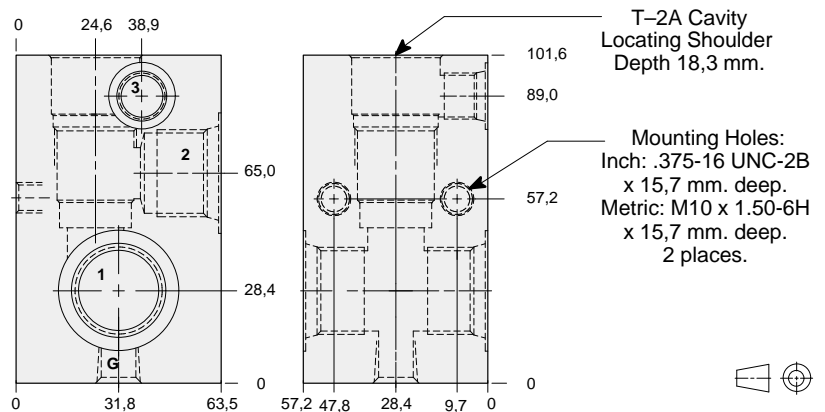

TYPICAL CARTRIDGES USED WITH THIS BODY

RVEA - ***	Page	1.18
RSFC - ***	Page	2.06
SQFB - ***	Page	2.08
RSFE - ***	Page	2.10
SCEA - ***	Page	2.12
PBFB - ***	Page	3.06
PBFC - ***	Page	3.08

Instructions for ordering complete cartridge and body assemblies. Page viii
 Pressure ratings, material specifications. Page 11.02

Mounting Hole Dimensions	Ports 1 & 2	Port 3	Gauge Port	ALUMINIUM		SG IRON	
				Model Code	List Price	Model Code	List Price
Inch	.375 NPTF	.25 NPTF	.25 NPTF	BHB		BHB/S	
Inch	.50 NPTF	.25 NPTF	.25 NPTF	BHC		BHC/S	
Inch	.75 NPTF	.25 NPTF	.25 NPTF	BHD		BHD/S	
Inch	SAE-8	SAE-6	.25 NPTF	BHJ		BHJ/S	
Inch	SAE-10	SAE-6	.25 NPTF	BHK		BHK/S	
Inch	SAE-12	SAE-6	.25 NPTF	BHL		BHL/S	
Metric	.375 BSPP	.25 BSPP	.25 BSPP	BHU		BHU/S	
Metric	.50 BSPP	.25 BSPP	.25 BSPP	BHV		BHV/S	
Metric	.75 BSPP	.25 BSPP	.25 BSPP	BHW		BHW/S	



LINE MOUNT BODIES



- Aluminium rated to 210 bar and SG Iron rated to 350 bar.

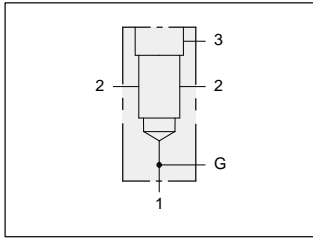

TYPICAL CARTRIDGES USED WITH THIS BODY

- PBFB - *** Page 3.06
- PBFC - *** Page 3.08

Instructions for ordering complete cartridge and body assemblies. Page viii

Pressure ratings, material specifications. Page 11.02

Through port body with gauge port.

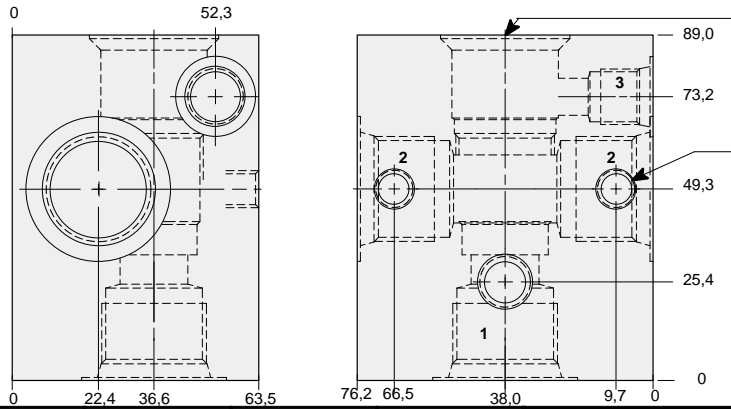

T-2A Cavity
Locating Shoulder
Depth 21,3 mm.

Mounting Holes:
(opposite side)
Inch: .375-16 UNC-2B
x 15,7 mm. deep.
Metric: M10 x 1.50-6H
x 15,7 mm. deep.
2 places.

Mounting Hole Dimensions	Ports 1 & 2	Port 3	Gauge Port	ALUMINIUM		SG IRON	
				Model Code	List Price	Model Code	List Price
Inch	.375 NPTF	.25 NPTF	.25 NPTF	WSE		WSE/S	
Inch	.50 NPTF	.25 NPTF	.25 NPTF	WSF		WSF/S	
Inch	.75 NPTF	.25 NPTF	.25 NPTF	WSG		WSG/S	
Inch	SAE-8	SAE-6	.25 NPTF	WSH		WSH/S	
Inch	SAE-10	SAE-6	.25 NPTF	WSI		WSI/S	
Inch	SAE-12	SAE-6	.25 NPTF	WSJ		WSJ/S	
Metric	.375 BSPP	.25 BSPP	.25 BSPP	WSK		WSK/S	
Metric	.50 BSPP	.25 BSPP	.25 BSPP	WSL		WSL/S	
Metric	.75 BSPP	.25 BSPP	.25 BSPP	WSM		WSM/S	

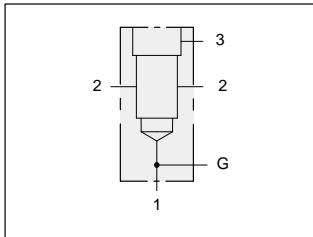

TYPICAL CARTRIDGES USED WITH THIS BODY

- PBFB - *** Page 3.06
- PBFC - *** Page 3.08
- DPCA - *** Page 8.06
- DPCB - *** Page 8.07
- DPPC - *** Page 8.08
- DPCD - *** Page 8.09

Instructions for ordering complete cartridge and body assemblies. Page viii

Pressure ratings, material specifications. Page 11.02

Through port body with high capacity port 3 and gauge port.

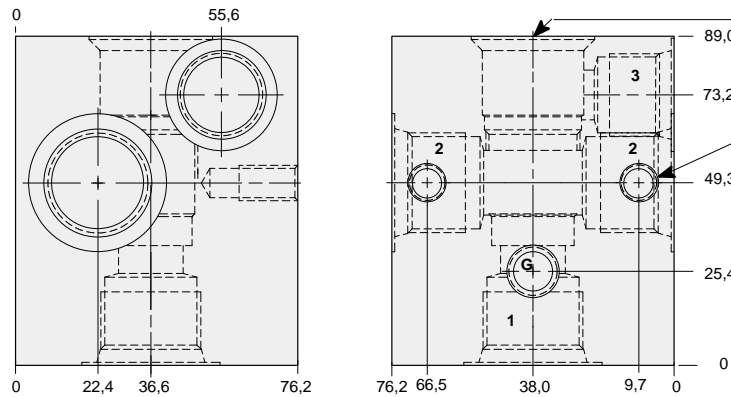

T-2A Cavity
Locating Shoulder
Depth 21,3 mm.

Mounting Holes:
(opposite side)
Inch: .375-16 UNC-2B
x 15,7 mm. deep.
Metric: M10 x 1.50-6H
x 15,7 mm. deep.
2 places.

Mounting Hole Dimensions	Ports 1 & 2	Port 3	Gauge Port	ALUMINIUM		SG IRON	
				Model Code	List Price	Model Code	List Price
Inch	.375 NPTF	.375 NPTF	.25 NPTF	WSN		WSN/S	
Inch	.50 NPTF	.50 NPTF	.25 NPTF	WSO		WSO/S	
Inch	.75 NPTF	.50 NPTF	.25 NPTF	WSP		WSP/S	
Inch	SAE-8	SAE-8	.25 NPTF	WSQ		WSQ/S	
Inch	SAE-10	SAE-10	.25 NPTF	WSR		WSR/S	
Inch	SAE-12	SAE-10	.25 NPTF	WSS		WSS/S	
Metric	.375 BSPP	.375 BSPP	.25 BSPP	WST		WST/S	
Metric	.50 BSPP	.50 BSPP	.25 BSPP	WSU		WSU/S	
Metric	.75 BSPP	.50 BSPP	.25 BSPP	WSV		WSV/S	



LINE MOUNT BODIES



- Aluminium rated to 210 bar and SG Iron rated to 350 bar.

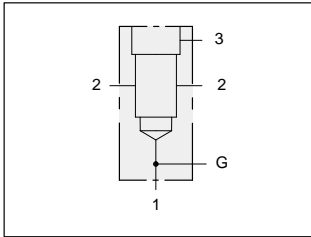

Sandwich mount through port 1.00" SAE Code 61 body with gauge port.

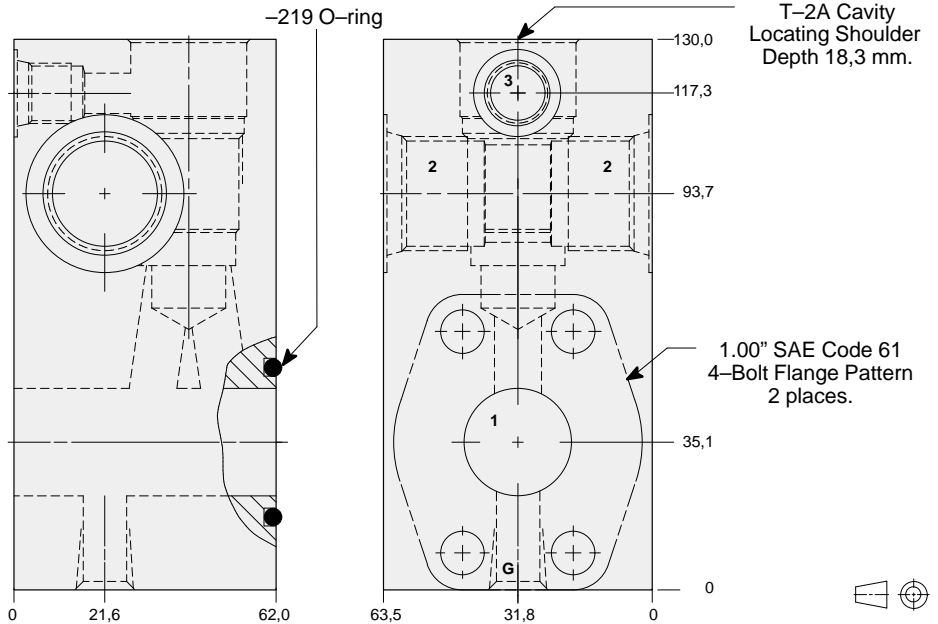

TYPICAL CARTRIDGES USED WITH THIS BODY

- RVEA - *** Page 1.18
- RSFC - *** Page 2.06
- SQFB - *** Page 2.08
- RSFE - *** Page 2.10
- SCEA - *** Page 2.12

Cartridge seal type determines O-ring type.

Instructions for ordering complete cartridge and body assemblies. Page viii

Pressure ratings, material specifications. Page 11.02

SAE Specifications. Page 11.03

Mounting Hole Dimensions	Port 2	Port 3	Gauge Port	ALUMINIUM		SG IRON	
				Model Code	List Price	Model Code	List Price
Inch	.75 NPTF	.25 NPTF	.25 NPTF	ZMN		ZMN/S	
Inch	SAE-12	SAE-6	.25 NPTF	ZMP		ZMP/S	
Metric	.75 BSPP	.25 BSPP	.25 BSPP	ZMR/M		ZMR/T	

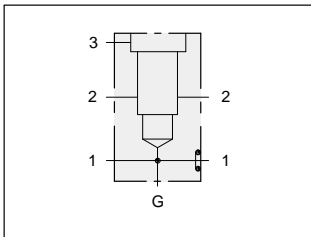

Sandwich mount through port 1.00" SAE Code 62 body with gauge port.

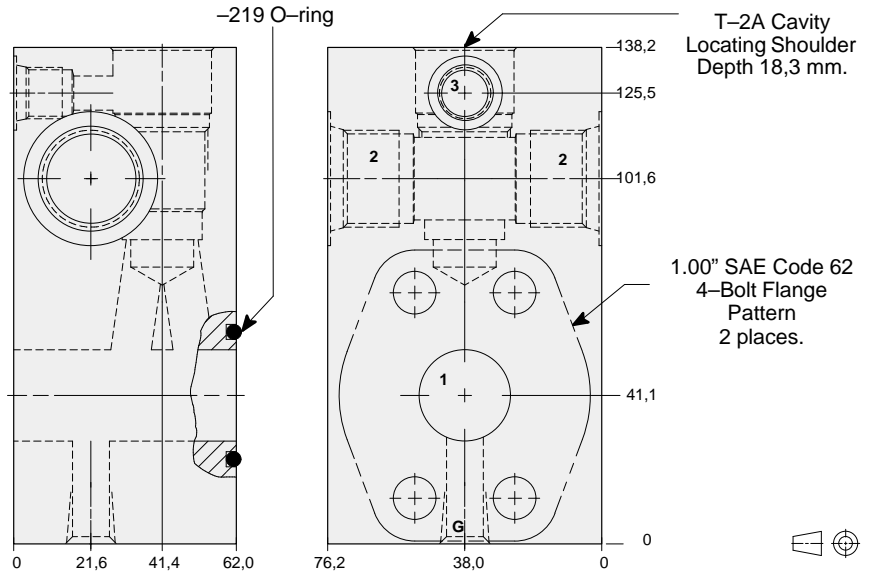

TYPICAL CARTRIDGES USED WITH THIS BODY

- RVEA - *** Page 1.18
- RSFC - *** Page 2.06
- SQFB - *** Page 2.08
- RSFE - *** Page 2.10
- SCEA - *** Page 2.12

Cartridge seal type determines O-ring type.

Instructions for ordering complete cartridge and body assemblies. Page viii

Pressure ratings, material specifications. Page 11.02

SAE Specifications. Page 11.03

Mounting Hole Dimensions	Port 2	Port 3	Gauge Port	ALUMINIUM		SG IRON	
				Model Code	List Price	Model Code	List Price
Inch	SAE-12	SAE-6	.25 NPTF	WYG		WYG/S	
Inch	.75 NPTF	.25 NPTF	.25 NPTF	WYH		WYH/S	
Metric	.75 BSPP	.25 BSPP	.25 BSPP	WYF/M		WYF/T	



LINE MOUNT BODIES



- Aluminium rated to 210 bar and SG Iron rated to 350 bar.

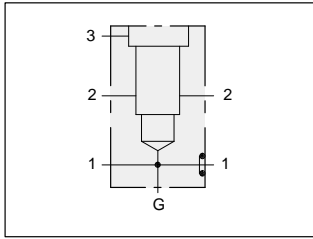

Flange mount through port 1.00" SAE Code 61 body with threaded outlet and gauge port.

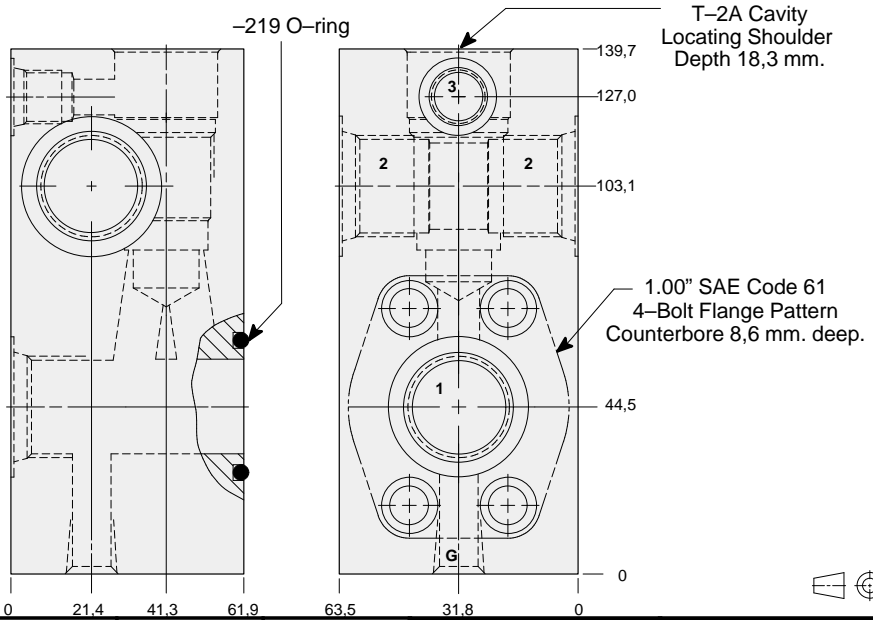

- TYPICAL CARTRIDGES USED WITH THIS BODY**
- RVEA - *** Page 1.18
 - RSFC - *** Page 2.06
 - SQFB - *** Page 2.08
 - RSFE - *** Page 2.10
 - SCEA - *** Page 2.12
- Cartridge seal type determines O-ring type.
- Instructions for ordering complete cartridge and body assemblies. Page viii
- Pressure ratings, material specifications. Page 11.02
- SAE Specifications. Page 11.03

Mounting Hole Dimensions	Ports 1 & 2	Port 3	Gauge Port	ALUMINIUM		SG IRON	
				Model Code	List Price	Model Code	List Price
Inch	.75 NPTF	.25 NPTF	.25 NPTF	WYW		WYW/S	
Inch	SAE-12	SAE-6	.25 NPTF	WYV		WYV/S	
Metric	.75 BSPP	.25 BSPP	.25 BSPP	WYU/M		WYU/T	

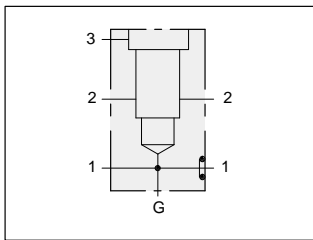

Flange mount through port 1.00" SAE Code 62 body with threaded outlet and gauge port.

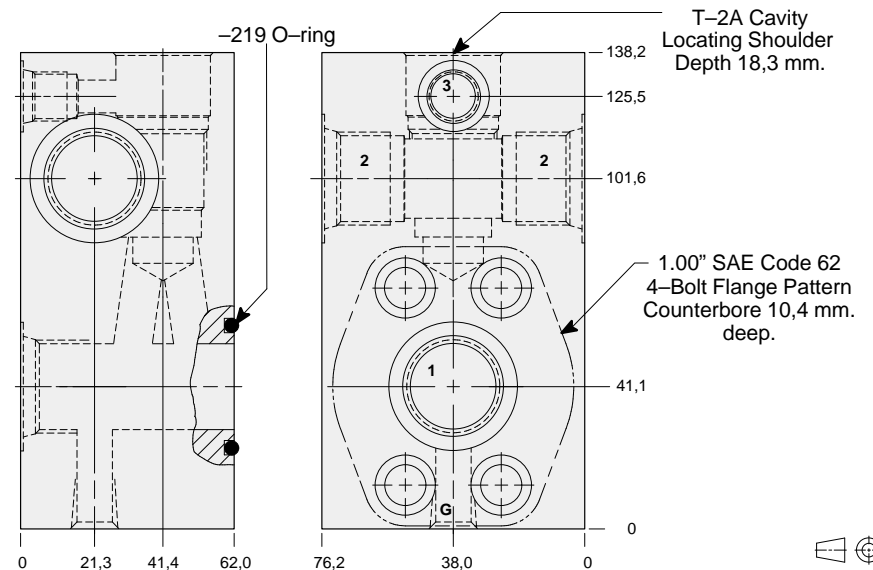

- TYPICAL CARTRIDGES USED WITH THIS BODY**
- RVEA - *** Page 1.18
 - RSFC - *** Page 2.06
 - SQFB - *** Page 2.08
- Cartridge seal type determines O-ring type.
- Instructions for ordering complete cartridge and body assemblies. Page viii
- Pressure ratings, material specifications. Page 11.02
- SAE Specifications. Page 11.03

Mounting Hole Dimensions	Ports 1 & 2	Port 3	Gauge Port	ALUMINIUM		SG IRON	
				Model Code	List Price	Model Code	List Price
Inch	.75 NPTF	.25 NPTF	.25 NPTF	WYE		WYE/S	
Inch	SAE-12	SAE-6	.25 NPTF	WYD		WYD/S	
Metric	.75 BSPP	.25 BSPP	.25 BSPP	WYC/M		WYC/T	



LINE MOUNT BODIES



- Aluminium rated to 210 bar and SG Iron rated to 350 bar.

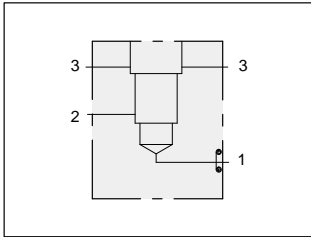

Direct mount .75" SAE Code 61 body with through pilot/drain port.

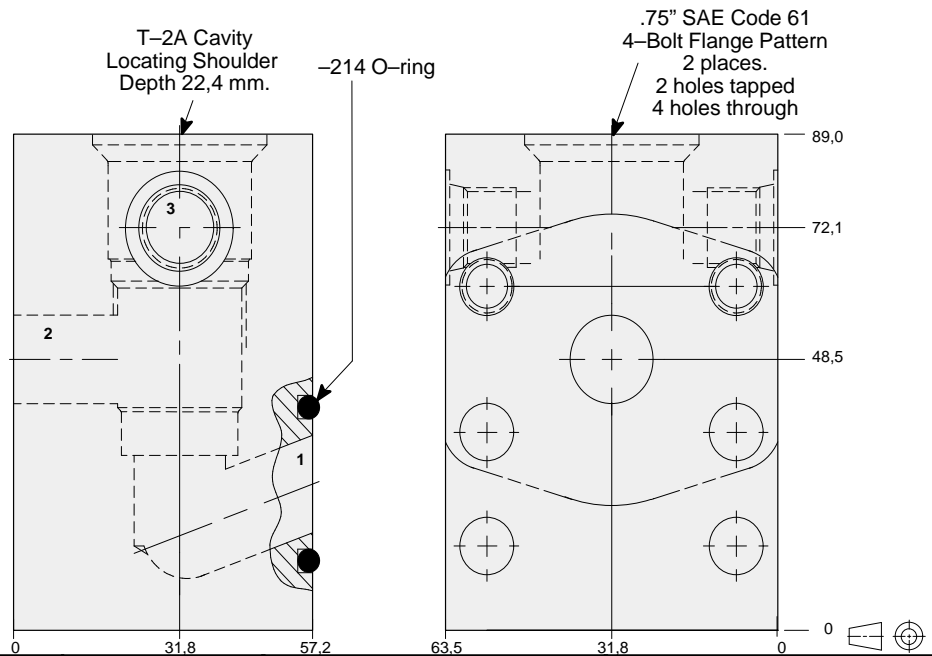

TYPICAL CARTRIDGES USED WITH THIS BODY

RVEA - ***	Page	1.18
RSFC - ***	Page	2.06
SQFB - ***	Page	2.08
RSFE - ***	Page	2.10
SCEA - ***	Page	2.12
CBEA - ***	Page	4.10
CBEG - ***	Page	4.12
CBEH - ***	Page	4.14
CKEB - ***	Page	4.14
LOFC - ***	Page	9.08
LKFC - ***	Page	9.10
LPFC - ***	Page	9.12
LRFC - ***	Page	9.14
COFA - ***	Page	10.12

Cartridge seal type determines O-ring type.

Instructions for ordering complete cartridge and body assemblies. Page viii

Pressure ratings, material specifications. Page 11.02

SAE Specifications. Page 11.03

Mounting Hole Dimensions	Port 3	ALUMINIUM		SG IRON	
		Model Code	List Price	Model Code	List Price
Inch	SAE-6	ZNV		ZNV/S	
Metric	.25 BSPP	ZNV/M		ZNV/T	

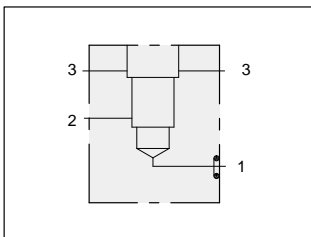

Direct mount .75" SAE Code 62 body with through pilot/drain port.

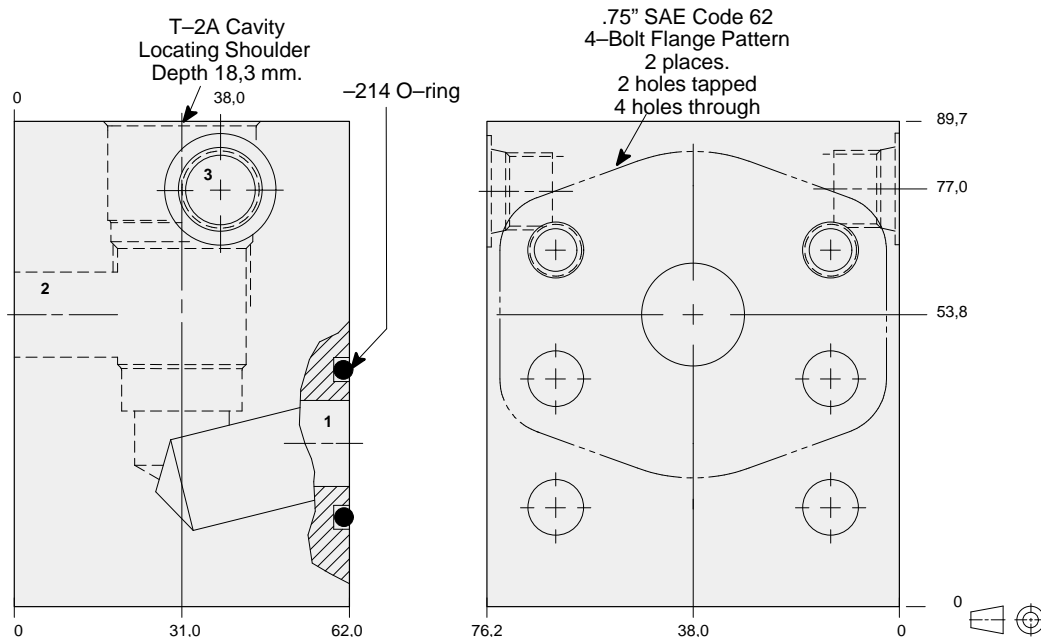

TYPICAL CARTRIDGES USED WITH THIS BODY

RVEA - ***	Page	1.18
RSFC - ***	Page	2.06
SQFB - ***	Page	2.08
RSFE - ***	Page	2.10
SCEA - ***	Page	2.12
CBEA - ***	Page	4.10
CBEG - ***	Page	4.12
CBEH - ***	Page	4.14
CKEB - ***	Page	4.14
LOFC - ***	Page	9.08
LKFC - ***	Page	9.10
LPFC - ***	Page	9.12
LRFC - ***	Page	9.14
COFA - ***	Page	10.12

Cartridge seal type determines O-ring type.

Instructions for ordering complete cartridge and body assemblies. Page viii

Pressure ratings, material specifications. Page 11.02

SAE Specifications. Page 11.03

Mounting Hole Dimensions	Port 3	ALUMINIUM		SG IRON	
		Model Code	List Price	Model Code	List Price
Inch	SAE-6	ZDS		ZDS/S	
Metric	.25 BSPP	ZDS/M		ZDS/T	



LINE MOUNT BODIES



- Aluminium rated to 210 bar and SG Iron rated to 350 bar.

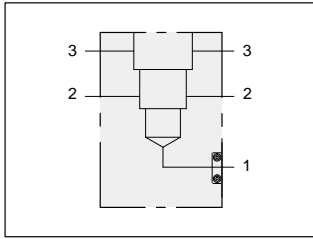

Flange mount through port .75" SAE Code 62 body with through pilot/drain port.

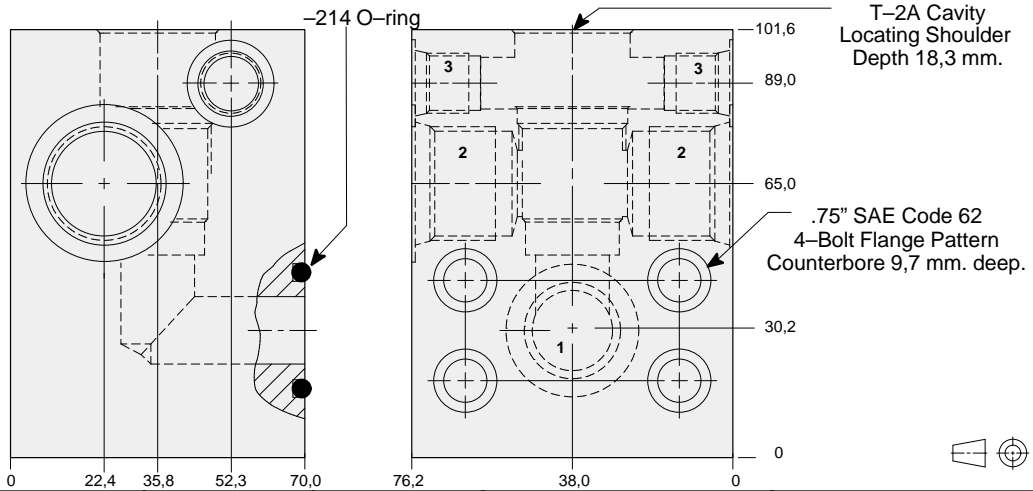

TYPICAL CARTRIDGES USED WITH THIS BODY

RVEA - ***	Page	1.18
RSFC - ***	Page	2.06
SQFB - ***	Page	2.08
RSFE - ***	Page	2.10
SCEA - ***	Page	2.12

Cartridge seal type determines O-ring type.

Instructions for ordering complete cartridge and body assemblies. Page iii

Pressure ratings, material specifications. Page 11.02

SAE Specifications. Page NO TAG

Mounting Hole Dimensions	Port 2	Port 3	ALUMINIUM		SG IRON	
			Model Code	List Price	Model Code	List Price
Inch	.50 NPTF	.25 NPTF	WRA		WRA/S	
Inch	.75 NPTF	.25 NPTF	WRB		WRB/S	
Inch	SAE-10	SAE-6	WRC		WRC/S	
Inch	SAE-12	SAE-6	WRD		WRD/S	
Metric	.50 BSPP	.25 BSPP	WRE/M		WRE/T	
Metric	.75 BSPP	.25 BSPP	WRF/M		WRF/T	

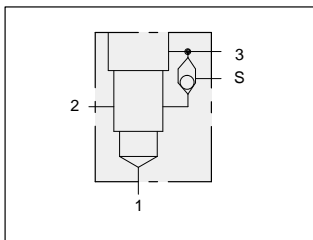

90 degree body with shuttle.

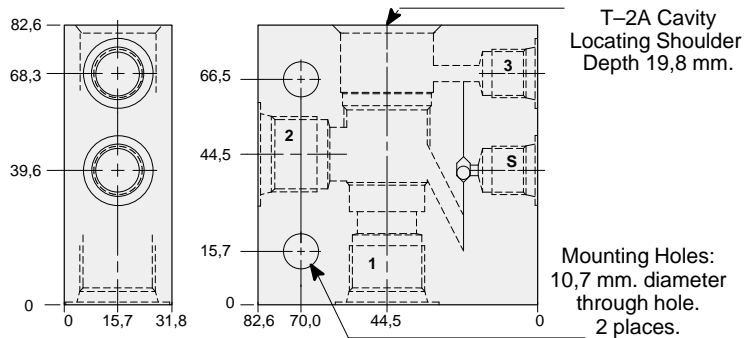

TYPICAL CARTRIDGES USED WITH THIS BODY

CBEA - ***	Page	4.10
CBEG - ***	Page	4.12
CBEH - ***	Page	4.14
CKEB - ***	Page	4.14

Instructions for ordering complete cartridge and body assemblies. Page iii

Pressure ratings, material specifications. Page 11.02

Ports 1 & 2	Ports 3 & S	ALUMINIUM		SG IRON	
		Model Code	List Price	Model Code	List Price
.25 NPTF	.25 NPTF	BGA		BGA/S	
.375 NPTF	.25 NPTF	BGB		BGB/S	
.50 NPTF	.25 NPTF	BGC		BGC/S	
.75 NPTF	.25 NPTF	BGD		BGB/S	
SAE-6	SAE-6	BGI		BGI/S	
SAE-8	SAE-6	BGJ		BGJ/S	
SAE-10	SAE-6	BGK		BGK/S	
.25 BSPP	.25 BSPP	BGT		BGT/S	
.375 BSPP	.25 BSPP	BGU		BGU/S	
.50 BSPP	.25 BSPP	BGV		BGV/S	
.75 BSPP	.25 BSPP	BGW		BGW/S	



LINE MOUNT BODIES



- Aluminium rated to 210 bar and SG Iron rated to 350 bar.

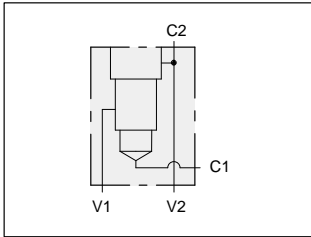

Nipple mount body for load control applications.

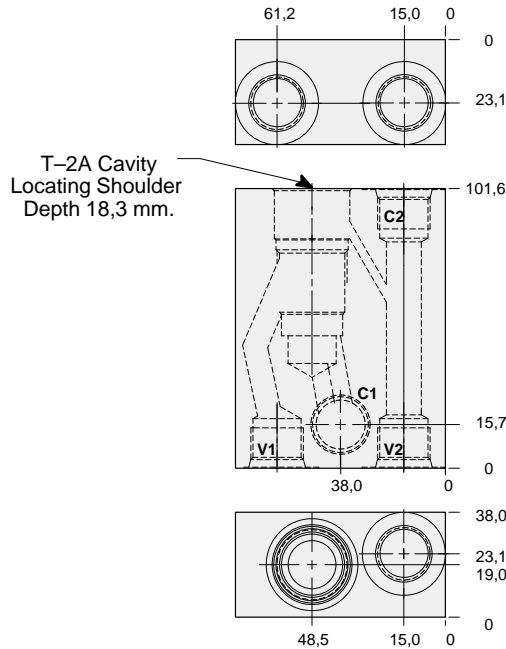

TYPICAL CARTRIDGES USED WITH THIS BODY

- CBEA - *** Page 4.10
- CBEG - *** Page 4.12
- CBEH - *** Page 4.14
- CKEB - *** Page 4.14

Instructions for ordering complete cartridge and body assemblies. Page viii

Pressure ratings, material specifications. Page 11.02

All Ports	ALUMINIUM		SG IRON	
	Model Code	List Price	Model Code	List Price
.50 NPTF	ZTX		ZTX/S	
SAE-8	ZRM		ZRM/S	

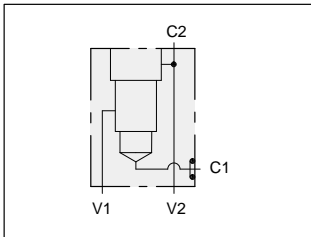

Gasket mount body for load control applications.

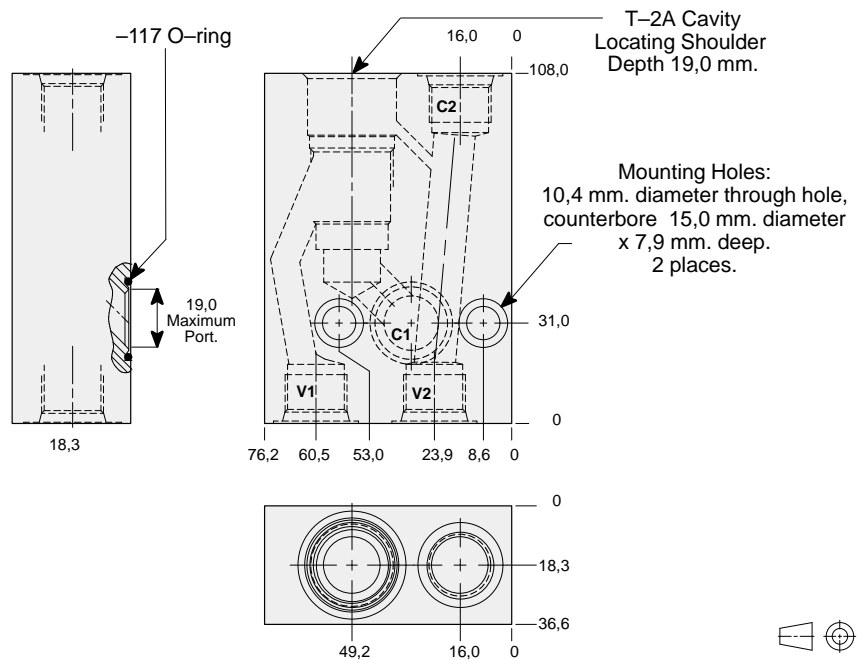

TYPICAL CARTRIDGES USED WITH THIS BODY

- CBEA - *** Page 4.10
- CBEG - *** Page 4.12
- CBEH - *** Page 4.14
- CKEB - *** Page 4.14

Cartridge seal type determines O-ring type.

Instructions for ordering complete cartridge and body assemblies. Page viii

Pressure ratings, material specifications. Page 11.02

Ports C2, V1, & V2	ALUMINIUM		SG IRON	
	Model Code	List Price	Model Code	List Price
.50 NPTF	ZTF		ZTF/S	
SAE-8	ZTG		ZTG/S	
.50 BSPP	ZTH		ZTH/S	



LINE MOUNT BODIES



- Aluminium rated to 210 bar and SG Iron rated to 350 bar.

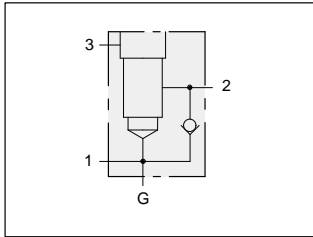

Body with reverse free flow check and gauge port for reducing and reducing/relieving applications.

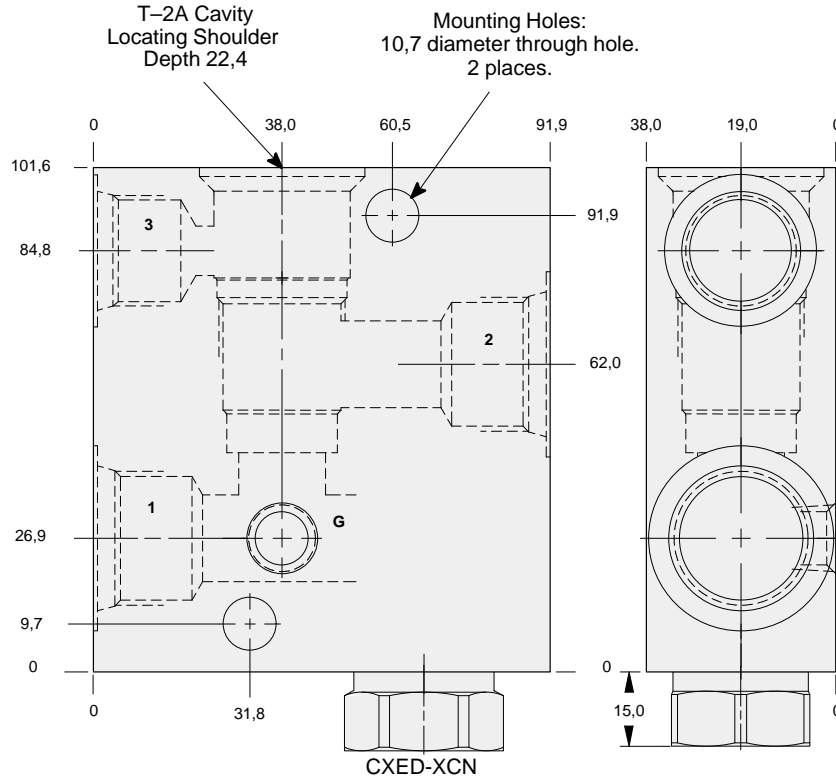

TYPICAL CARTRIDGES USED WITH THIS BODY

- PBFB - *** Page 3.06
- PBFC - *** Page 3.08
- PPFB - *** Page 3.10
- PPFC - *** Page 3.12

Cartridge seal type determines check valve seal type.

Instructions for ordering complete cartridge and body assemblies. Page viii

Pressure ratings, material specifications. Page 11.02

Ports 1 & 2	Port 3	Gauge Port	ALUMINIUM		SG IRON	
			Model Code	List Price	Model Code	List Price
.25 NPTF	.25 NPTF	.25 NPTF	B2A		B2A/S	
.375 NPTF	.25 NPTF	.25 NPTF	B2B		B2B/S	
.50 NPTF	.25 NPTF	.25 NPTF	B2C		B2C/S	
.75 NPTF	.25 NPTF	.25 NPTF	B2D		B2D/S	
SAE-6	SAE-6	.25 NPTF	B2I		B2I/S	
SAE-8	SAE-6	.25 NPTF	B2J		B2J/S	
SAE-10	SAE-6	.25 NPTF	B2K		B2K/S	
.375 BSPP	.25 BSPP	.25 BSPP	B2U		B2U/S	
.50 BSPP	.25 BSPP	.25 BSPP	B2V		B2V/S	
.75 BSPP	.25 BSPP	.25 BSPP	B2W		B2W/S	
.375 NPTF	.375 NPTF	.25 NPTF	B4B		B4B/S	
.50 NPTF	.50 NPTF	.25 NPTF	B4C		B4C/S	
.75 NPTF	.50 NPTF	.25 NPTF	B4D		B4D/S	
SAE-8	SAE-8	.25 NPTF	B4J		B4J/S	
SAE-10	SAE-10	.25 NPTF	B4K		B4K/S	
SAE-12	SAE-10	.25 NPTF	B4L		B4L/S	
.375 BSPP	.375 BSPP	.25 BSPP	B4U		B4U/S	
.50 BSPP	.50 BSPP	.25 BSPP	B4V		B4V/S	
.75 BSPP	.50 BSPP	.25 BSPP	B4W		B4W/S	

Series 2 T-2A



LINE MOUNT BODIES



- Aluminium rated to 210 bar and SG Iron rated to 350 bar.

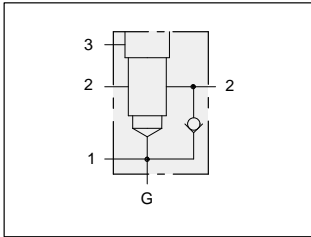

Through port body with reverse free flow check and gauge port for reducing applications.

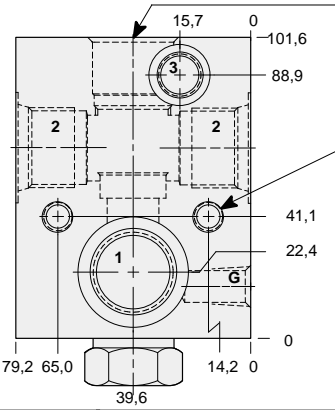
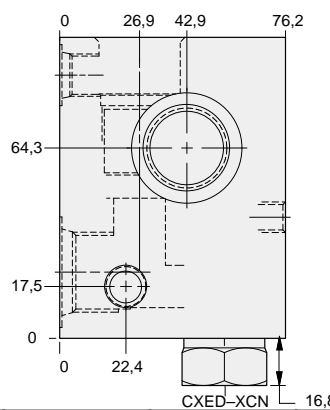

T-2A Cavity
Locating Shoulder
Depth 19,0 mm.

Mounting Holes:
(opposite side)
Inch: .375-16 UNC-2B
x 15,7 mm. deep.
Metric: M10 x 1.50-6H
x 15,7 mm. deep.
2 places.

**TYPICAL CARTRIDGES
USED WITH THIS BODY**

- PBFB - *** Page 3.06
- PBFC - *** Page 3.08

Cartridge seal type determines
check valve seal type.

Instructions for ordering
complete cartridge and body
assemblies. Page viii

Pressure ratings, material
specifications. Page 11.02

Mounting Hole Dimensions	Ports 1 & 2	Port 3	Gauge Port	ALUMINIUM		SG IRON	
				Model Code	List Price	Model Code	List Price
Inch	.375 NPTF	.25 NPTF	.25 NPTF	B3B		B3B/S	
Inch	.50 NPTF	.25 NPTF	.25 NPTF	B3C		B3C/S	
Inch	.75 NPTF	.25 NPTF	.25 NPTF	B3D		B3D/S	
Inch	SAE-8	SAE-6	.25 NPTF	B3J		B3J/S	
Inch	SAE-10	SAE-6	.25 NPTF	B3K		B3K/S	
Inch	SAE-12	SAE-6	.25 NPTF	B3L		B3L/S	
Metric	.375 BSPP	.25 BSPP	.25 BSPP	B3U		B3U/S	
Metric	.50 BSPP	.25 BSPP	.25 BSPP	B3V		B3V/S	
Metric	.75 BSPP	.25 BSPP	.25 BSPP	B3W		B3W/S	

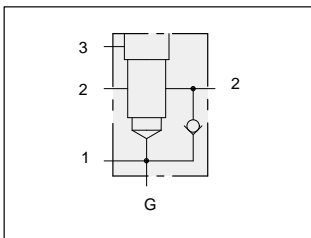

Through port body with high capacity port 3.

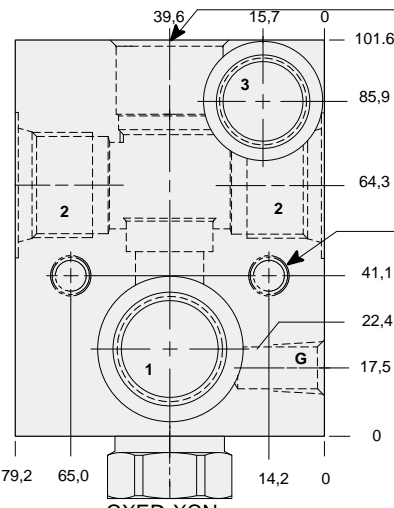
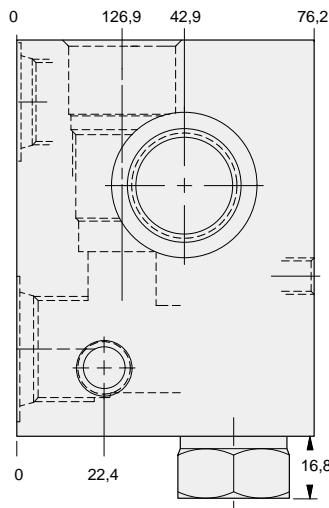

T-2A Cavity
Locating Shoulder
Depth 19,0

Mounting Holes:
(opposite side)
Inch: .375-16 UNC-2B
X 15,7 deep.
Metric: M10 x 1.50-6H
x 15,7 deep.
2 places.

**TYPICAL CARTRIDGES
USED WITH THIS BODY**

- PBFB - *** Page 3.06
- PBFC - *** Page 3.08

Cartridge seal type determines
check valve seal type.

Instructions for ordering
complete cartridge and body
assemblies. Page viii

Pressure ratings, material
specifications. Page 11.02

Mounting Hole Dimensions	Ports 1 & 2	Port 3	Gauge Port	ALUMINIUM		SG IRON	
				Model Code	List Price	Model Code	List Price
Inch	.50 NPTF	.50 NPTF	.25 NPTF	B5C		B5C/S	
Inch	.75 NPTF	.50 NPTF	.25 NPTF	B5D		B5D/S	
Inch	SAE-10	SAE-10	.25 NPTF	B5K		B5K/S	
Inch	SAE-12	SAE-10	.25 NPTF	B5L		B5L/S	
Metric	.50 BSPP	.50 BSPP	.25 BSPP	B5V		B5V/S	
Metric	.75 BSPP	.50 BSPP	.25 BSPP	B5W		B5W/S	

Series 2 T-2A



LINE MOUNT BODIES



- Aluminium rated to 210 bar and SG Iron rated to 350 bar.

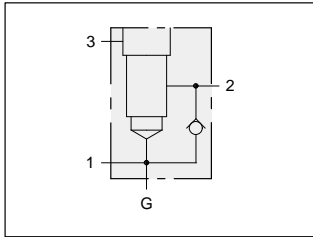

Body with reverse free flow check and gauge port.

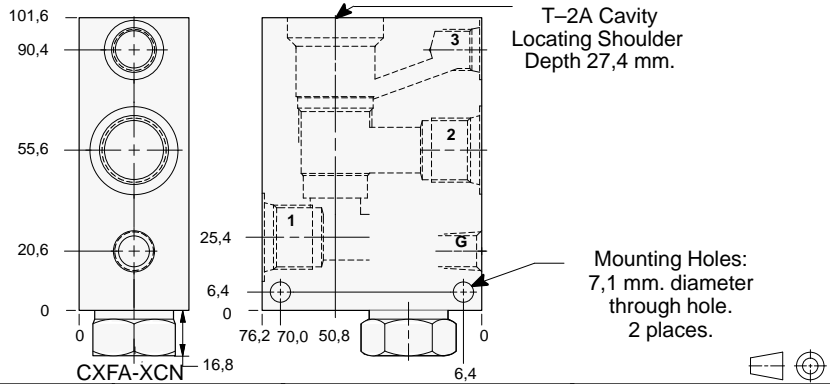

TYPICAL CARTRIDGES USED WITH THIS BODY

- RVEA - *** Page 1.18
- RSFC - *** Page 2.06
- SQFB - *** Page 2.08
- RSFE - *** Page 2.10

Cartridge seal type determines check valve seal type.

Instructions for ordering complete cartridge and body assemblies. Page viii

Pressure ratings, material specifications. Page 11.02

Ports 1 & 2	Port 3	Gauge Port	ALUMINIUM		SG IRON	
			Model Code	List Price	Model Code	List Price
.25 NPTF	.25 NPTF	.25 NPTF	B6A		B6A/S	
.375 NPTF	.25 NPTF	.25 NPTF	B6B		B6B/S	
.50 NPTF	.25 NPTF	.25 NPTF	B6C		B6C/S	
.75 NPTF	.25 NPTF	.25 NPTF	B6D		B6D/S	
SAE-6	SAE-6	.25 NPTF	B6I		B6I/S	
SAE-8	SAE-6	.25 NPTF	B6J		B6J/S	
SAE-10	SAE-6	.25 NPTF	B6K		B6K/S	
.375 BSPP	.25 BSPP	.25 BSPP	B6U		B6U/S	
.50 BSPP	.25 BSPP	.25 BSPP	B6V		B6V/S	
.75 BSPP	.25 BSPP	.25 BSPP	B6W		B6W/S	

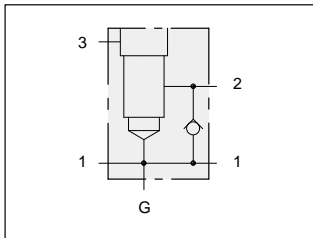

Through port body with reverse free flow check and gauge port.

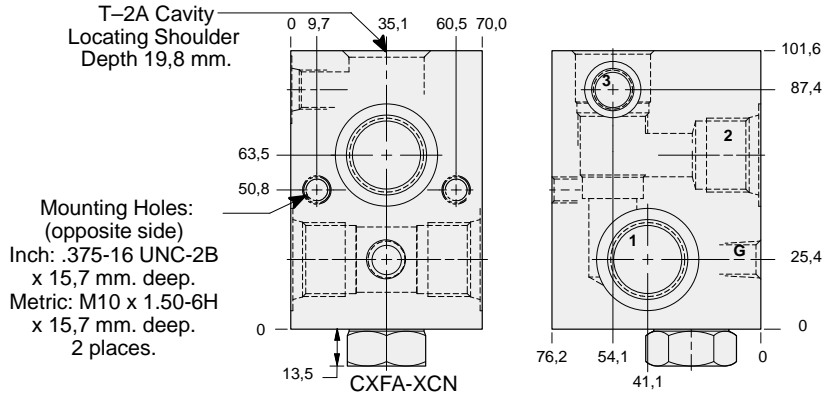

TYPICAL CARTRIDGES USED WITH THIS BODY

- RVEA - *** Page 1.18
- RSFC - *** Page 2.06
- SQFB - *** Page 2.08
- RSFE - *** Page 2.10

Cartridge seal type determines check valve seal type.

Instructions for ordering complete cartridge and body assemblies. Page viii

Pressure ratings, material specifications. Page 11.02

Mounting Hole Dimensions	Ports 1 & 2	Port 3	Gauge Port	ALUMINIUM		SG IRON	
				Model Code	List Price	Model Code	List Price
Inch	.375 NPTF	.25 NPTF	.25 NPTF	B7B		B7B/S	
Inch	.50 NPTF	.25 NPTF	.25 NPTF	B7C		B7C/S	
Inch	.75 NPTF	.25 NPTF	.25 NPTF	B7D		B7D/S	
Inch	SAE-8	SAE-6	.25 NPTF	B7J		B7J/S	
Inch	SAE-10	SAE-6	.25 NPTF	B7K		B7K/S	
Inch	SAE-12	SAE-6	.25 NPTF	B7L		B7L/S	
Metric	.375 BSPP	.25 BSPP	.25 BSPP	B7U		B7U/S	
Metric	.50 BSPP	.25 BSPP	.25 BSPP	B7V		B7V/S	
Metric	.75 BSPP	.25 BSPP	.25 BSPP	B7W		B7W/S	



LINE MOUNT BODIES



- Aluminium rated to 210 bar and SG Iron rated to 350 bar.

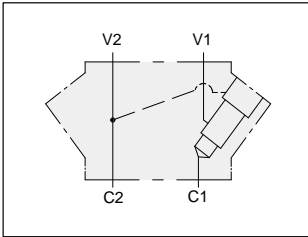

Inline body for load control applications.

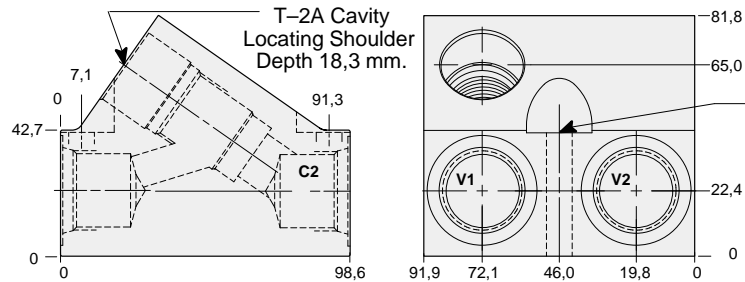

Mounting Holes:
8,6 mm. diameter through hole
22,4 mm. diameter socket clearance
2 places.

TYPICAL CARTRIDGES USED WITH THIS BODY

CBEA - ***	Page	4.10
CBEG - ***	Page	4.12
CBEH - ***	Page	4.14
CKEB - ***	Page	4.14

Instructions for ordering complete cartridge and body assemblies. Page iii

Pressure ratings, material specifications. Page 11.02

Ports C1, C2 & V1, V2	ALUMINIUM		SG IRON	
	Model Code	List Price	Model Code	List Price
.25 NPTF	WPO		WPO/S	
.375 NPTF	WPP		WPP/S	
.50 NPTF	WPQ		WPQ/S	
.75 NPTF	WPR		WPR/S	
SAE-6	WPS		WPS/S	
SAE-8	WPT		WPT/S	
SAE-10	WPU		WPU/S	
SAE-12	WPV		WPV/S	
.25 BSPP	WPW		WPW/S	
.375 BSPP	WPX		WPX/S	
.50 BSPP	WPY		WPY/S	
.75 BSPP	WPZ		WPZ/S	

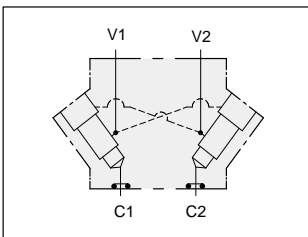

Two cavity inline gasket mount cross-piloted body for load control applications.

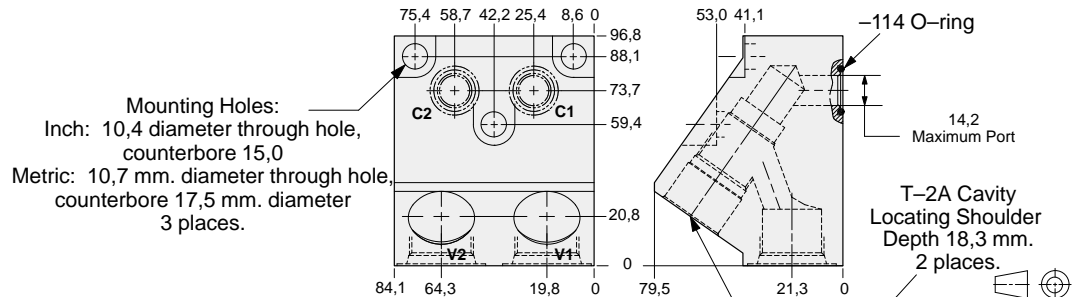

TYPICAL CARTRIDGES USED WITH THIS BODY

CBEA - ***	Page	4.10
CBEG - ***	Page	4.12
CBEH - ***	Page	4.14
CKEB - ***	Page	4.14

Cartridge seal type determines O-ring type.

Instructions for ordering complete cartridge and body assemblies. Page iii

Pressure ratings, material specifications. Page 11.02

Ports V1, & V2	ALUMINIUM		SG IRON	
	Model Code	List Price	Model Code	List Price
.25 NPTF	VYA		VYA/S	
.375 NPTF	VYB		VYB/S	
.50 NPTF	VYC		VYC/S	
.75 NPTF	VYD		VYD/S	
SAE-6	VYI		VYI/S	
SAE-8	VYJ		VYJ/S	
SAE-10	VYK		VYK/S	
SAE-12	VYL		VYL/S	
.25 BSPP	VYT		VYT/S	
.375 BSPP	VYU		VYU/S	
.50 BSPP	VYV		VYV/S	
.75 BSPP	VYW		VYW/S	



LINE MOUNT BODIES



- Aluminium rated to 210 bar and SG Iron rated to 350 bar.

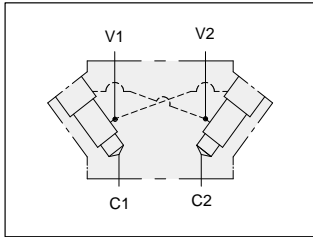

Two cavity inline cross-piloted body for load control applications.

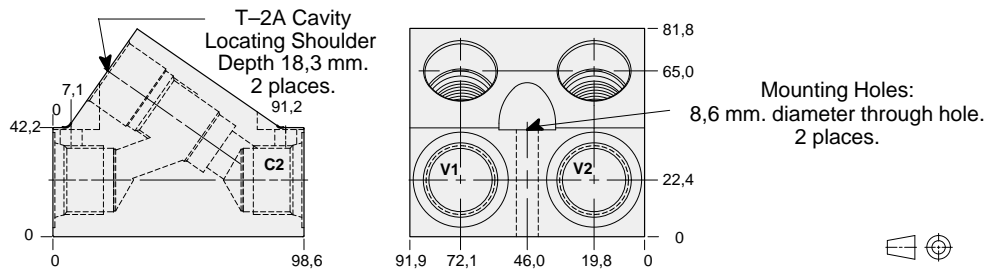

TYPICAL CARTRIDGES USED WITH THIS BODY

CBEA - ***	Page	4.10
CBEG - ***	Page	4.12
CBEH - ***	Page	4.14
CKEB - ***	Page	4.14

Instructions for ordering complete cartridge and body assemblies. Page viii

Pressure ratings, material specifications. Page 11.02

Ports C1, C2, & V1, V2	ALUMINIUM		SG IRON	
	Model Code	List Price	Model Code	List Price
.25 NPTF	XAA		XAA/S	
.375 NPTF	XAB		XAB/S	
.50 NPTF	XAC		XAC/S	
.75 NPTF	XAD		XAD/S	
SAE-6	XAI		XAI/S	
SAE-8	XAJ		XAJ/S	
SAE-10	XAK		XAK/S	
SAE-12	XAL		XAL/S	
.25 BSPP	XAT		XAT/S	
.375 BSPP	XAU		XAU/S	
.50 BSPP	XAV		XAV/S	
.75 BSPP	XAW		XAW/S	

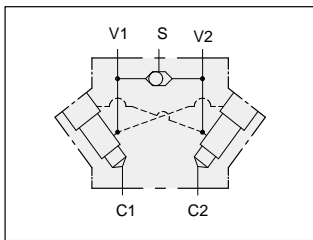

Two cavity inline cross-piloted body with shuttle for load control applications.

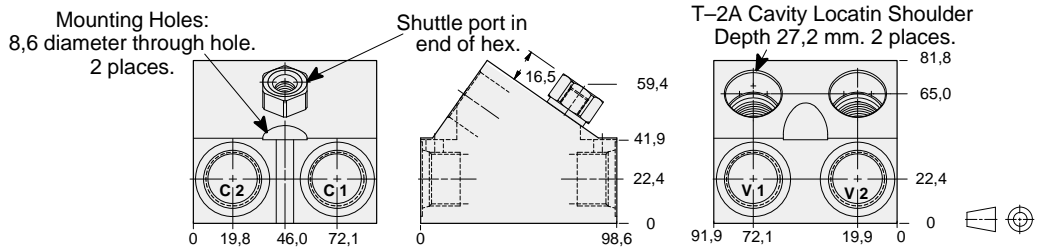

TYPICAL CARTRIDGES USED WITH THIS BODY

CBEA - ***	Page	4.10
CBEG - ***	Page	4.12
CBEH - ***	Page	4.14
CKEB - ***	Page	4.14

Cartridge seal type determines check valve seal type.

Instructions for ordering complete cartridge and body assemblies. Page viii

Pressure ratings, material specifications. Page 11.02

Ports C1, C2, & V1, V2	Shuttle Cartridge	Shuttle Port	ALUMINIUM		SG IRON	
			Model Code	List Price	Model Code	List Price
.25 NPTF	CSAA - EXN	SAE-4	XHA		XHA/S	
.375 NPTF	CSAA - EXN	SAE-4	XHB		XHB/S	
.50 NPTF	CSAA - EXN	SAE-4	XHC		XHC/S	
.75 NPTF	CSAA - EXN	SAE-4	XHD		XHD/S	
SAE-6	CSAA - EXN	SAE-4	XHI		XHI/S	
SAE-8	CSAA - EXN	SAE-4	XHJ		XHJ/S	
SAE-10	CSAA - EXN	SAE-4	XHK		XHK/S	
SAE-12	CSAA - EXN	SAE-4	XHL		XHL/S	
.25 BSPP	CSAA - BXN	.25 BSPP	XHT		XHT/S	
.375 BSPP	CSAA - BXN	.25 BSPP	XHU		XHU/S	
.50 BSPP	CSAA - BXN	.25 BSPP	XHV		XHV/S	
.75 BSPP	CSAA - BXN	.25 BSPP	XHW		XHW/S	



LINE MOUNT BODIES



- Aluminium rated to 210 bar and SG Iron rated to 350 bar.

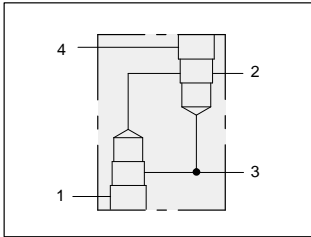

Two cavity body for flow control applications.

T-2A Cavity
Locating Shoulder
Depth 21,3
2 places.

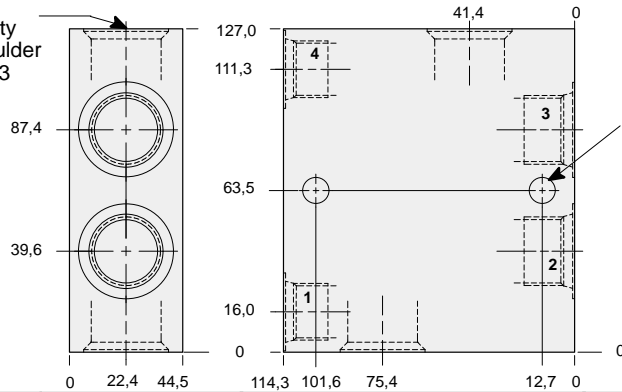

Mounting Holes:
10,7 diameter through hole.
2 places.

TYPICAL CARTRIDGES USED WITH THIS BODY

FRDA - *** Page 6.02

Instructions for ordering complete cartridge and body assemblies. Page viii

Pressure ratings, material specifications. Page 11.02

Port 2 & 3	Port 1 & 4	ALUMINIUM		SG IRON	
		Model Code	List Price	Model Code	List Price
.375 NPTF	.375 NPTF	VXN		VXN/S	
.50 NPTF	.50 NPTF	VXP		VXP/S	
.75 NPTF	.50 NPTF	VXQ		VXQ/S	
SAE-8	SAE-8	VXR		VXR/S	
SAE-10	SAE-10	VXS		VXS/S	
SAE-12	SAE-10	VXT		VXT/S	
.375 BSPP	.375 BSPP	VXU		VXU/S	
.50 BSPP	.50 BSPP	VXV		VXV/S	
.75 BSPP	.50 BSPP	VXW		VXW/S	

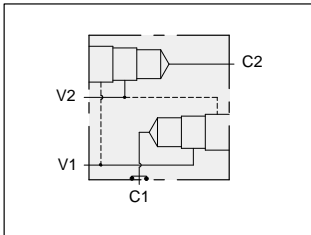

Two cavity gasket mount body for load control applications.

T-2A Cavity
Locating Shoulder
Depth 19,0

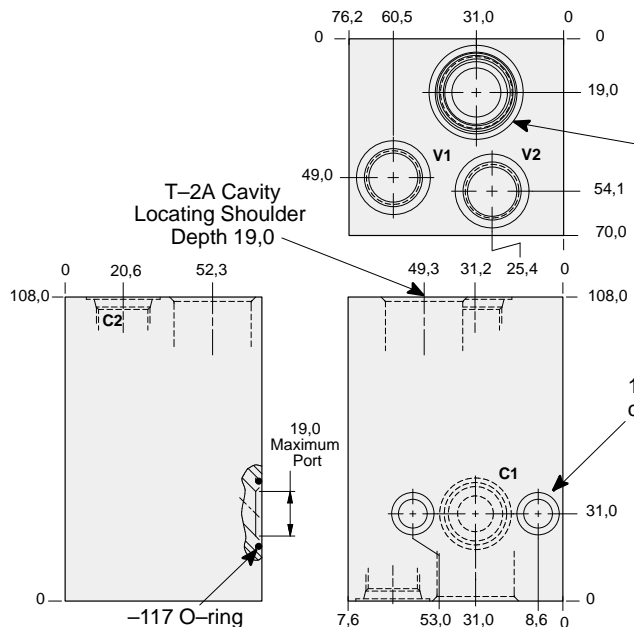

T-2A Cavity
Locating Shoulder
Depth 26,9 mm.

Mounting Holes:
10,4 diameter through hole,
counterbore 15,0 diameter
2 places.

TYPICAL CARTRIDGES USED WITH THIS BODY

CBEA - *** Page 4.10

CBEH - *** Page 4.12

CKEB - *** Page 4.14

Cartridge seal type determines O-ring type.

Instructions for ordering complete cartridge and body assemblies. Page viii

Pressure ratings, material specifications. Page 11.02

Ports C2, V1, & V2	ALUMINIUM		SG IRON	
	Model Code	List Price	Model Code	List Price
.50 NPTF	YVW		YVW/S	
SAE-8	YVV		YVV/S	
.50 BSPP	YVU		YVU/S	



LINE MOUNT BODIES



- Aluminium rated to 210 bar and SG Iron rated to 350 bar.

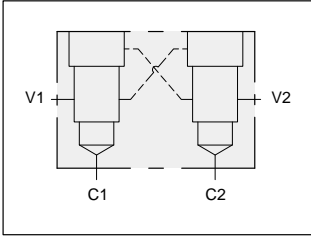

Two cavity 90 degree cross-piloted body for load control applications.

T-2A Cavity Locating Shoulder
Depth 19,8 mm.
2 places.

Mounting Holes:
10,7 mm. diameter
through hole.
2 places.

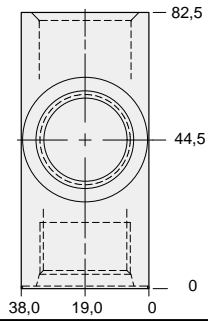
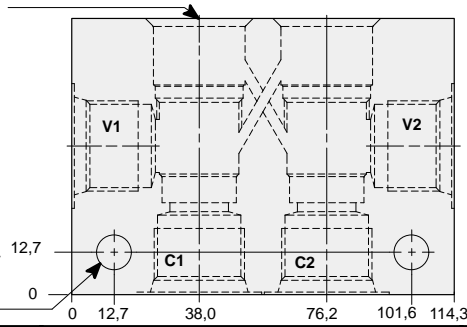

TYPICAL CARTRIDGES USED WITH THIS BODY

CBEA - ***	Page	4.10
CBEG - ***	Page	4.12
CBEH - ***	Page	4.14
CKEB - ***	Page	4.14

Instructions for ordering complete cartridge and body assemblies. Page viii

Pressure ratings, material specifications. Page 11.02

Ports C1, C2, & V1, V2	ALUMINIUM		SG IRON	
	Model Code	List Price	Model Code	List Price
.25 NPTF	YAA		YAA/S	
.375 NPTF	YAB		YAB/S	
.50 NPTF	YAC		YAC/S	
.75 NPTF	YAD		YAD/S	
SAE-6	YAI		YAI/S	
SAE-8	YAJ		YAJ/S	
SAE-10	YAK		YAK/S	
SAE-12	YAL		YAL/S	
.25 BSPP	YAT		YAT/S	
.375 BSPP	YAU		YAU/S	
.50 BSPP	YAV		YAV/S	

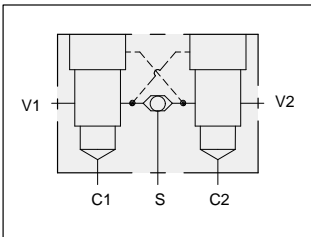

Two cavity 90 degree cross-piloted body with shuttle for load control applications.

T-2A Cavity Locating Shoulder
Depth 19,8 mm.
2 places.

Mounting Holes:
10,7 mm. diameter
through hole.
2 places.

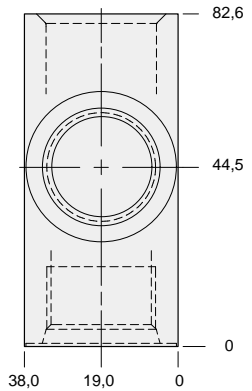
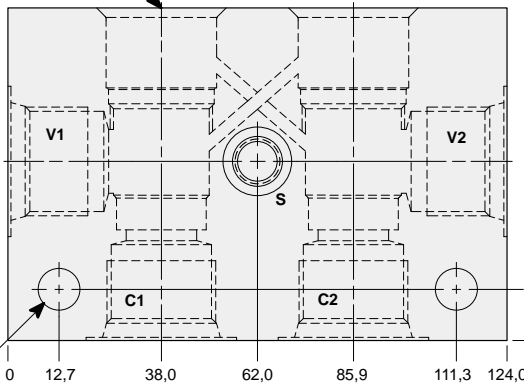

TYPICAL CARTRIDGES USED WITH THIS BODY

CBEA - ***	Page	4.10
CBEG - ***	Page	4.12
CBEH - ***	Page	4.14
CKEB - ***	Page	4.14

Instructions for ordering complete cartridge and body assemblies. Page viii

Pressure ratings, material specifications. Page 11.02

Ports C1, C2, & V1, V2	Port S	ALUMINIUM		SG IRON	
		Model Code	List Price	Model Code	List Price
.50 NPTF	.25 NPTF	YHC		YHC/S	
.75 NPTF	.25 NPTF	YHD		YHD/S	
SAE-10	SAE-4	YHK		YHK/S	
SAE-12	SAE-4	YHL		YHL/S	
.50 BSPP	.25 BSPP	YHV		YHV/S	
.75 BSPP	.25 BSPP	YHW		YHW/S	

Series 2 T-2A



LINE MOUNT BODIES



- Aluminium rated to 210 bar and SG Iron rated to 350 bar.

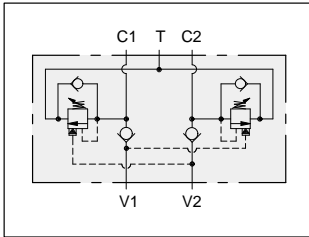
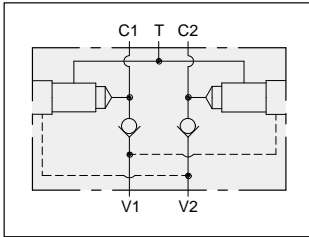

TYPICAL CARTRIDGES USED WITH THIS BODY

- CBEA - *** Page 4.10
- CBEG - *** Page 4.12
- CBEH - *** Page 4.14

Cartridge seal type determines check valve seal type.

Instructions for ordering complete cartridge and body assemblies. Page viii

Pressure ratings, material specifications. Page 11.02

Two cavity dual load control body with checks.

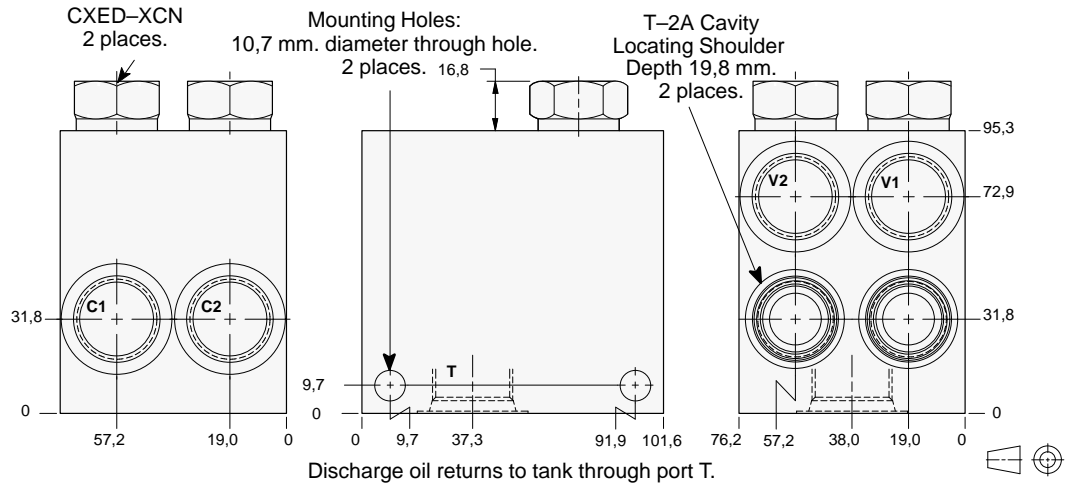

Ports C1, C2, & V1, V2	Port T	ALUMINIUM		SG IRON	
		Model Code	List Price	Model Code	List Price
.50 NPTF	.75 NPTF	BMC		BMC/S	
.75 NPTF	.75 NPTF	BMD		BMD/S	
SAE-10	SAE-12	BMK		BMK/S	
SAE-12	SAE-12	BML		BML/S	
.50 BSPP	.75 BSPP	BMV		BMV/S	
.75 BSPP	.75 BSPP	BMW		BMW/S	

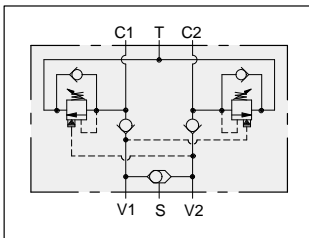
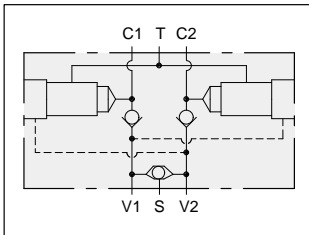

TYPICAL CARTRIDGES USED WITH THIS BODY

- CBEA - *** Page 4.10
- CBEG - *** Page 4.12
- CBEH - *** Page 4.14

Cartridge seal type determines check valve seal type.

Instructions for ordering complete cartridge and body assemblies. Page viii

Pressure ratings, material specifications. Page 11.02

Two cavity dual load control body with checks and shuttle.

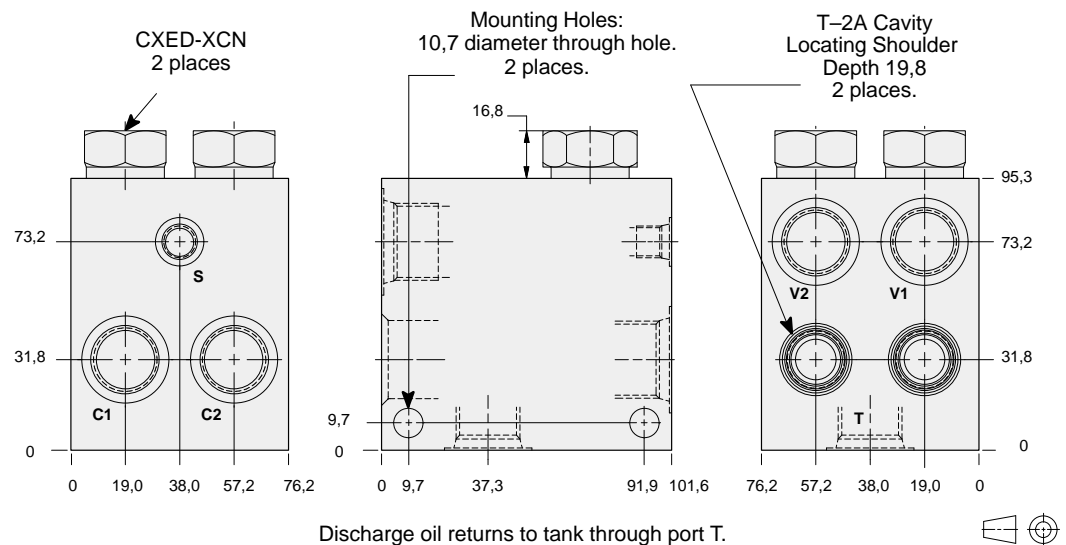

Ports C1, C2, & V1, V2	Port T	Port S	ALUMINIUM		SG IRON	
			Model Code	List Price	Model Code	List Price
.50 NPTF	.75 NPTF	.25 NPTF	BNC		BNC/S	
.75 NPTF	.75 NPTF	.25 NPTF	BND		BND/S	
SAE-10	SAE-12	SAE-4	BNK		BNK/S	
SAE-12	SAE-12	SAE-4	BNL		BNL/S	
.50 BSPP	.75 BSPP	.25 BSPP	BNV		BNV/S	
.75 BSPP	.75 BSPP	.25 BSPP	BNW		BNW/S	



LINE MOUNT BODIES



- Aluminium rated to 210 bar and SG Iron rated to 350 bar.

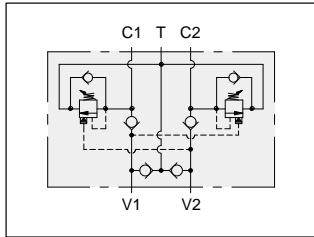
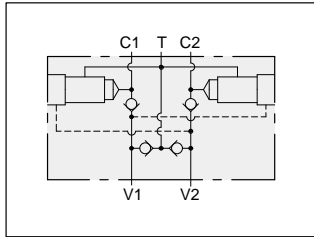

Two cavity dual load control body with make-up checks.

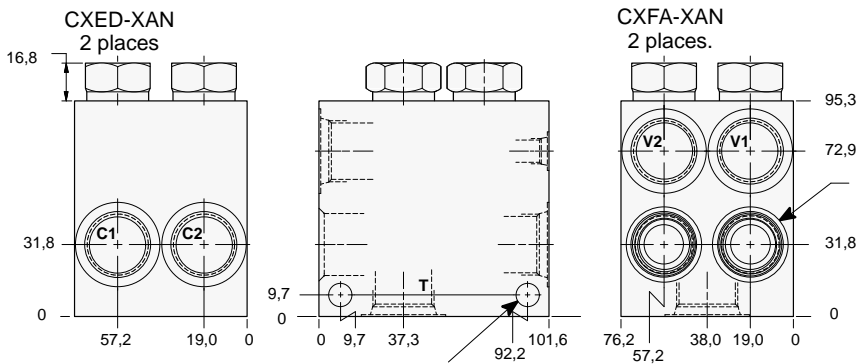

T-2A Cavity Locating Shoulder Depth 19,8 mm. 2 places.

Mounting Holes:
10,7 mm. diameter through hole.
2 places.

Discharge oil returns to tank through directional valve or port T.



TYPICAL CARTRIDGES USED WITH THIS BODY

- CBEA - *** Page 4.10
- CBEG - *** Page 4.12
- CBEH - *** Page 4.14

Cartridge seal type determines check valve seal type.

Instructions for ordering complete cartridge and body assemblies. Page viii

Pressure ratings, material specifications. Page 11.02

Ports C1, C2, & V1, V2	Port T	ALUMINIUM		SG IRON	
		Model Code	List Price	Model Code	List Price
.50 NPTF	.75 NPTF	BPC		BPC/S	
.75 NPTF	.75 NPTF	BPD		BPD/S	
SAE-10	SAE-12	BPK		BPK/S	
SAE-12	SAE-12	BPL		BPL/S	
.50 BSPP	.75 BSPP	BPV		BPV/S	
.75 BSPP	.75 BSPP	BPW		BPW/S	

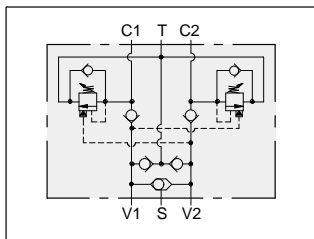
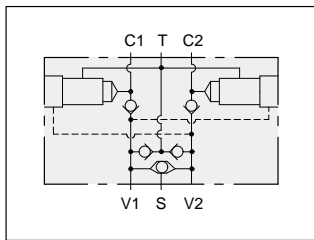

Two cavity dual load control body with make-up checks and shuttle.

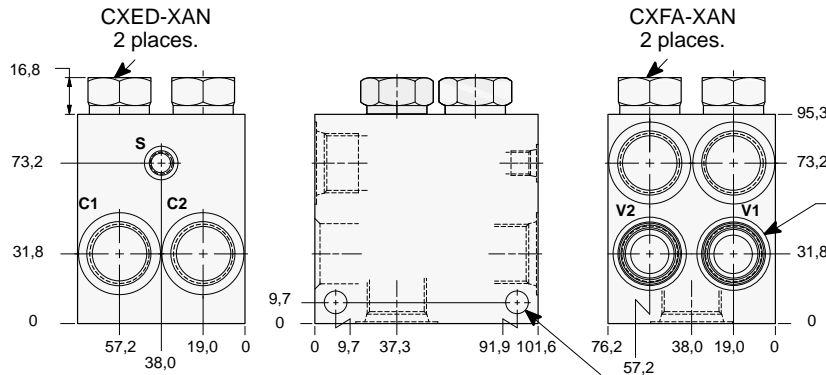

T-2A Cavity Locating Shoulder Depth 19,8 mm. 2 places.

Mounting Holes:
10,7 mm. diameter through hole.
2 places.

Discharge oil returns to tank through directional valve or port T.



TYPICAL CARTRIDGES USED WITH THIS BODY

- CBEA - *** Page 4.10
- CBEG - *** Page 4.12
- CBEH - *** Page 4.14

Cartridge seal type determines check valve seal type.

Instructions for ordering complete cartridge and body assemblies. Page viii

Pressure ratings, material specifications. Page 11.02

Ports C1, C2, & V1, V2	Port T	Port S	ALUMINIUM		SG IRON	
			Model Code	List Price	Model Code	List Price
.50 NPTF	.75 NPTF	.25 NPTF	BQC		BQC/S	
.75 NPTF	.75 NPTF	.25 NPTF	BQD		BQD/S	
SAE-10	SAE-12	SAE-4	BQK		BQK/S	
SAE-12	SAE-12	SAE-4	BQL		BQL/S	
.50 BSPP	.75 BSPP	.25 BSPP	BQV		BQV/S	
.75 BSPP	.75 BSPP	.25 BSPP	BQW		BQW/S	



LINE MOUNT BODIES



- Aluminium rated to 210 bar and SG Iron rated to 350 bar.

Two cavity dual sequence body with reverse free flow checks.

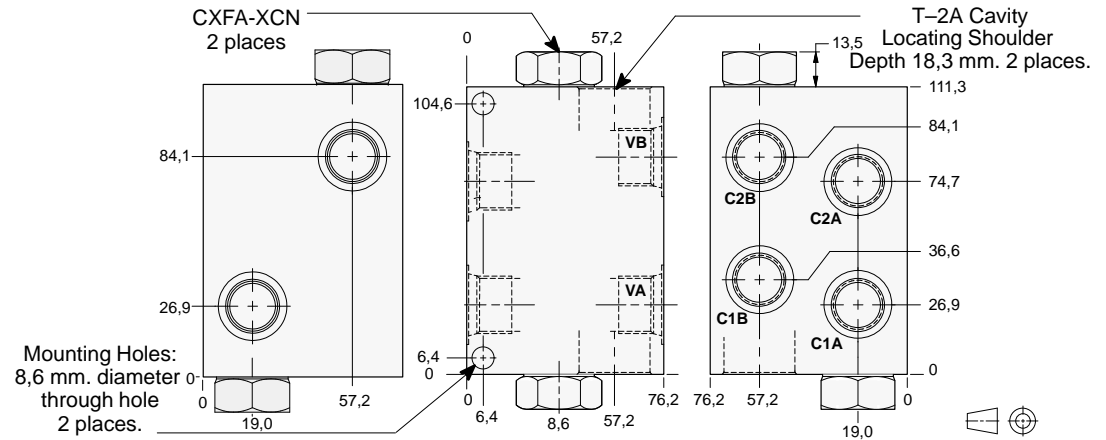
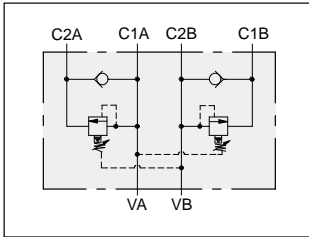
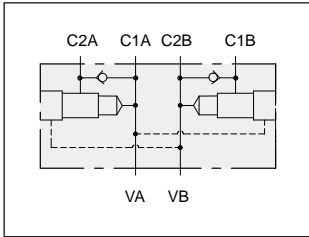

TYPICAL CARTRIDGES USED WITH THIS BODY

RSFC - *** Page 2.06
SQFB - *** Page 2.08

Cartridge seal type determines check valve seal type.

Instructions for ordering complete cartridge and body assemblies. Page viii

Pressure ratings, material specifications. Page 11.02

All Ports	ALUMINIUM		SG IRON	
	Model Code	List Price	Model Code	List Price
.375 NPTF	B8B		B8B/S	
.50 NPTF	B8C		B8C/S	
.75 NPTF	B8D		B8D/S	
SAE-8	B8J		B8J/S	
SAE-10	B8K		B8K/S	
.375 BSPP	B8U		B8U/S	
.50 BSPP	B8V		B8V/S	
.75 BSPP	B8W		B8W/S	

Two cavity through port body with shuttle and gauge ports.

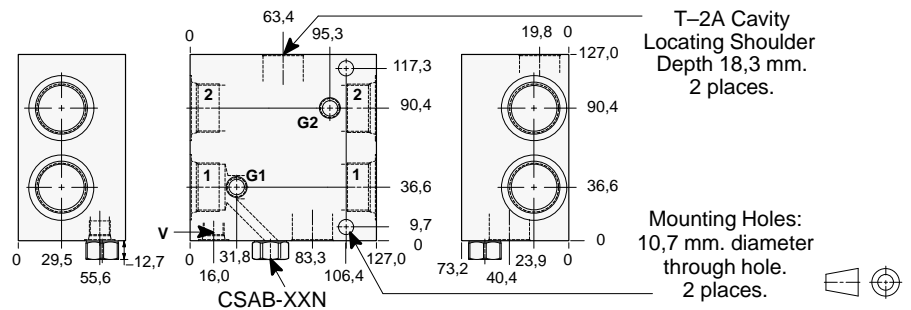
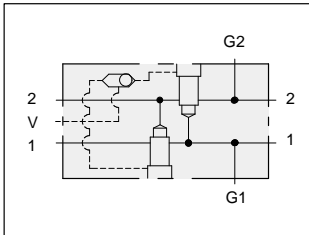

TYPICAL CARTRIDGES USED WITH THIS BODY

RVEA - *** Page 1.18

Cartridge seal type determines check valve seal type.

Instructions for ordering complete cartridge and body assemblies. Page viii

Pressure ratings, material specifications. Page 11.02

Ports 1 & 2	Ports G1 & G2	Part V	ALUMINIUM		SG IRON	
			Model Code	List Price	Model Code	List Price
.375 NPTF	.25 NPTF	.25 NPTF	XBB		XBB/S	
.50 NPTF	.25 NPTF	.25 NPTF	XBC		XBC/S	
.75 NPTF	.25 NPTF	.25 NPTF	XBD		XBD/S	
1.00 NPTF	.25 NPTF	.25 NPTF	XBE		XBE/S	
SAE-6	.25 NPTF	SAE-6	XBI		XBI/S	
SAE-8	.25 NPTF	SAE-6	XBJ		XBJ/S	
SAE-10	.25 NPTF	SAE-6	XBK		XBK/S	
SAE-12	.25 NPTF	SAE-6	XBL		XBL/S	
SAE-16	.25 NPTF	SAE-6	XBM		XBM/S	
.375 BSPP	.25 BSPP	.25 BSPP	XBU		XBU/S	
.50 BSPP	.25 BSPP	.25 BSPP	XBV		XBV/S	
.75 BSPP	.25 BSPP	.25 BSPP	XBW		XBW/S	
1.00 BSPP	.25 BSPP	.25 BSPP	XBX		XBX/S	



LINE MOUNT BODIES



- Aluminium rated to 210 bar and SG Iron rated to 350 bar.

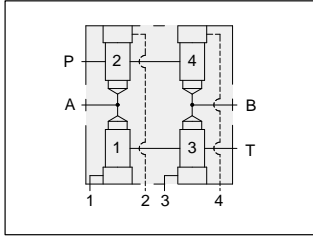

Four cavity four-way logic body for directional applications.

Mounting Holes:
 Inch: .375-16 UNC-2B
 x 15,7 mm. deep.
 Metric: M10 x 1.50-6H
 x 15,7 mm. deep.
 2 places.

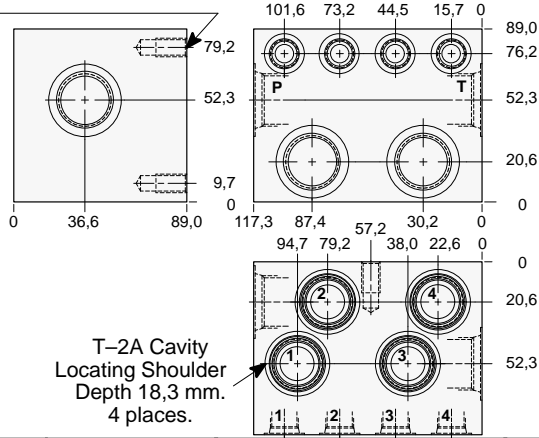

TYPICAL CARTRIDGES USED WITH THIS BODY

- LOFC - *** Page 9.08
- LKFC - *** Page 9.10
- LPFC - *** Page 9.12
- LRFC - *** Page 9.14

Instructions for ordering complete cartridge and body assemblies. Page viii

Pressure ratings, material specifications. Page 11.02

Mounting Hole Dimensions	Ports A & B P & T	Ports 1 & 2, 3 & 4	ALUMINIUM		SG IRON	
			Model Code	List Price	Model Code	List Price
Inch	.375 NPTF	.25 NPTF	YPZ		YPZ/S	
Inch	.50 NPTF	.25 NPTF	YPY		YPY/S	
Inch	.75 NPTF	.25 NPTF	YPX		YPX/S	
Inch	SAE-8	SAE-6	YPW		YPW/S	
Inch	SAE-10	SAE-6	YPV		YPV/S	
Inch	SAE-12	SAE-6	YPT		YPT/S	
Metric	.375 BSPP	.25 BSPP	YPP		YPP/S	
Metric	.50 BSPP	.25 BSPP	YPM		YPM/S	
Metric	.75 BSPP	.25 BSPP	YPQ		YPQ/S	

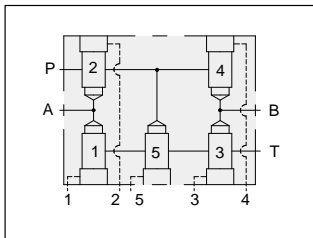

Five cavity four-way logic body for directional applications.

Mounting Holes:
 Inch: .375-16 UNC-2B
 x 15,7 mm. deep.
 Metric: M10 x 1.50-6H
 x 15,7 mm. deep.
 2 places.

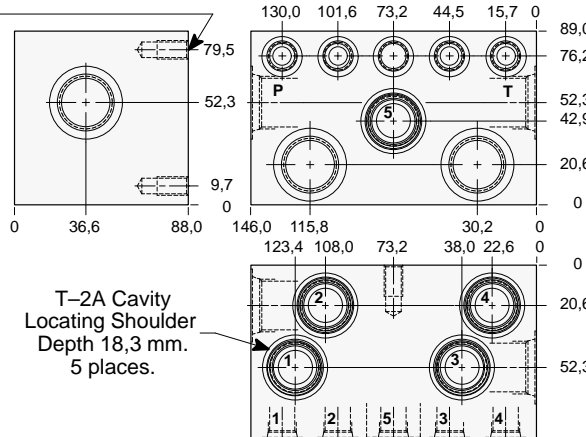

TYPICAL CARTRIDGES USED WITH THIS BODY

- LOFC - *** Page 9.08
- LKFC - *** Page 9.10
- LPFC - *** Page 9.12
- LRFC - *** Page 9.14

Instructions for ordering complete cartridge and body assemblies. Page viii

Pressure ratings, material specifications. Page 11.02

Mounting Hole Dimensions	Ports A & B P & T	Ports 1, 2, 3, 4 & 5	ALUMINIUM		SG IRON	
			Model Code	List Price	Model Code	List Price
Inch	.375 NPTF	.25 NPTF	YPO		YPO/S	
Inch	.50 NPTF	.25 NPTF	YPN		YPN/S	
Inch	.75 NPTF	.25 NPTF	YPS		YPS/S	
Inch	SAE-8	SAE-6	YPL		YPL/S	
Inch	SAE-10	SAE-6	YPK		YPK/S	
Inch	SAE-12	SAE-6	YPJ		YPJ/S	
Metric	.375 BSPP	.25 BSPP	YPH		YPH/S	
Metric	.50 BSPP	.25 BSPP	YPG		YPG/S	
Metric	.75 BSPP	.25 BSPP	YPF		YPF/S	



LINE MOUNT BODIES



- Aluminium rated to 210 bar and SG Iron rated to 350 bar.

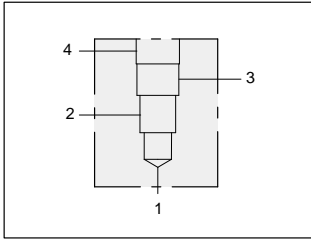

90 degree body.

T-22A Cavity
Locating Shoulder
Depth 33,3 mm.

Mounting Holes:
10,7 mm. diameter
through hole.
2 places.

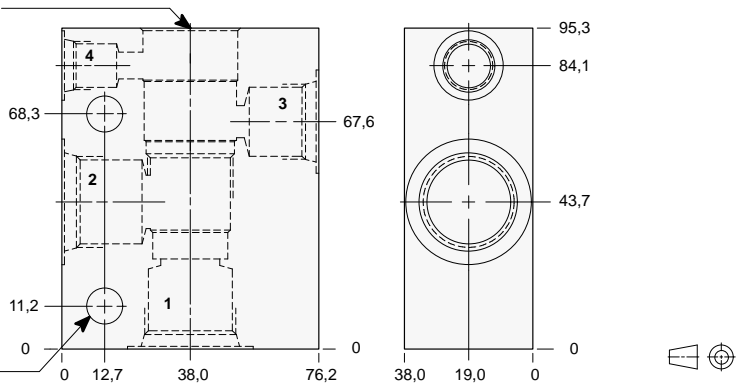

TYPICAL CARTRIDGES USED WITH THIS BODY

RVED - ***	Page	1.20
PVFA - ***	Page	3.14
PVFB - ***	Page	3.16
CWEA - ***	Page	4.18
CWEG - ***	Page	4.20
CVEV - ***	Page	4.22
FVDA - ***	Page	6.04
DPCM - ***	Page	8.10
DPCN - ***	Page	8.11
DPCO - ***	Page	8.12
DPCP - ***	Page	8.13

Instructions for ordering complete cartridge and body assemblies. Page iii

Pressure ratings, material specifications. Page 11.02

Ports 1 & 2	Port 3	Port 4	ALUMINIUM		SG IRON	
			Model Code	List Price	Model Code	List Price
.375 NPTF	.375 NPTF	.25 NPTF	NAB		NAB/S	
.50 NPTF	.50 NPTF	.25 NPTF	NAC		NAC/S	
.75 NPTF	.50 NPTF	.25 NPTF	NAD		NAD/S	
SAE-8	SAE-8	SAE-6	NAJ		NAJ/S	
SAE-10	SAE-10	SAE-6	NAK		NAK/S	
SAE-12	SAE-10	SAE-6	NAL		NAL/S	
.375 BSPP	.375 BSPP	.25 BSPP	NAU		NAU/S	
.50 BSPP	.50 BSPP	.25 BSPP	NAV		NAV/S	
.75 BSPP	.50 BSPP	.25 BSPP	NAW		NAW/S	

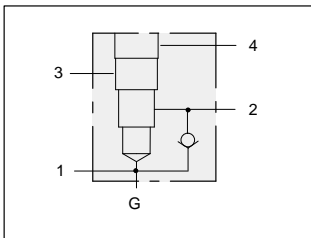

Body with reverse free flow check and gauge port.

T-22A Cavity
Locating Shoulder
Depth 35,1 mm.

Mounting Holes:
10,7 mm. diameter
through hole.
2 places.

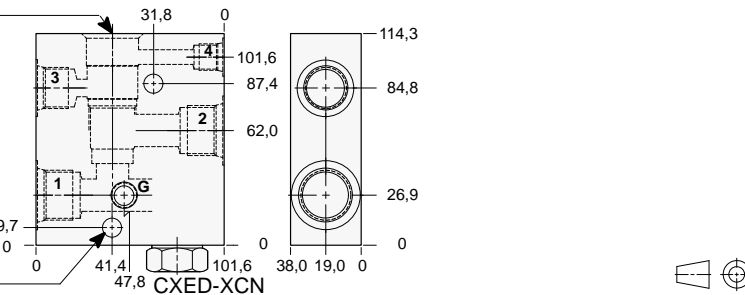

TYPICAL CARTRIDGES USED WITH THIS BODY

PVFA - ***	Page	3.14
PVFB - ***	Page	3.16

Cartridge seal type determines check valve seal type.

Instructions for ordering complete cartridge and body assemblies. Page iii

Pressure ratings, material specifications. Page 11.02

Ports 1 & 2	Port 3	Port 4	Gauge Port	ALUMINIUM		SG IRON	
				Model Code	List Price	Model Code	List Price
.25 NPTF	.25 NPTF	.25 NPTF	.25 NPTF	N4A		N4A/S	
.375 NPTF	.375 NPTF	.25 NPTF	.25 NPTF	N4B		N4B/S	
.50 NPTF	.50 NPTF	.25 NPTF	.25 NPTF	N4C		N4C/S	
.75 NPTF	.50 NPTF	.25 NPTF	.25 NPTF	N4D		N4D/S	
SAE-6	SAE-6	SAE-6	.25 NPTF	N4I		N4I/S	
SAE-8	SAE-8	SAE-6	.25 NPTF	N4J		N4J/S	
SAE-10	SAE-10	SAE-6	.25 NPTF	N4K		N4K/S	
SAE-12	SAE-10	SAE-6	.25 NPTF	N4L		N4L/S	
.25 BSPP	.25 BSPP	.25 BSPP	.25 BSPP	N4T		N4T/S	
.375 BSPP	.375 BSPP	.25 BSPP	.25 BSPP	N4U		N4U/S	
.50 BSPP	.50 BSPP	.25 BSPP	.25 BSPP	N4V		N4V/S	
.75 BSPP	.50 BSPP	.25 BSPP	.25 BSPP	N4W		N4W/S	