

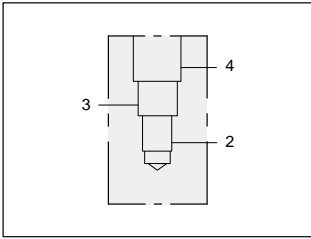

LINE MOUNT BODIES



- Aluminium rated to 210 bar and SG Iron rated to 350 bar.



Body for flow divider/combiner applications.

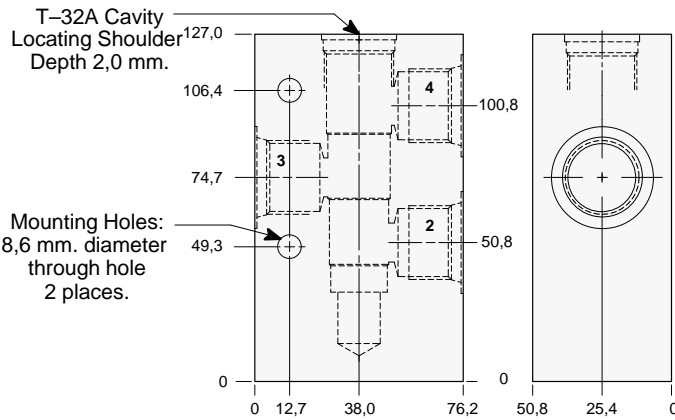

TYPICAL CARTRIDGES USED WITH THIS BODY

FSDD - ***	Page	7.08
FSDA - ***	Page	7.10
FSDS - ***	Page	7.12
FSDH - ***	Page	7.14

Instructions for ordering complete cartridge and body assemblies. Page viii

Pressure ratings, material specifications. Page 11.02

Ports 2, 3 & 4	ALUMINIUM		SG IRON	
	Model Code	List Price	Model Code	List Price
.375 NPTF	NMB		NMB/S	
.50 NPTF	NMC		NMC/S	
.75 NPTF	NMD		NMD/S	
SAE-6	NMJ		NMJ/S	
SAE-8	NMK		NMK/S	
SAE-10	NML		NML/S	
.375 BSPP	NMU		NMU/S	
.50 BSPP	NMV		NMV/S	
.75 BSPP	NMW		NMW/S	

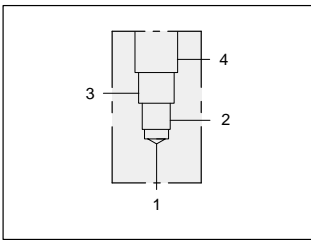

Four port body.

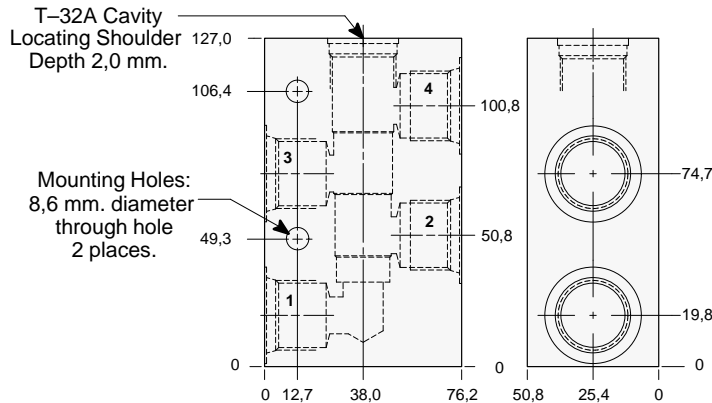

Instructions for ordering complete cartridge and body assemblies. Page viii

Pressure ratings, material specifications. Page 11.02

Ports 1, 2, 3, 4 & 5	ALUMINIUM		SG IRON	
	Model Code	List Price	Model Code	List Price
.375 NPTF	NNB		NNB/S	
.50 NPTF	NNC		NNC/S	
.75 NPTF	NND		NND/S	
SAE-8	NNJ		NNJ/S	
SAE-10	NNK		NNK/S	
SAE-12	NNL		NNL/S	
.375 BSPP	NNU		NNU/S	
.50 BSPP	NNV		NNV/S	
.75 BSPP	NNW		NNW/S	