

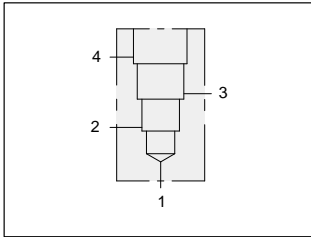

LINE MOUNT BODIES



- Aluminium rated to 210 bar and SG Iron rated to 350 bar.



90 degree body.

Mounting Holes:
10,7 mm. diameter through hole.
2 places.

T-24A Cavity
Locating Shoulder
Depth 50,8 mm.

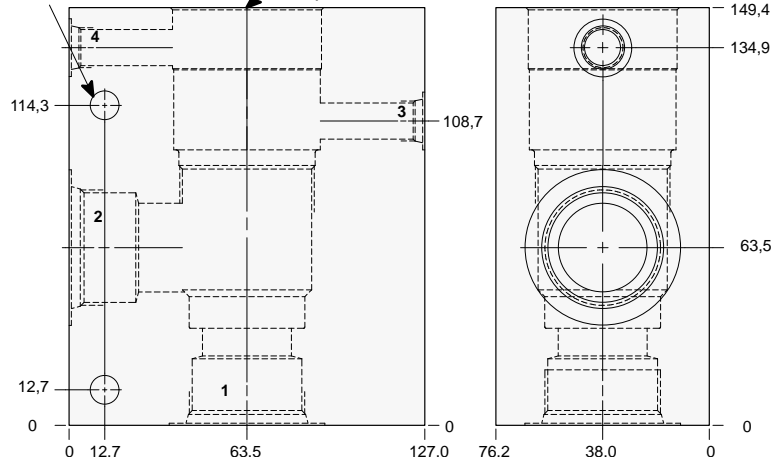

TYPICAL CARTRIDGES USED WITH THIS BODY

RVID - ***	Page	1.21
CWIA - ***	Page	4.19
CWIG - ***	Page	4.21
CVIV - ***	Page	4.23

Instructions for ordering complete cartridge and body assemblies. Page viii

Pressure ratings, material specifications. Page 11.02

Ports 1 & 2	Ports 3 & 4	ALUMINIUM		SG IRON	
		Model Code	List Price	Model Code	List Price
1.00 NPTF	.25 NPTF	QCE		QCE/S	
1.25 NPTF	.25 NPTF	QCF		QCF/S	
SAE-16	SAE-6	QCM		QCM/S	
SAE-20	SAE-6	QCN		QCN/S	
1.00 BSPP	.25 BSPP	QCX		QCX/S	
1.25 BSPP	.25 BSPP	QCY		QCY/S	

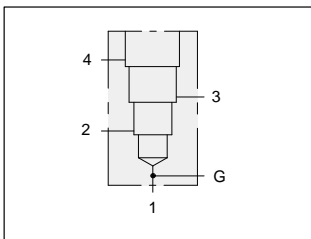

90 degree body with high capacity port 3 and gauge port.

Mounting Holes:
10,7 mm. diameter through hole.
2 places.

T-24A Cavity
Locating Shoulder
Depth 50,8 mm.

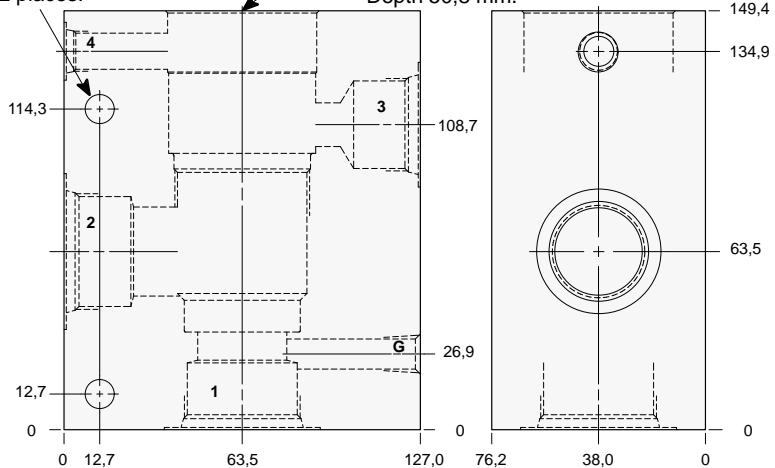

TYPICAL CARTRIDGES USED WITH THIS BODY

PVJA - ***	Page	3.15
PVJB - ***	Page	3.17
FVFA - ***	Page	6.05

Instructions for ordering complete cartridge and body assemblies. Page viii

Pressure ratings, material specifications. Page 11.02

Ports 1 & 2	Port 3	Port 4	Gauge Port	ALUMINIUM		SG IRON	
				Model Code	List Price	Model Code	List Price
1.00 NPTF	1.00 NPTF	.25 NPTF	.25 NPTF	QAE		QAE/S	
1.25 NPTF	1.00 NPTF	.25 NPTF	.25 NPTF	QAF		QAF/S	
SAE-16	SAE-16	SAE-6	.25 NPTF	QAM		QAM/S	
SAE-20	SAE-16	SAE-6	.25 NPTF	QAN		QAN/S	
1.00 BSPP	1.00 BSPP	.25 BSPP	.25 BSPP	QAX		QAX/S	
1.25 BSPP	1.00 BSPP	.25 BSPP	.25 BSPP	QAY		QAY/S	

Series 4 T-24A



LINE MOUNT BODIES



- Aluminium rated to 210 bar and SG Iron rated to 350 bar.

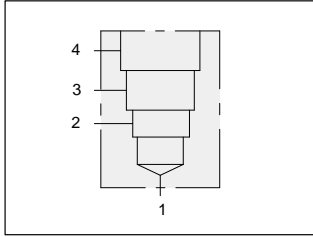

90 degree 1.25" SAE Code 61 flange port body.

Mounting Holes:
(opposite side)
Inch: .375-16 UNC-2B
x 15,7 mm. deep.
Metric: M10 x 1.50-6H
x 15,7 mm. deep.
2 places.

T-24A Cavity
Locating Shoulder
Depth 50,8 mm.

1.25" SAE Code 61
4-Bolt Flange Pattern
2 places.

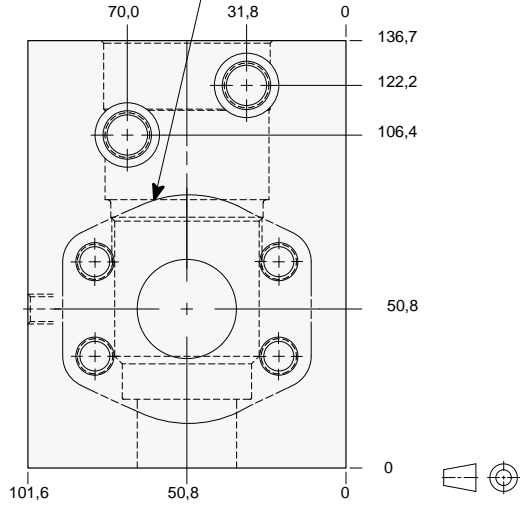
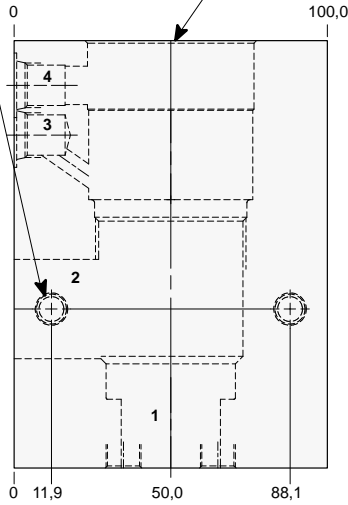

TYPICAL CARTRIDGES USED WITH THIS BODY

- RVID - *** Page 1.21
- CWIA - *** Page 4.19
- CWIG - *** Page 4.21
- CVIV - *** Page 4.23

Instructions for ordering complete cartridge and body assemblies. Page viii

Pressure ratings, material specifications. Page 11.02

SAE Specifications. Page 11.03

Mounting Hole Dimensions	Ports 3 & 4	ALUMINIUM		SG IRON	
		Model Code	List Price	Model Code	List Price
Inch	SAE-6	QCQ		QCQ/S	
Metric	.25 BSPP	QCQ/M		QCQ/T	

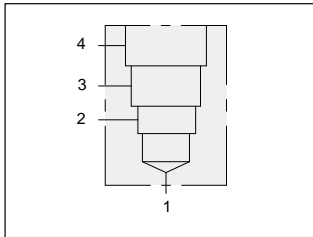

90 degree 1.25" SAE Code 62 flange port body.

Mounting Holes:
(opposite side)
Inch: .375-16 UNC-2B
x 15,7 mm. deep.
Metric: M10 x 1.50-6H
x 15,7 mm. deep.
2 places.

T-24A Cavity
Locating Shoulder
Depth 50,8 mm.

1.25" SAE Code 62
4-Bolt Flange Pattern
2 places.

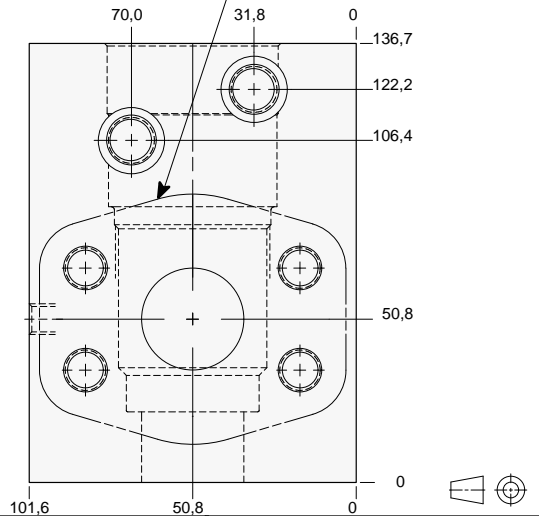
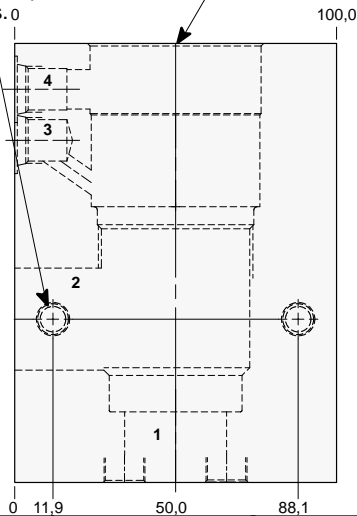

TYPICAL CARTRIDGES USED WITH THIS BODY

- RVID - *** Page 1.21
- CWIA - *** Page 4.19
- CWIG - *** Page 4.21
- CVIV - *** Page 4.23

Instructions for ordering complete cartridge and body assemblies. Page viii

Pressure ratings, material specifications. Page 11.02

SAE Specifications. Page 11.03

Mounting Hole Dimensions	Ports 3 & 4	ALUMINIUM		SG IRON	
		Model Code	List Price	Model Code	List Price
Inch	SAE-6	QC5		QC5/S	
Metric	.25 BSPP	QC5/M		QC5/T	



LINE MOUNT BODIES



- Aluminium rated to 210 bar and SG Iron rated to 350 bar.

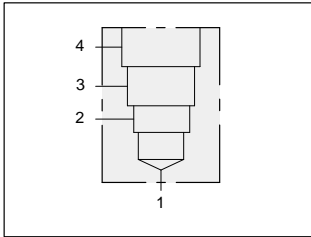

90 degree 1.50" SAE Code 61 flange port body.

Mounting Holes:
(opposite side)
Inch: .375-16 UNC-2B
x 15,7 mm. deep.
Metric: M10 x 1.50-6H
x 15,7 mm. deep.
2 places.

T-24A Cavity
Locating Shoulder
Depth 52,3 mm.

1.50" SAE Code 61
4-Bolt Flange Pattern
2 places.

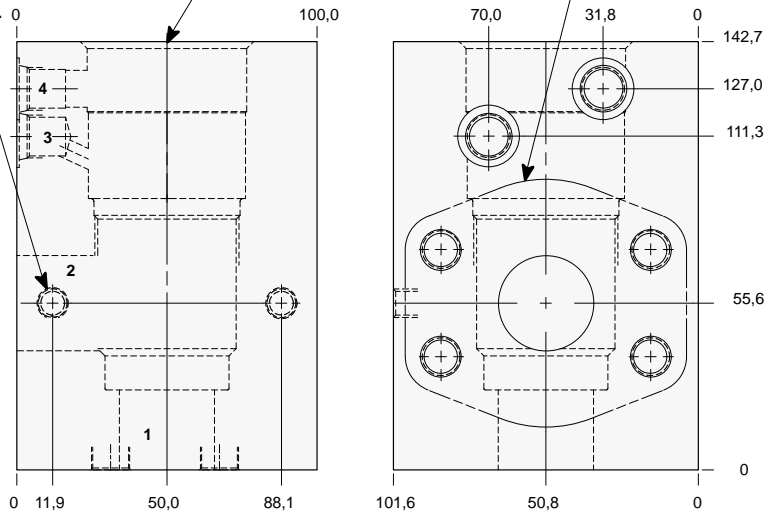

TYPICAL CARTRIDGES USED WITH THIS BODY

RVID - ***	Page	1.21
CWIA - ***	Page	4.19
CWIG - ***	Page	4.21
CVIV - ***	Page	4.23

Instructions for ordering complete cartridge and body assemblies. Page viii

Pressure ratings, material specifications. Page 11.02

SAE Specifications. Page 11.03

Mounting Hole Dimensions	Ports 3 & 4	ALUMINIUM		SG IRON	
		Model Code	List Price	Model Code	List Price
Inch	SAE-6	QCR		QCR/S	
Metric	.25 BSPP	QCR/M		QCR/T	

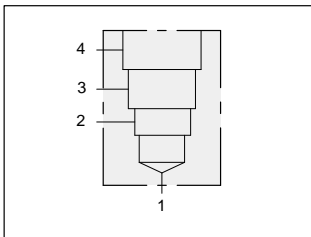

90 degree 1.50" SAE Code 62 flange port body.

Mounting Holes:
(opposite side)
Inch: .375-16 UNC-2B
x 15,7 mm. deep.
Metric: M10 x 1.50-6H
x 15,7 mm. deep.
2 places.

T-24A Cavity
Locating Shoulder
Depth 52,3 mm.

1.50" SAE Code 62
4-Bolt Flange Pattern
2 places.

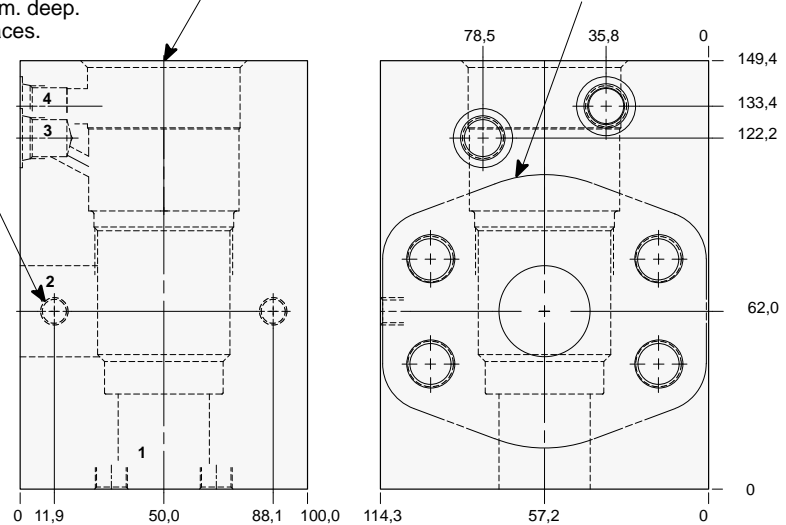

TYPICAL CARTRIDGES USED WITH THIS BODY

RVID - ***	Page	1.21
CWIA - ***	Page	4.19
CWIG - ***	Page	4.21
CVIV - ***	Page	4.23

Instructions for ordering complete cartridge and body assemblies. Page viii

Pressure ratings, material specifications. Page 11.02

SAE Specifications. Page 11.03

Mounting Hole Dimensions	Ports 3 & 4	ALUMINIUM		SG IRON	
		Model Code	List Price	Model Code	List Price
Inch	SAE-6	QC6		QC6/S	
Metric	.25 BSPP	QC6/M		QC6/T	



LINE MOUNT BODIES



- Aluminium rated to 210 bar and SG Iron rated to 350 bar.

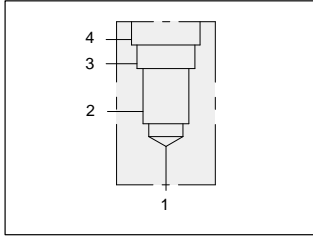

90 degree 2.00" SAE Code 61 flange port body.

Mounting Holes:
(opposite side)
Inch: .375-16 UNC-2B
x 19,0 mm. deep.
Metric: M10 x 1.50-6H
x 19,0 mm. deep.
2 places.

T-24A Cavity
Locating Shoulder
Depth 52,3 mm.

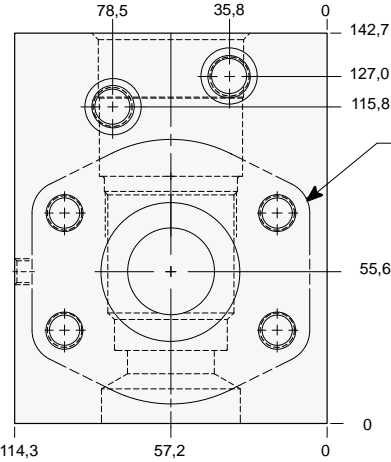
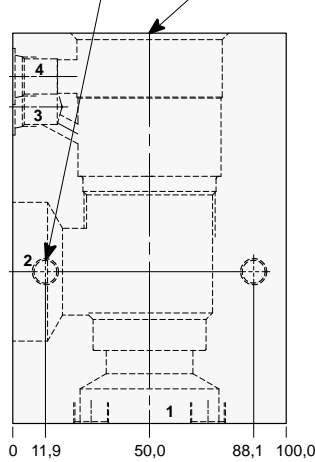

2.00" SAE Code 61
4-Bolt Flange Pattern
2 places.

TYPICAL CARTRIDGES USED WITH THIS BODY

- RVID - *** Page 1.21
- CWIA - *** Page 4.19
- CWIG - *** Page 4.21
- CVIV - *** Page 4.23

- Instructions for ordering complete cartridge and body assemblies. Page viii
- Pressure ratings, material specifications. Page 11.02
- SAE Specifications. Page 11.03

Mounting Hole Dimensions	Ports 3 & 4	ALUMINIUM		SG IRON	
		Model Code	List Price	Model Code	List Price
Inch	SAE-6	QCS		QCS/S	
Metric	.25 BSPP	QCS/M		QCS/T	

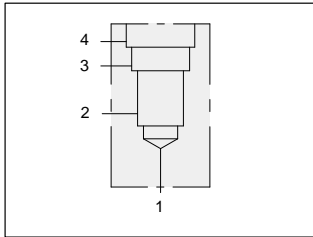

90 degree 2.00" SAE Code 62 flange port body.

Mounting Holes:
(opposite side)
Inch: .375-16 UNC-2B
x 19,0 mm. deep.
Metric: M10 x 1.50-6H
x 19,0 mm. deep.
2 places.

T-24A Cavity
Locating Shoulder
Depth 58,7 mm.

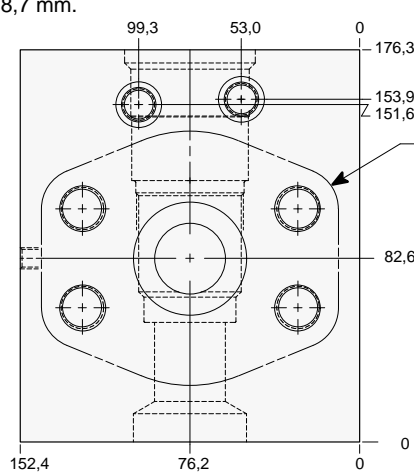
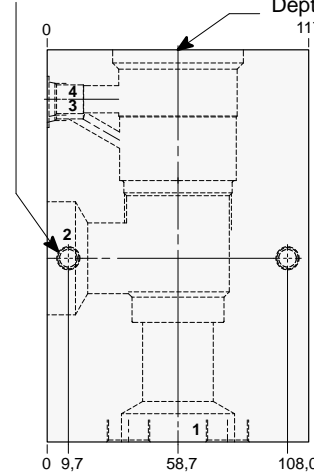

2.00" SAE Code 62
4-Bolt Flange Pattern
2 places.

TYPICAL CARTRIDGES USED WITH THIS BODY

- RVID - *** Page 1.21
- CWIA - *** Page 4.19
- CWIG - *** Page 4.21
- CVIV - *** Page 4.23

- Instructions for ordering complete cartridge and body assemblies. Page viii
- Pressure ratings, material specifications. Page 11.02
- SAE Specifications. Page 11.03

Mounting Hole Dimensions	Ports 3 & 4	ALUMINIUM		SG IRON	
		Model Code	List Price	Model Code	List Price
Inch	SAE-6	QC8		QC8/S	
Metric	.25 BSPP	QC8/M		QC8/T	

Series 4 T-24A



LINE MOUNT BODIES



- Aluminium rated to 210 bar and SG Iron rated to 350 bar.

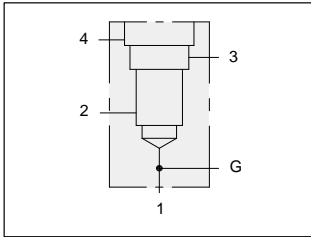

90 degree 1.25" SAE Code 61 high capacity flange port body with gauge port.

Mounting Holes:
(opposite side)
Inch: .375-16 UNC-2B
x 19,0 mm. deep.
Metric: M10 x 1.50-6H
x 19,0 mm. deep.
2 places.

T-24A Cavity
Locating Shoulder
Depth 50,8 mm.

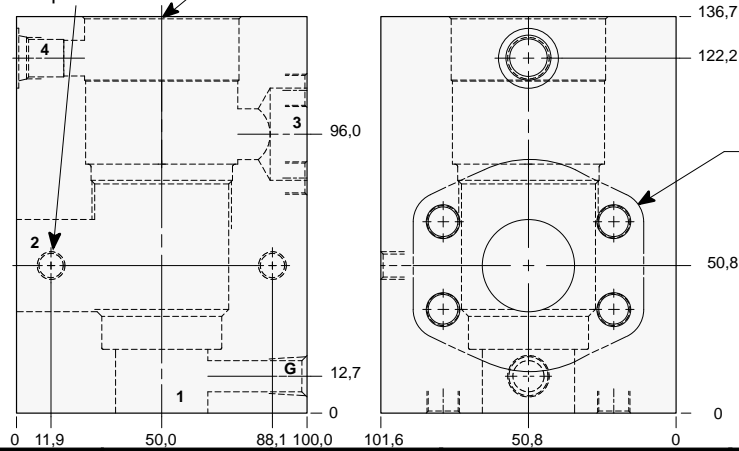

TYPICAL CARTRIDGES USED WITH THIS BODY

PVJA - *** Page 3.15
PVJB - *** Page 3.17
FVFA - *** Page 6.05

Instructions for ordering complete cartridge and body assemblies. Page viii
Pressure ratings, material specifications. Page 11.02
SAE Specifications. Page 11.03

Mounting Hole Dimensions	Port 4	Gauge Port	ALUMINIUM		SG IRON	
			Model Code	List Price	Model Code	List Price
Inch	SAE-6	.25 NPTF	QAQ		QAQ/S	
Metric	.25 BSPP	.25 BSPP	QAQ/M		QAQ/T	

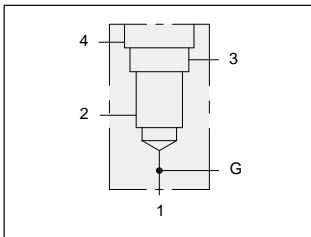

90 degree 1.25" SAE Code 62 high capacity flange port body with gauge port.

Mounting Holes:
(opposite side)
Inch: .375-16 UNC-2B
x 19,0 mm. deep.
Metric: M10 x 1.50-6H
x 19,0 mm. deep.
2 places.

T-24A Cavity
Locating Shoulder
Depth 50,8 mm.

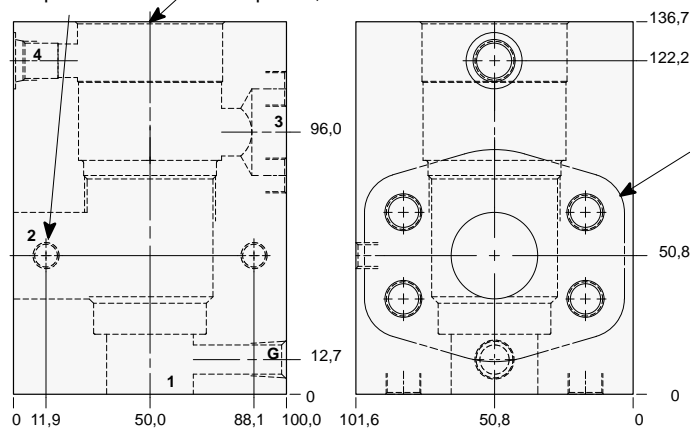

TYPICAL CARTRIDGES USED WITH THIS BODY

PVJA - *** Page 3.15
PVJB - *** Page 3.17
FVFA - *** Page 6.05

Instructions for ordering complete cartridge and body assemblies. Page viii
Pressure ratings, material specifications. Page 11.02
SAE Specifications. Page 11.03

Mounting Hole Dimensions	Port 4	Gauge Port	ALUMINIUM		SG IRON	
			Model Code	List Price	Model Code	List Price
Inch	SAE-6	.25 NPTF	QA5		QA5/S	
Metric	.25 BSPP	.25 BSPP	QA5/M		QA5/T	

Series 4 T-24A



LINE MOUNT BODIES



- Aluminium rated to 210 bar and SG Iron rated to 350 bar.

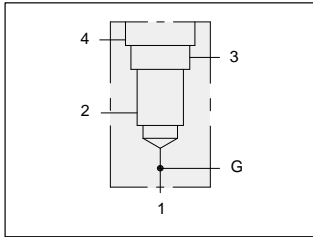

90 degree 1.50" SAE Code 61 high capacity flange port body with gauge port.

Mounting Holes:
(opposite side)
Inch: .375-16 UNC-2B
x 19,0 mm. deep.
Metric: M10 x 1.50-6H
x 19,0 mm. deep.
2 places.

T-24A Cavity
Locating Shoulder
Depth 52,3 mm.

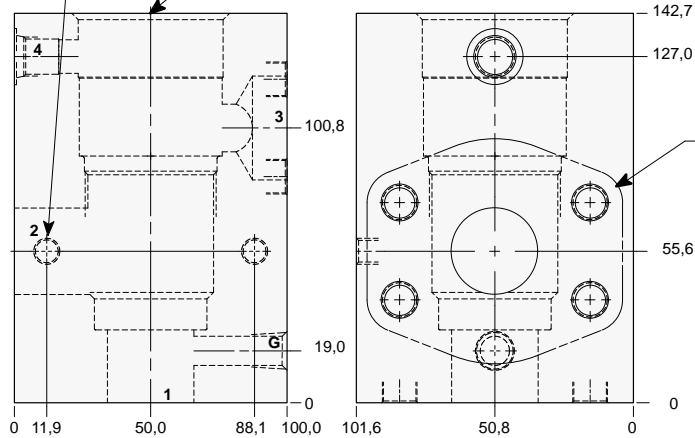

1.50" SAE Code 61
4-Bolt Flange Pattern
3 places.

TYPICAL CARTRIDGES USED WITH THIS BODY

PVJA - *** Page 3.15
PVJB - *** Page 3.17
FVFA - *** Page 6.05

Instructions for ordering complete cartridge and body assemblies. Page viii

Pressure ratings, material specifications. Page 11.02

SAE Specifications. Page 11.03

Mounting Hole Dimensions	Port 4	Gauge Port	ALUMINIUM		SG IRON	
			Model Code	List Price	Model Code	List Price
Inch	SAE-6	.25 NPTF	QAR		QAR/S	
Metric	.25 BSPP	.25 BSPP	QAR/M		QAR/T	

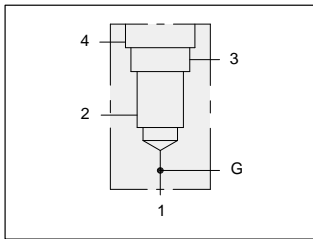

90 degree 1.50" SAE Code 62 high capacity flange port body with gauge port.

Mounting Holes:
(opposite side)
Inch: .375-16 UNC-2B
x 19,0 mm. deep.
Metric: M10 x 1.50-6H
x 19,0 mm. deep.
2 places.

T-24A Cavity
Locating Shoulder
Depth 58,7 mm.

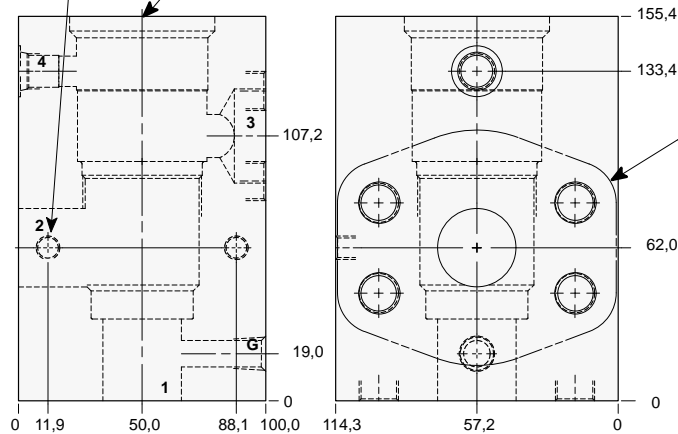

1.50" SAE Code 62
4-Bolt Flange Pattern
3 places.

TYPICAL CARTRIDGES USED WITH THIS BODY

PVJA - *** Page 3.15
PVJB - *** Page 3.17
FVFA - *** Page 6.05

Instructions for ordering complete cartridge and body assemblies. Page viii

Pressure ratings, material specifications. Page 11.02

SAE Specifications. Page 11.03

Mounting Hole Dimensions	Port 4	Gauge Port	ALUMINIUM		SG IRON	
			Model Code	List Price	Model Code	List Price
Inch	SAE-6	.25 NPTF	QA6		QA6/S	
Metric	.25 BSPP	.25 BSPP	QA6/M		QA6/T	

Series 4 T-24A



LINE MOUNT BODIES



- Aluminium rated to 210 bar and SG Iron rated to 350 bar.

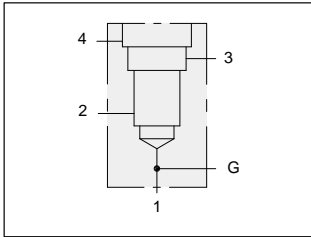

90 degree 2.00" SAE Code 61 high capacity flange port body with gauge port.

Mounting Holes:
(opposite side)
Inch: .375-16 UNC-2B
x 19,0 mm. deep.
Metric: M10 x 1.50-6H
x 19,0 mm. deep.
2 places.

T-24A Cavity
Locating Shoulder
Depth 52,3 mm.

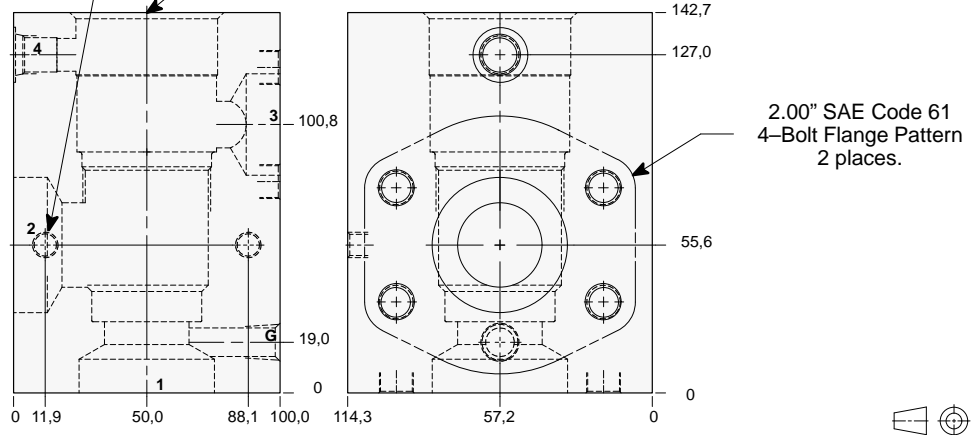

TYPICAL CARTRIDGES USED WITH THIS BODY

PVJA - ***	Page	3.15
PVJB - ***	Page	3.17
FVFA - ***	Page	6.05

Instructions for ordering complete cartridge and body assemblies. Page viii

Pressure ratings, material specifications. Page 11.02

SAE Specifications. Page 11.03

Mounting Hole Dimensions	Port 3 SAE Code 61	Port 4	Gauge Port	ALUMINIUM		SG IRON	
				Model Code	List Price	Model Code	List Price
Inch	1.50"	SAE-6	.25 NPTF	QAS		QAS/S	
Metric	1.50"	.25 BSPP	.25 BSPP	QAS/M		QAS/T	

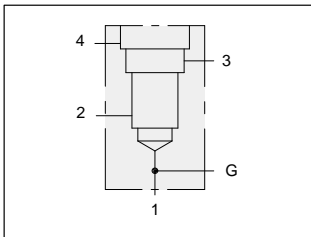

90 degree 2.00" SAE Code 62 high capacity flange port body with gauge port.

Mounting Holes:
(opposite side)
Inch: .375-16 UNC-2B
x 19,0 mm. deep.
Metric: M10 x 1.50-6H
x 19,0 mm. deep.
2 places.

T-24A Cavity
Locating Shoulder
Depth 58,7 mm.

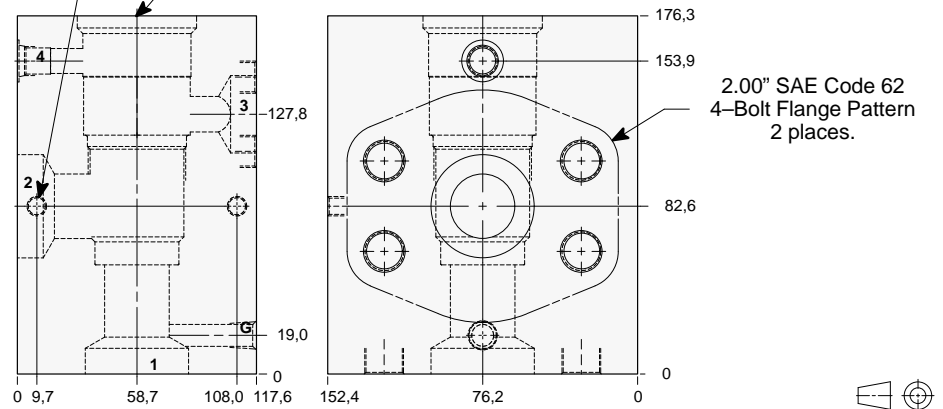

TYPICAL CARTRIDGES USED WITH THIS BODY

PVJA - ***	Page	3.15
PVJB - ***	Page	3.17
FVFA - ***	Page	6.05

Instructions for ordering complete cartridge and body assemblies. Page viii

Pressure ratings, material specifications. Page 11.02

SAE Specifications. Page 11.03

Mounting Hole Dimensions	Port 3 SAE Code 62	Port 4	Gauge Port	ALUMINIUM		SG IRON	
				Model Code	List Price	Model Code	List Price
Inch	1.50"	SAE-6	.25 NPTF	QA8		QA8/S	
Metric	1.50"	.25 BSPP	.25 BSPP	QA8/M		QA8/T	

Series 4 T-24A



LINE MOUNT BODIES



- Aluminium rated to 210 bar and SG Iron rated to 350 bar.

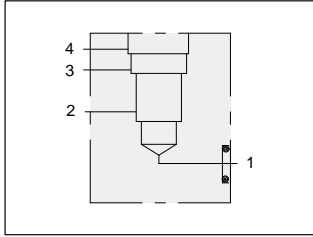

Direct mount 1.00" SAE Code 62 body.

T-24A Cavity
Locating Shoulder
Depth 50,8 mm.

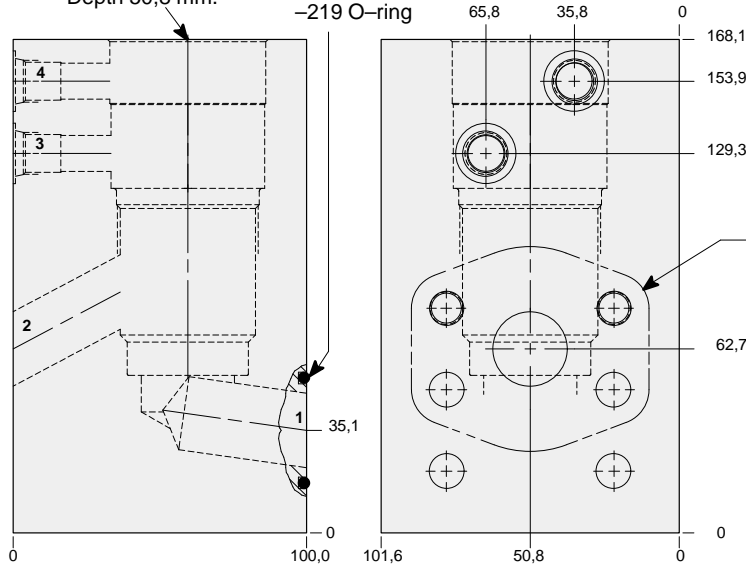

1.00" SAE Code 62
4-Bolt Flange Pattern
2 places.
2 holes tapped
4 holes through

TYPICAL CARTRIDGES USED WITH THIS BODY

- RVID - *** Page 1.21
- CWIA - *** Page 4.19
- CWIG - *** Page 4.21
- CVIV - *** Page 4.23

Cartridge seal type determines O-ring type.

Instructions for ordering complete cartridge and body assemblies. Page viii

Pressure ratings, material specifications. Page 11.02

SAE Specifications. Page 11.03

Mounting Hole Dimensions	Ports 3 & 4	ALUMINIUM		SG IRON	
		Model Code	List Price	Model Code	List Price
Inch	SAE-6	WGY		WGY/S	
Metric	.25 BSPP	WGY/M		WGY/T	

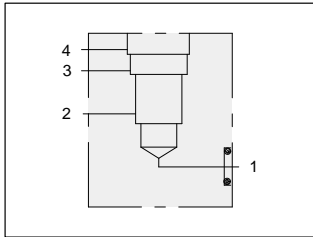

Direct mount 1.25" SAE Code 62 body

T-24A Cavity
Locating Shoulder
Depth 50,8 mm.

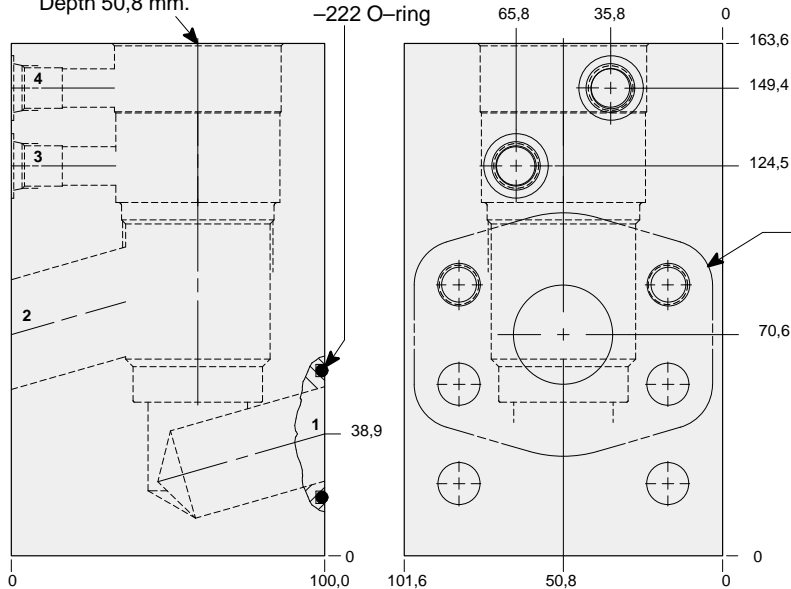

1.25" SAE Code 62
4-Bolt Flange Pattern
2 places.
2 holes tapped
4 holes through

TYPICAL CARTRIDGES USED WITH THIS BODY

- RVID - *** Page 1.21
- CWIA - *** Page 4.19
- CWIG - *** Page 4.21
- CVIV - *** Page 4.23

Cartridge seal type determines O-ring type.

Instructions for ordering complete cartridge and body assemblies. Page viii

Pressure ratings, material specifications. Page 11.02

SAE Specifications. Page 11.03

Mounting Hole Dimensions	Ports 3 & 4	ALUMINIUM		SG IRON	
		Model Code	List Price	Model Code	List Price
Inch	SAE-6	WGZ		WGZ/S	
Metric	.25 BSPP	WGZ/M		WGZ/T	



LINE MOUNT BODIES



- Aluminium rated to 210 bar and SG Iron rated to 350 bar.

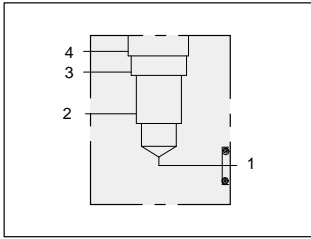

Direct mount 1.50" SAE Code 62 body.

T-24A Cavity
Locating Shoulder
Depth 51,6 mm.

-225 O-ring

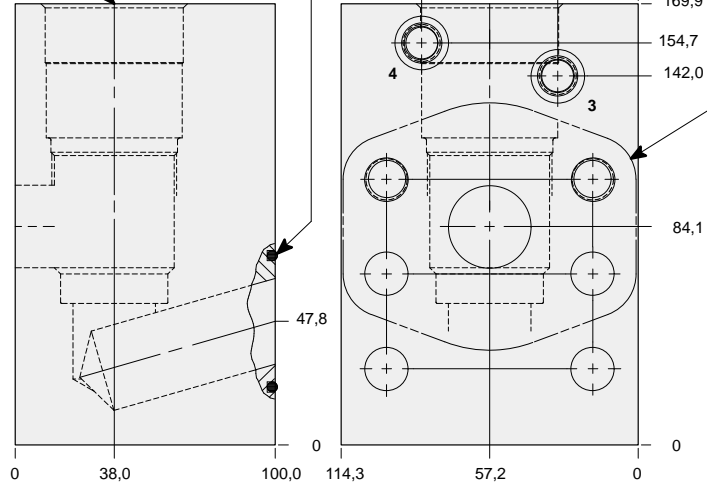

1.50" SAE Code 62
4-Bolt Flange Pattern
2 places.
2 holes tapped
4 holes through



TYPICAL CARTRIDGES USED WITH THIS BODY

RVID - ***	Page	1.21
CWIA - ***	Page	4.19
CWIG - ***	Page	4.21
CVIV - ***	Page	4.23

Cartridge seal type determines O-ring type.

Instructions for ordering complete cartridge and body assemblies. Page viii

Pressure ratings, material specifications. Page 11.02

SAE Specifications. Page 11.03

Mounting Hole Dimensions	Ports 3 & 4	ALUMINIUM		SG IRON	
		Model Code	List Price	Model Code	List Price
Inch	SAE-6	WGT		WGT/S	
Metric	.25 BSPP	WGT/M		WGT/T	



LINE MOUNT BODIES



- Aluminum rated to 210 bar and SG Iron rated to 350 bar.

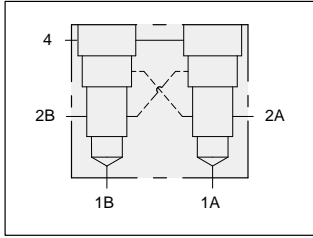

Two cavity cross-piloted body with common port 4 for load control applications.

T-24A Cavity Locating Shoulder Depth 50,8 mm. 2 places.

Mounting Holes: 10,7 mm. diameter through hole. 2 places.

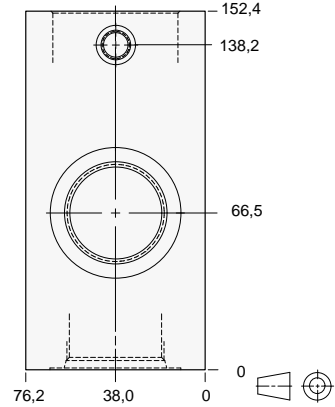
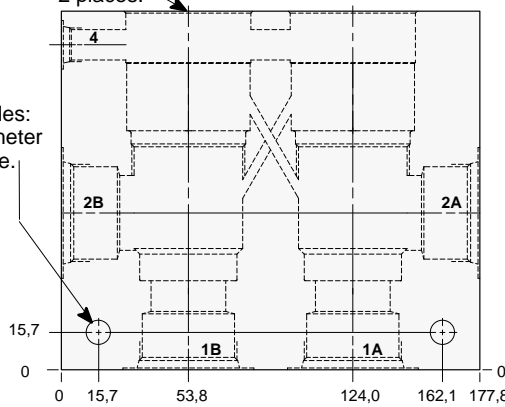

TYPICAL CARTRIDGES USED WITH THIS BODY

- CWIA - *** Page 4.19
- CWIG - *** Page 4.21
- CVIV - *** Page 4.23

Instructions for ordering complete cartridge and body assemblies. Page iii

Pressure ratings, material specifications. Page 11.02

Ports 1A, 1B, 2A, & 2B	Ports 4A & 4B	ALUMINIUM		SG IRON	
		Model Code	List Price	Model Code	List Price
1.00 NPTF	.25 NPTF	XLE		XLE/S	
1.25 NPTF	.25 NPTF	XLF		XLF/S	
SAE-16	SAE-6	XLM		XLM/S	
SAE-20	SAE-6	XLN		XLN/S	
1.00 BSPP	.25 BSPP	XLX		XLX/S	
1.25 BSPP	.25 BSPP	XLY		XLY/S	

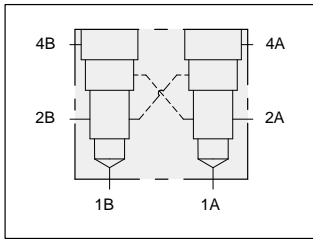

Two cavity cross-piloted body with independent port 4 for load control applications.

T-24A Cavity Locating Shoulder Depth 50,8 mm. 2 places.

Mounting Holes: 10,7 mm. diameter through hole. 2 places.

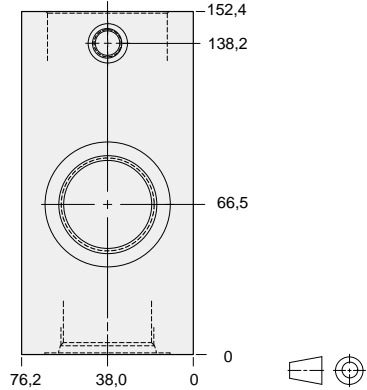
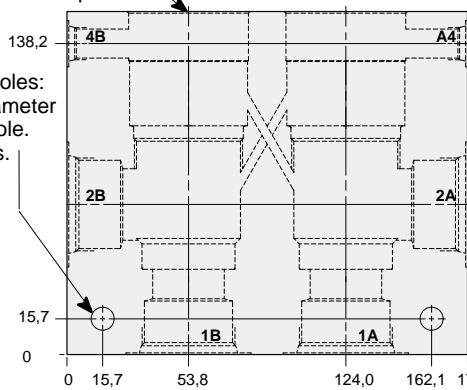

TYPICAL CARTRIDGES USED WITH THIS BODY

- CWIA - *** Page 4.19
- CWIG - *** Page 4.21
- CVIV - *** Page 4.23

Instructions for ordering complete cartridge and body assemblies. Page iii

Pressure ratings, material specifications. Page 11.02

Ports 1A, 1B, 2A, & 2B	Ports 4A & 4B	ALUMINIUM		SG IRON	
		Model Code	List Price	Model Code	List Price
1.00 NPTF	.25 NPTF	XSE		XSE/S	
1.25 NPTF	.25 NPTF	XSF		XSF/S	
SAE-16	SAE-6	XSM		XSM/S	
SAE-20	SAE-6	XSN		XSN/S	
1.00 BSPP	.25 BSPP	XSX		XSX/S	
1.25 BSPP	.25 BSPP	XSY		XSY/S	



LINE MOUNT BODIES



- Aluminum rated to 210 bar and SG Iron rated to 350 bar.

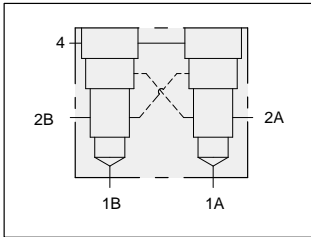

Two cavity cross-piloted 1.50" SAE Code 61 flange port body with common port 4 for load control applications.

Mounting Holes:
(opposite side)
Inch: .375-16 UNC-2B
x 15,7 mm. deep.
Metric: M10 x 1.50-6H
x 15,7 mm. deep.
2 places.

T-24A Cavity
Locating Shoulder
Depth 50,8 mm.
2 places.

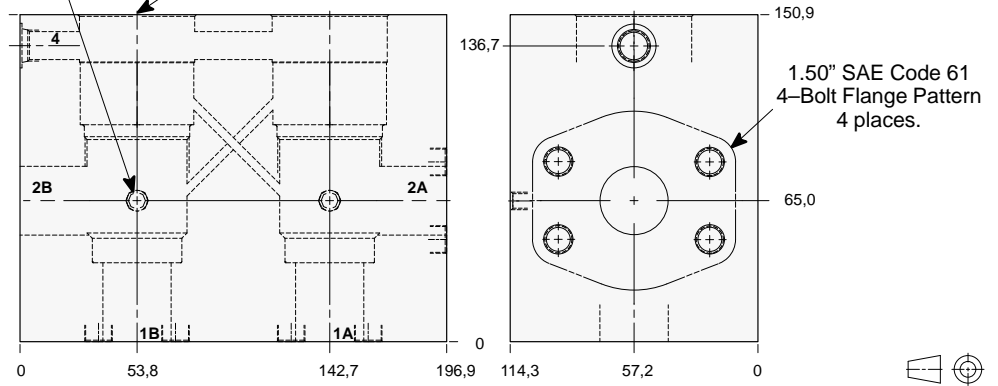

TYPICAL CARTRIDGES USED WITH THIS BODY

CWIA - *** Page 4.19
CWIG - *** Page 4.21
CVIV - *** Page 4.23

Instructions for ordering complete cartridge and body assemblies. Page iii
Pressure ratings, material specifications. Page 11.02
SAE Specifications. Page 11.03

Mounting Hole Dimensions	Port 4	ALUMINIUM		SG IRON	
		Model Code	List Price	Model Code	List Price
Inch	SAE-6	XLR		XLR/S	
Metric	.25 BSPP	XLR/M		XLR/T	

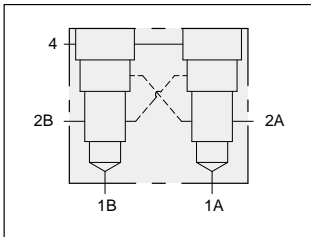

Two cavity cross-piloted 1.50" SAE Code 62 flange port body with common port 4 for load control applications.

Mounting Holes:
(opposite side)
Inch: .375-16 UNC-2B
x 15,7 mm. deep.
Metric: M10 x 1.50-6H
x 15,7 mm. deep.
2 places.

T-24A Cavity
Locating Shoulder
Depth 50,8 mm.
2 places.

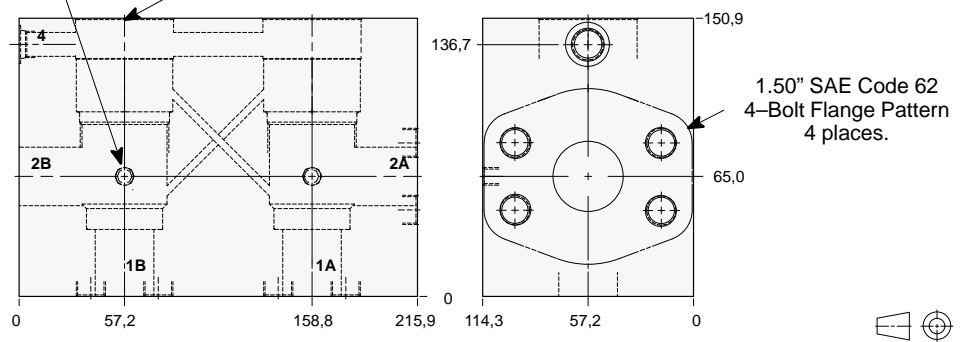

TYPICAL CARTRIDGES USED WITH THIS BODY

CWIA - *** Page 4.19
CWIG - *** Page 4.21
CVIV - *** Page 4.23

Instructions for ordering complete cartridge and body assemblies. Page iii
Pressure ratings, material specifications. Page 11.02
SAE Specifications. Page 11.03

Mounting Hole Dimensions	Port 4	ALUMINIUM		SG IRON	
		Model Code	List Price	Model Code	List Price
Inch	SAE-6	XL6		XL6/S	
Metric	.25 BSPP	XL6/M		XL6/T	

Series 4 T-24A



LINE MOUNT BODIES



- Aluminum rated to 210 bar and SG Iron rated to 350 bar.

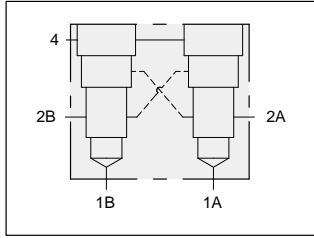

Two cavity cross-piloted 2.00" SAE Code 61 flange port body with common port 4 for load control applications.

TYPICAL CARTRIDGES USED WITH THIS BODY

- CWIA - *** Page 4.19
- CWIG - *** Page 4.21
- CVIV - *** Page 4.23

Instructions for ordering complete cartridge and body assemblies. Page iii

Pressure ratings, material specifications. Page 11.02

SAE Specifications. Page 11.03

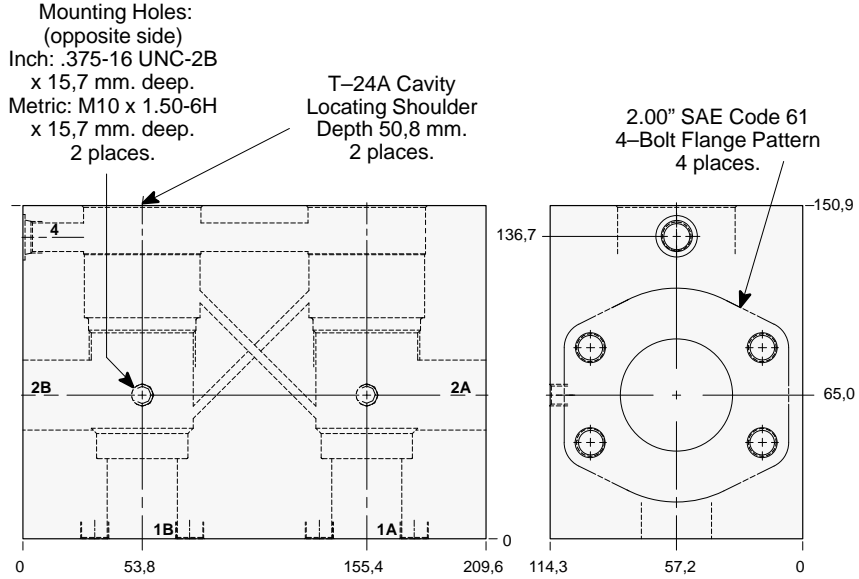

Mounting Hole Dimensions	Port 4	ALUMINIUM		SG IRON	
		Model Code	List Price	Model Code	List Price
Inch	SAE-6	XLS		XLS/S	
Metric	.25 BSPP	XLS/M		XLS/T	

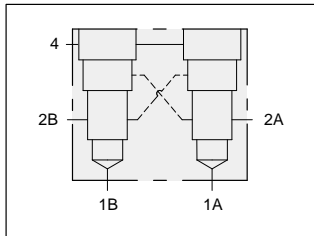

Two cavity cross-piloted 2.00" SAE Code 62 flange port body with common port 4 for load control applications.

TYPICAL CARTRIDGES USED WITH THIS BODY

- CWIA - *** Page 4.19
- CWIG - *** Page 4.21
- CVIV - *** Page 4.23

Instructions for ordering complete cartridge and body assemblies. Page iii

Pressure ratings, material specifications. Page 11.02

SAE Specifications. Page 11.03

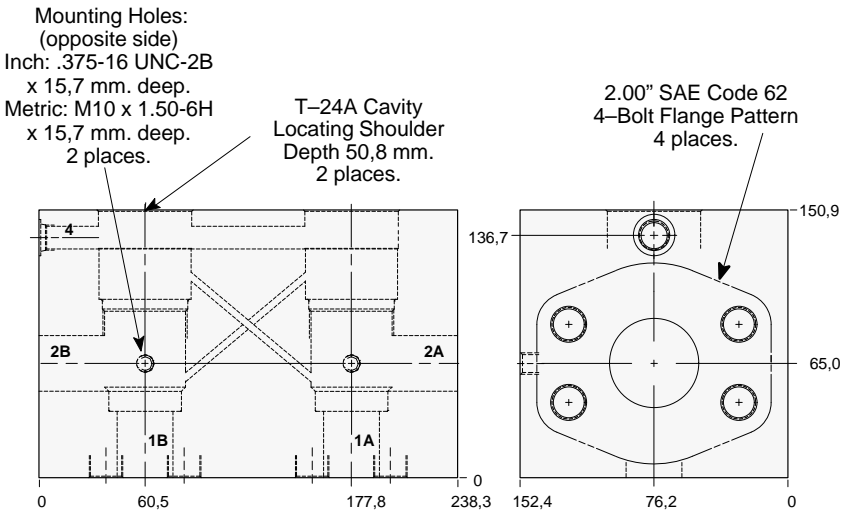

Mounting Hole Dimensions	Port 4	ALUMINIUM		SG IRON	
		Model Code	List Price	Model Code	List Price
Inch	SAE-6	XL8		XL8/S	
Metric	.25 BSPP	XL8/M		XL8/T	



LINE MOUNT BODIES



- Aluminum rated to 210 bar and SG Iron rated to 350 bar.

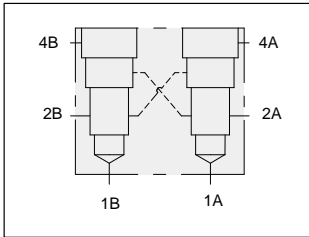

Two cavity cross-piloted 1.50" SAE Code 61 flange port body with independent port 4 for load control applications.

TYPICAL CARTRIDGES USED WITH THIS BODY

CWIA - ***	Page	4.19
CWIG - ***	Page	4.21
CVIV - ***	Page	4.23

Instructions for ordering complete cartridge and body assemblies. Page viii

Pressure ratings, material specifications. Page 11.02

SAE Specifications. Page 11.03

Mounting Holes:
(opposite side)
Inch: .375-16 UNC-2B
x 15,7 mm. deep.
Metric: M10 x 1.50-6H
x 15,7 mm. deep.
2 places.

T-24A Cavity
Locating Shoulder
Depth 50,8 mm.
2 places.

1.50" SAE Code 61
4-Bolt Flange Pattern
4 places.

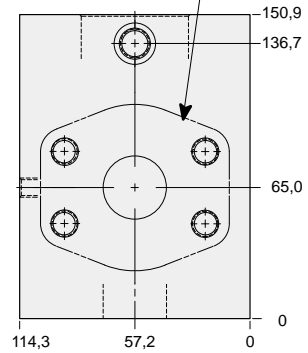
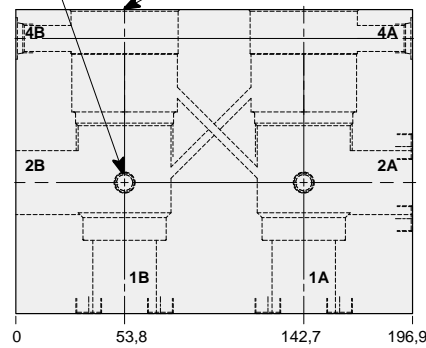

Mounting Hole Dimensions	Ports 4A & 4B	ALUMINIUM		SG IRON	
		Model Code	List Price	Model Code	List Price
Inch	SAE-6	XSR		XSR/S	
Metric	.25 BSPP	XSR/M		XSR/T	

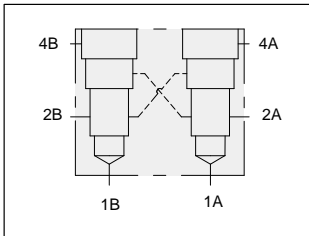

Two cavity cross-piloted 1.50" SAE Code 62 flange port body with independent port 4 for load control applications.

TYPICAL CARTRIDGES USED WITH THIS BODY

CWIA - ***	Page	4.19
CWIG - ***	Page	4.21
CVIV - ***	Page	4.23

Instructions for ordering complete cartridge and body assemblies. Page viii

Pressure ratings, material specifications. Page 11.02

SAE Specifications. Page 11.03

Mounting Holes:
(opposite side)
Inch: .375-16 UNC-2B
x 15,7 mm. deep.
Metric: M10 x 1.50-6H
x 15,7 mm. deep.
2 places.

T-24A Cavity
Locating Shoulder
Depth 50,8 mm.
2 places.

1.50" SAE Code 62
4-Bolt Flange Pattern
4 places.

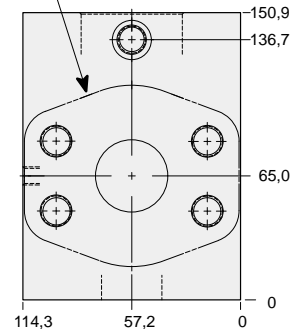
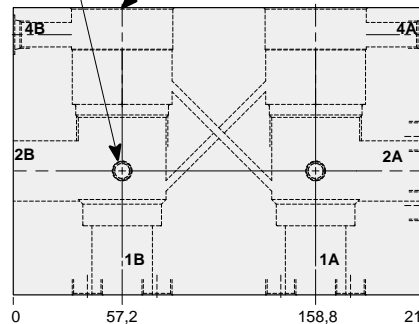

Mounting Hole Dimensions	Ports 4A & 4B	ALUMINIUM		SG IRON	
		Model Code	List Price	Model Code	List Price
Inch	SAE-6	XS6		XS6/S	
Metric	.25 BSPP	XS6M		XS6/T	

Series 4 T-24A



LINE MOUNT BODIES



- Aluminum rated to 210 bar and SG Iron rated to 350 bar.

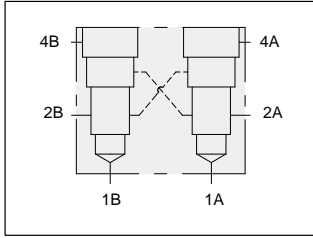

Two cavity cross-piloted 2.00" SAE Code 61 flange port body with independent port 4 for load control applications.

Mounting Holes:
(opposite side)
Inch: .375-16 UNC-2B
x 15,7 mm. deep.
Metric: M10 x 1.50-6H
x 15,7 mm. deep.
2 places.

T-24A Cavity
Locating Shoulder
Depth 50,8 mm.
2 places.

2.00" SAE Code 61
4-Bolt Flange Pattern
4 places.

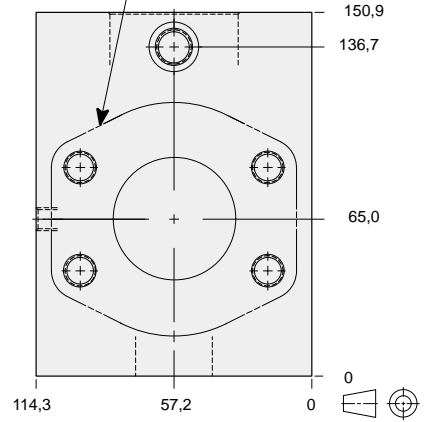
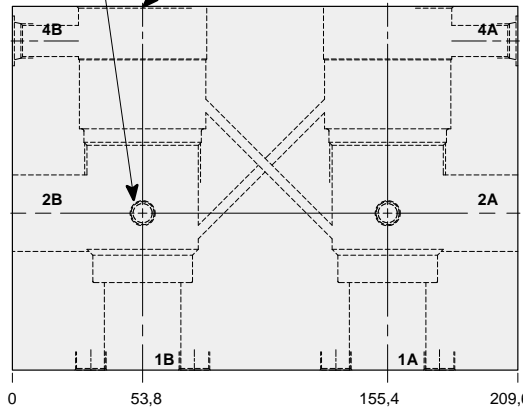

TYPICAL CARTRIDGES USED WITH THIS BODY

- CWIA - *** Page 4.19
- CWIG - *** Page 4.21
- CVIV - *** Page 4.23

Instructions for ordering complete cartridge and body assemblies. Page viii

Pressure ratings, material specifications. Page 11.02

SAE Specifications. Page 11.03

Mounting Hole Dimensions	Port 4	ALUMINIUM		SG IRON	
		Model Code	List Price	Model Code	List Price
Inch	SAE-6	XSS		XSS/S	
Metric	.25 BSPP	XSS/M		XSS/T	

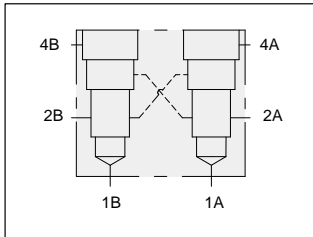

Two cavity cross-piloted 2.00" SAE Code 62 flange port body with independent port 4 for load control applications.

Mounting Holes:
(opposite side)
Inch: .375-16 UNC-2B
x 15,7 mm. deep.
Metric: M10 x 1.50-6H
x 15,7 mm. deep.
2 places.

T-24A Cavity
Locating Shoulder
Depth 50,8 mm.
2 places.

2.00" SAE Code 62
4-Bolt Flange Pattern
4 places.

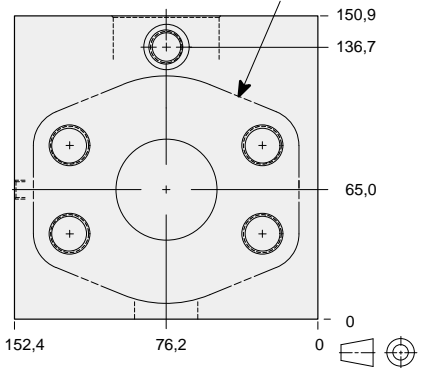
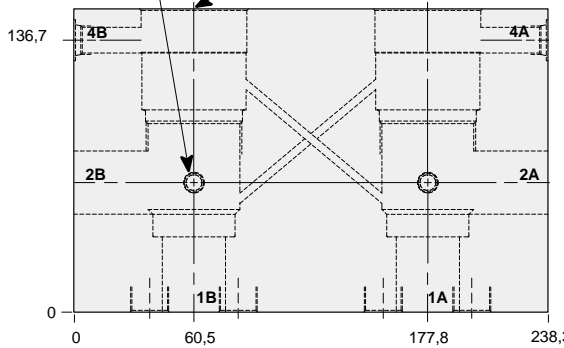

TYPICAL CARTRIDGES USED WITH THIS BODY

- CWIA - *** Page 4.19
- CWIG - *** Page 4.21
- CVIV - *** Page 4.23

Instructions for ordering complete cartridge and body assemblies. Page viii

Pressure ratings, material specifications. Page 11.02

SAE Specifications. Page 11.03

Mounting Hole Dimensions	Port 4	ALUMINIUM		SG IRON	
		Model Code	List Price	Model Code	List Price
Inch	SAE-6	XS8		XS8/S	
Metric	.25 BSPP	XS8/M		XS8/T	



LINE MOUNT BODIES



- Aluminium rated to 210 bar and SG Iron rated to 350 bar.

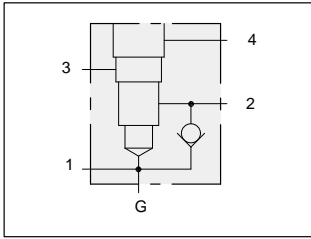

Body with high capacity port 3 reverse free flow check and gauge port for reducing/relieving applications.

T-24A Cavity
Locating Shoulder
Depth 50,8 mm.

Mounting Holes:
10,7 mm. diameter through hole.
2 places.

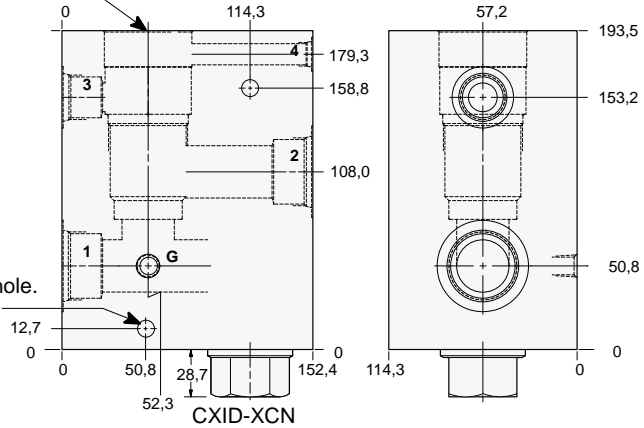

**TYPICAL CARTRIDGES
USED WITH THIS BODY**

- PVJA - *** Page 3.15
PVJB - *** Page 3.17

Cartridge seal type determines
check valve seal type.

Instructions for ordering
complete cartridge and body
assemblies. Page viii

Pressure ratings, material
specifications. Page 11.02

Ports 1 & 2	Port 3	Port 4	Gauge Port	ALUMINIUM		SG IRON	
				Model Code	List Price	Model Code	List Price
.75 NPTF	.75 NPTF	.25 NPTF	.25 NPTF	Q4D		Q4D/S	
1.00 NPTF	.75 NPTF	.25 NPTF	.25 NPTF	Q4E		Q4E/S	
1.25 NPTF	.75 NPTF	.25 NPTF	.25 NPTF	Q4F		Q4F/S	
SAE-12	SAE-12	SAE-6	.25 NPTF	Q4L		Q4L/S	
SAE-16	SAE-12	SAE-6	.25 NPTF	Q4M		Q4M/S	
SAE-20	SAE-12	SAE-6	.25 NPTF	Q4N		Q4N/S	
.75 BSPP	.75 BSPP	.25 BSPP	.25 BSPP	Q4W		Q4W/S	
1.00 BSPP	.75 BSPP	.25 BSPP	.25 BSPP	Q4X		Q4X/S	
1.25 BSPP	.75 BSPP	.25 BSPP	.25 BSPP	Q4Y		Q4Y/S	



LINE MOUNT BODIES



- Aluminium rated to 210 bar and SG Iron rated to 350 bar.

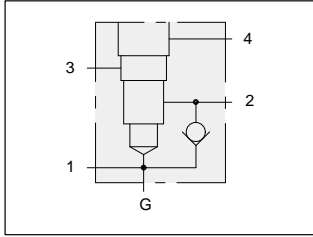

1.50" SAE Code 61 flange port body with high capacity port 3 reverse free flow check and gauge port for reducing/relieving applications.

TYPICAL CARTRIDGES USED WITH THIS BODY

- PVJA - *** Page 3.15
- PVJB - *** Page 3.17

Cartridge seal type determines check valve seal type.

Instructions for ordering complete cartridge and body assemblies. Page viii

Pressure ratings, material specifications. Page 11.02

SAE Specifications. Page 11.03

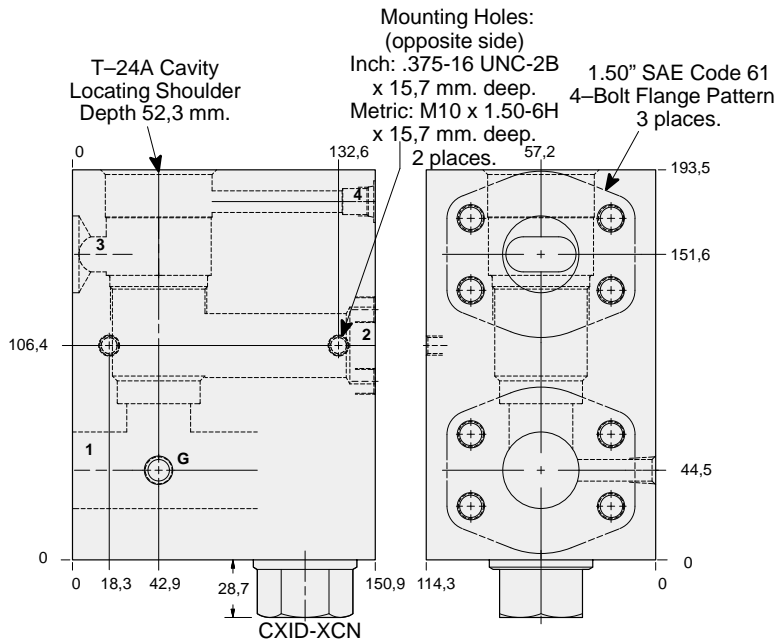

Mounting Hole Dimensions	Port 4	Gauge Port	ALUMINIUM		SG IRON	
			Model Code	List Price	Model Code	List Price
Inch	SAE-6	.25 NPTF	Q4R		Q4R/S	
Metric	.25 BSPP	.25 BSPP	Q4R/M		Q4R/T	

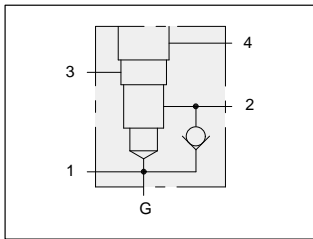

1.50" SAE Code 62 flange port body with high capacity port 3 reverse free flow check and gauge port for reducing/relieving applications.

TYPICAL CARTRIDGES USED WITH THIS BODY

- PVJA - *** Page 3.15
- PVJB - *** Page 3.17

Cartridge seal type determines check valve seal type.

Instructions for ordering complete cartridge and body assemblies. Page viii

Pressure ratings, material specifications. Page 11.02

SAE Specifications. Page 11.03

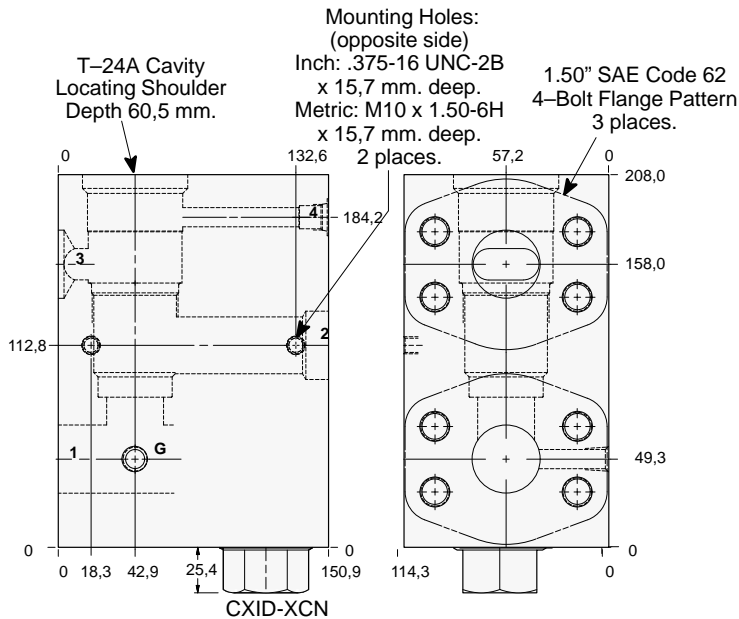

Mounting Hole Dimensions	Port 4	Gauge Port	ALUMINIUM		SG IRON	
			Model Code	List Price	Model Code	List Price
Inch	SAE-6	.25 NPTF	Q46		Q46/S	
Metric	.25 BSPP	.25 BSPP	Q46/M		Q46/T	

Series 4 T-24A



LINE MOUNT BODIES



- Aluminium rated to 210 bar and SG Iron rated to 350 bar.

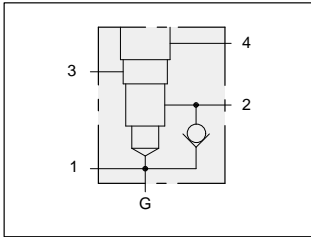

2.00" SAE Code 61 flange port body with high capacity port 3 reverse free flow check and gauge port for reducing/relieving applications.

TYPICAL CARTRIDGES USED WITH THIS BODY

PVJA - *** Page 3.15
 PVJB - *** Page 3.17

Cartridge seal type determines check valve seal type.

Instructions for ordering complete cartridge and body assemblies. Page viii

Pressure ratings, material specifications. Page 11.02

SAE Specifications. Page 11.03

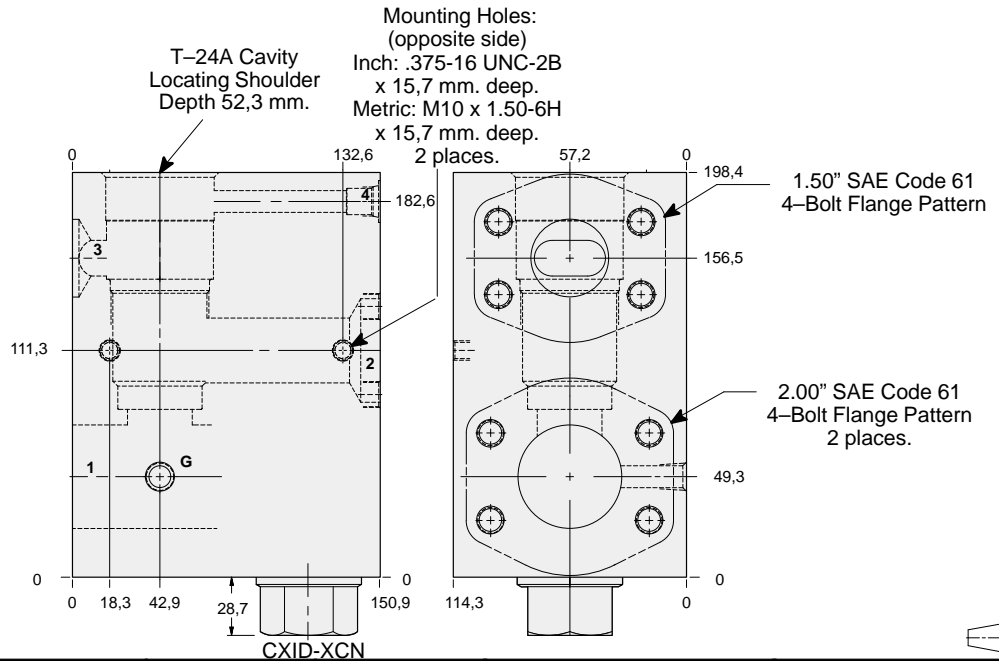

Mounting Hole Dimensions	Port 4	Gauge Port	ALUMINIUM		SG IRON	
			Model Code	List Price	Model Code	List Price
Inch	SAE-6	.25 NPTF	Q4S		Q4S/S	
Metric	.25 BSPP	.25 BSPP	Q4S/M		Q4S/T	

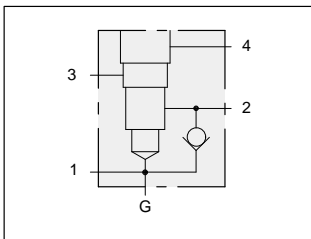

2.00" SAE Code 62 flange port body with high capacity port 3 reverse free flow check and gauge port for reducing/relieving applications.

TYPICAL CARTRIDGES USED WITH THIS BODY

PVJA - *** Page 3.15
 PVJB - *** Page 3.17

Cartridge seal type determines check valve seal type.

Instructions for ordering complete cartridge and body assemblies. Page viii

Pressure ratings, material specifications. Page 11.02

SAE Specifications. Page 11.03

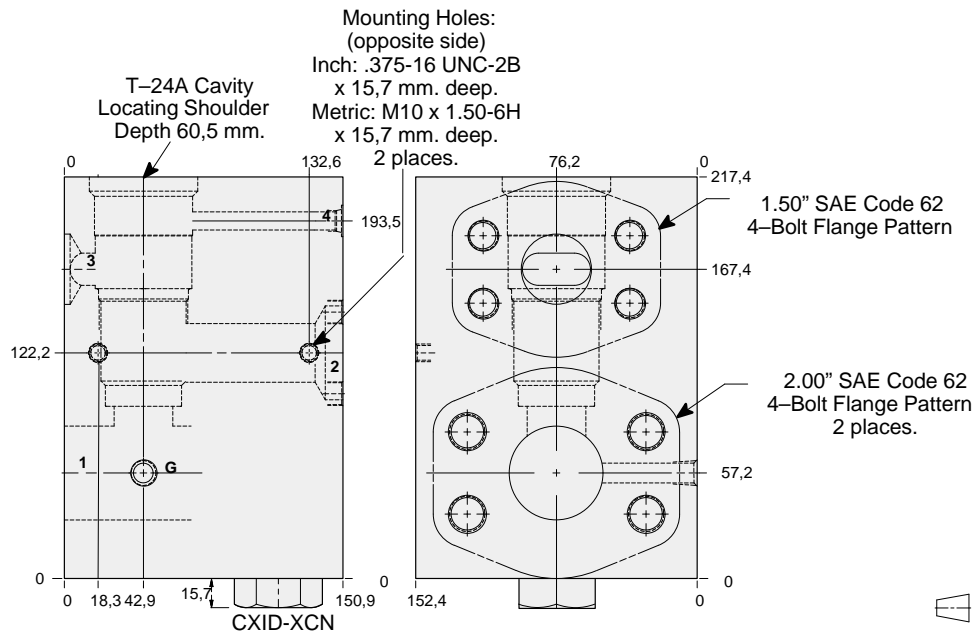

Mounting Hole Dimensions	Port 4	Gauge Port	ALUMINIUM		SG IRON	
			Model Code	List Price	Model Code	List Price
Inch	SAE-6	.25 NPTF	Q48		Q48/S	
Metric	.25 BSPP	.25 BSPP	Q48/M		Q48/T	

Series 4 T-24A



LINE MOUNT BODIES



- Aluminum rated to 210 bar and SG Iron rated to 350 bar.

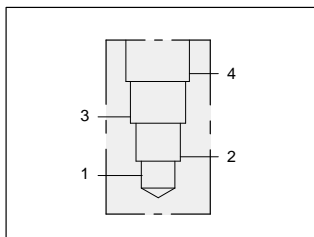

TYPICAL CARTRIDGES USED WITH THIS BODY

- FSDA - *** Page 7.10
- FSFA - *** Page 7.11
- FSFS - *** Page 7.13
- FSFH - *** Page 7.15
- DSIH - *** Page 10.07

Instructions for ordering complete cartridge and body assemblies. Page viii

Pressure ratings, material specifications. Page 11.02

Body for flow divider/combiner applications.

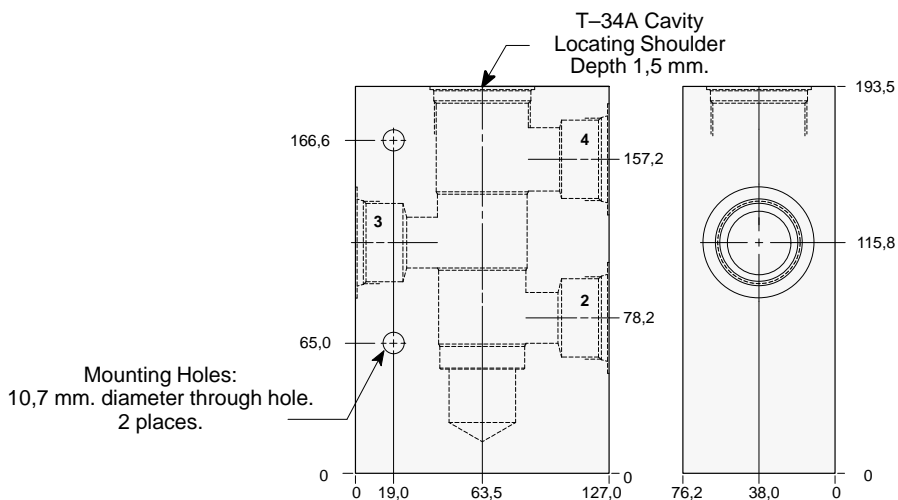

Ports 2, 3 & 4	ALUMINIUM		SG IRON	
	Model Code	List Price	Model Code	List Price
1.00 NPTF	QME		QME/S	
1.25 NPTF	QMF		QMF/S	
SAE-16	QMM		QMM/S	
SAE-20	QMN		QMN/S	
1.00 BSPP	QMX		QMX/S	
1.25 BSPP	QMY		QMY/S	

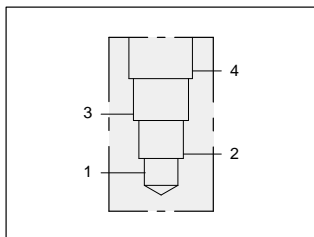

Four port body.

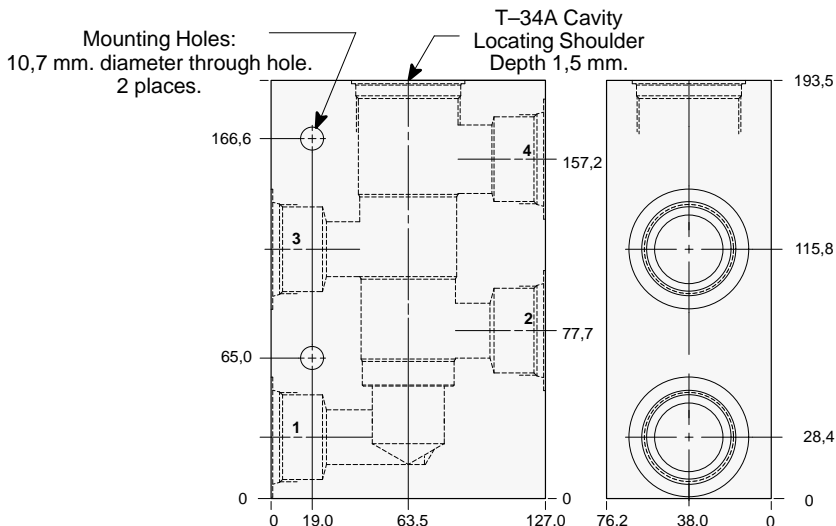

Ports 2, 3 & 4	ALUMINIUM		SG IRON	
	Model Code	List Price	Model Code	List Price
1.00 NPTF	QNE		QNE/S	
1.25 NPTF	QNF		QNF/S	
SAE-16	QNM		QNM/S	
SAE-20	QNN		QNN/S	
1.00 BSPP	QNX		QNX/S	
1.25 BSPP	QNY		QNY/S	



LINE MOUNT BODIES



- Aluminum rated to 210 bar and SG Iron rated to 350 bar.

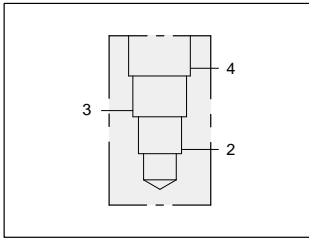

1.00" SAE Code 61 flange port body for flow divider/combiner applications.

Mounting Holes:
Inch: .375-16 UNC-2B x 15,7 mm. deep.
Metric: M10 x 1.50-6H x 15,7 mm. deep.
2 places.

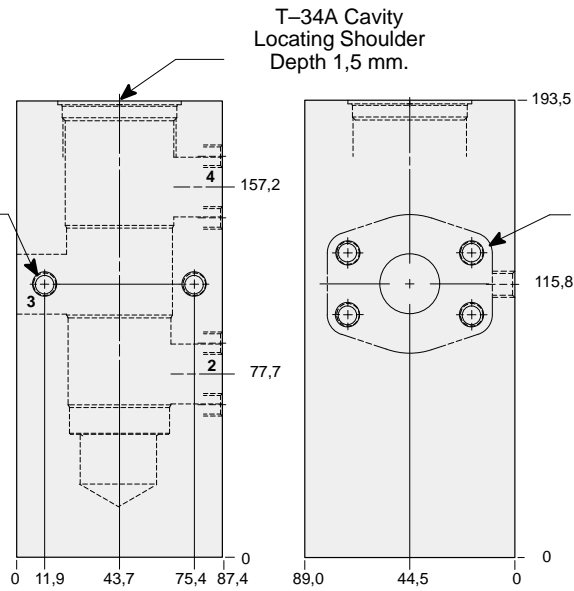

TYPICAL CARTRIDGES USED WITH THIS BODY

FSFD - ***	Page	7.09
FSFA - ***	Page	7.11
FSFS - ***	Page	7.13
FSFH - ***	Page	7.15
DSIH - ***	Page	10.07

Instructions for ordering complete cartridge and body assemblies. Page viii

Pressure ratings, material specifications. Page 11.02

SAE Specifications. Page 11.03

Mounting Hole Dimensions	ALUMINIUM		SG IRON	
	Model Code	List Price	Model Code	List Price
Inch	QMP		QMP/S	
Metric	QMP/M		QMP/T	

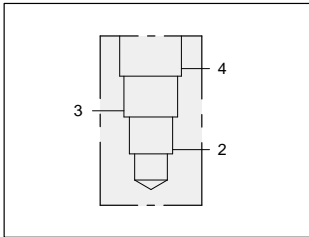

1.00" SAE Code 62 flange port body for flow divider/combiner applications.

Mounting Holes:
Inch: .375-16 UNC-2B x 15,7 mm. deep.
Metric: M10 x 1.50-6H x 15,7 mm. deep.
2 places.

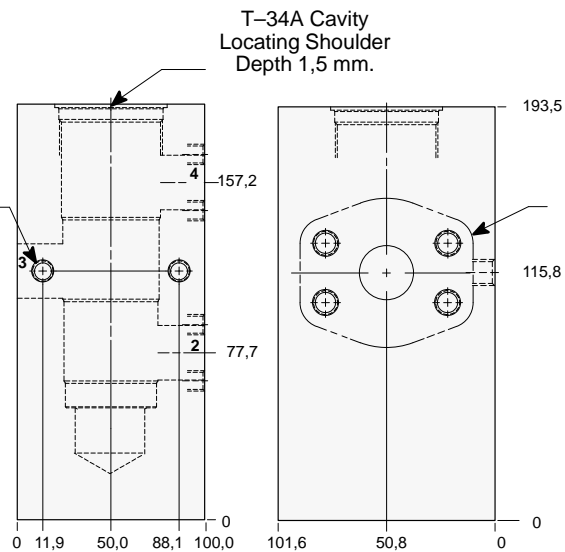

TYPICAL CARTRIDGES USED WITH THIS BODY

FSFD - ***	Page	7.09
FSFA - ***	Page	7.11
FSFS - ***	Page	7.13
FSFH - ***	Page	7.15
DSIH - ***	Page	10.07

Instructions for ordering complete cartridge and body assemblies. Page viii

Pressure ratings, material specifications. Page 11.02

SAE Specifications. Page 11.03

Mounting Hole Dimensions	ALUMINIUM		SG IRON	
	Model Code	List Price	Model Code	List Price
Inch	QM4		QM4/S	
Metric	QM4/M		QM4/T	

Series 4 T-24A



LINE MOUNT BODIES



- Aluminum rated to 210 bar and SG Iron rated to 350 bar.

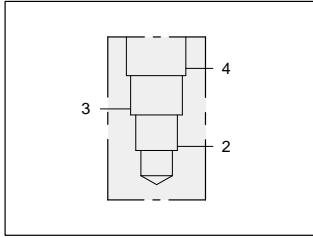

1.25" SAE Code 61 flange port body for flow divider/combiner applications.

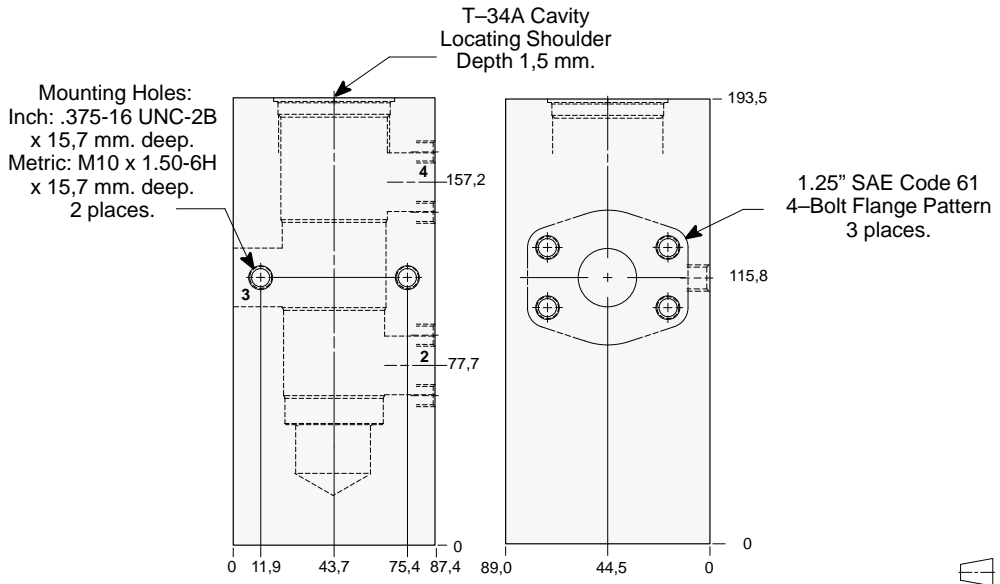

TYPICAL CARTRIDGES USED WITH THIS BODY

FSFD - ***	Page	7.09
FSFA - ***	Page	7.11
FSFS - ***	Page	7.13
FSFH - ***	Page	7.15
DSIH - ***	Page	10.07

Instructions for ordering complete cartridge and body assemblies. Page viii

Pressure ratings, material specifications. Page 11.02

SAE Specifications. Page 11.03

Mounting Hole Dimensions	ALUMINIUM		SG IRON	
	Model Code	List Price	Model Code	List Price
Inch	QM _Q		QM _{Q/S}	
Metric	QM _{Q/M}		QM _{Q/T}	

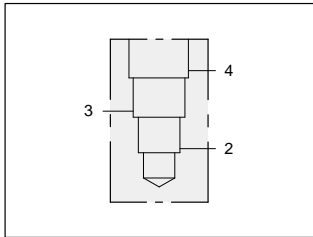

1.25" SAE Code 62 flange port body for flow divider/combiner applications.

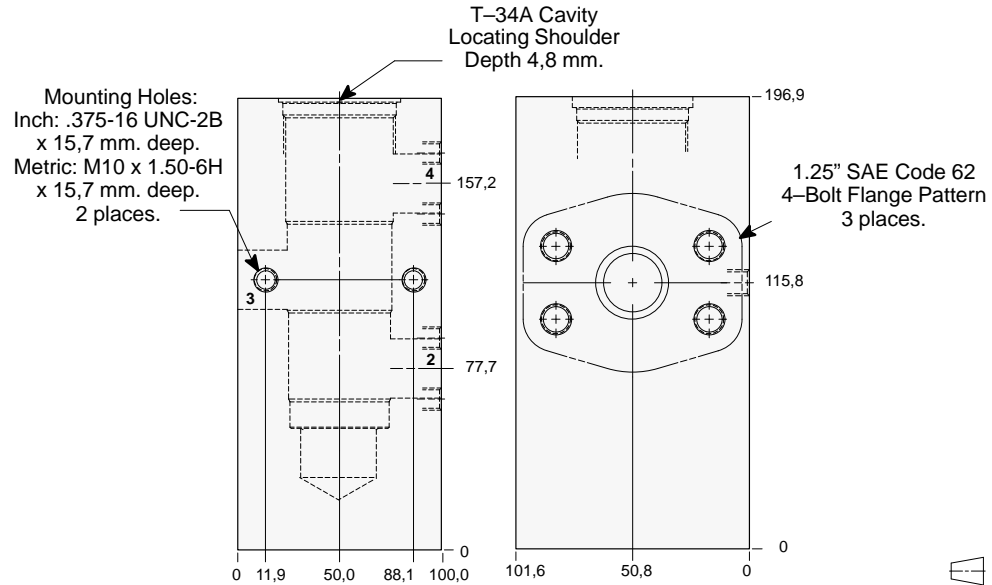

TYPICAL CARTRIDGES USED WITH THIS BODY

FSFD - ***	Page	7.09
FSFA - ***	Page	7.11
FSFS - ***	Page	7.13
FSFH - ***	Page	7.15
DSIH - ***	Page	10.07

Instructions for ordering complete cartridge and body assemblies. Page viii

Pressure ratings, material specifications. Page 11.02

SAE Specifications. Page 11.03

Mounting Hole Dimensions	ALUMINIUM		SG IRON	
	Model Code	List Price	Model Code	List Price
Inch	QM ₅		QM _{5/S}	
Metric	QM _{5/M}		QM _{5/T}	



LINE MOUNT BODIES



- Aluminum rated to 210 bar and SG Iron rated to 350 bar.

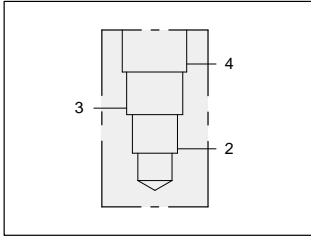

1.50" SAE Code 61 flange port body for flow divider/combiner applications.

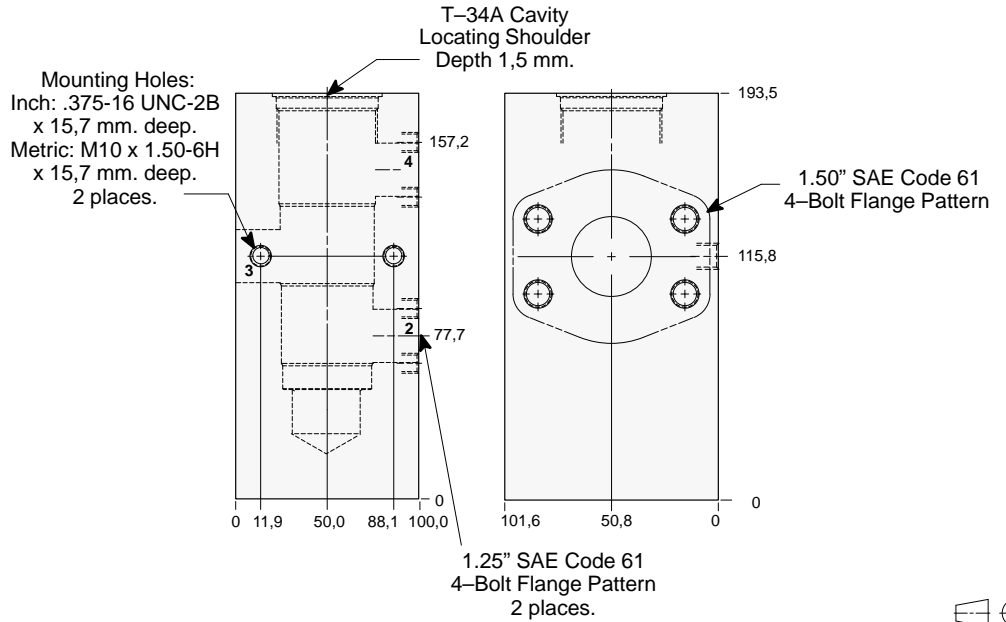

TYPICAL CARTRIDGES USED WITH THIS BODY

FSFD - ***	Page	7.09
FSFA - ***	Page	7.11
FSFS - ***	Page	7.13
FSFH - ***	Page	7.15
DSIH - ***	Page	10.07

Instructions for ordering complete cartridge and body assemblies. Page viii

Pressure ratings, material specifications. Page 11.02

SAE Specifications. Page 11.03

Mounting Hole Dimensions	ALUMINIUM		SG IRON	
	Model Code	List Price	Model Code	List Price
Inch	QMR		QMR/S	
Metric	QMR/M		QMR/T	

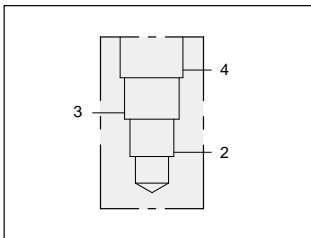

1.50" SAE Code 62 flange port body for flow divider/combiner applications.

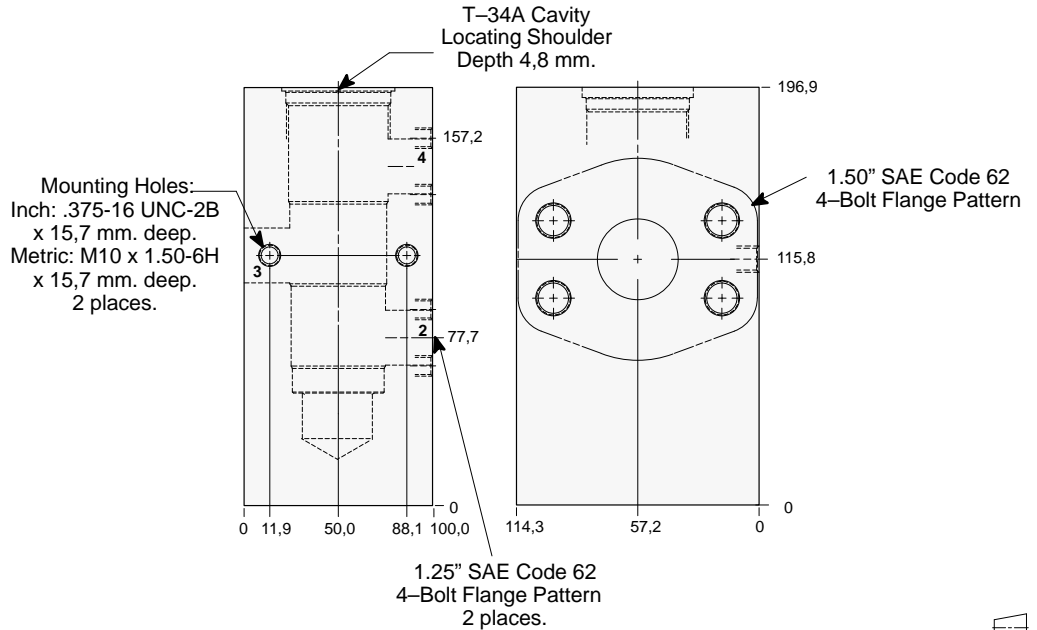

TYPICAL CARTRIDGES USED WITH THIS BODY

FSFD - ***	Page	7.09
FSFA - ***	Page	7.11
FSFS - ***	Page	7.13
FSFH - ***	Page	7.15
DSIH - ***	Page	10.07

Instructions for ordering complete cartridge and body assemblies. Page viii

Pressure ratings, material specifications. Page 11.02

SAE Specifications. Page 11.03

Mounting Hole Dimensions	ALUMINIUM		SG IRON	
	Model Code	List Price	Model Code	List Price
Inch	QM6		QM6/S	
Metric	QM6/M		QM6/T	

Series 4 T-24A