

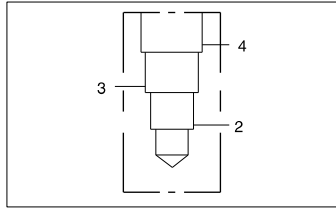

# LINE MOUNT BODIES



- Aluminum rated to 3000 psi.
- Ductile Iron rated to 5000 psi.



### TYPICAL CARTRIDGES USED WITH THIS BODY

FSBD - ***	Page 7.08
FSCD - ***	Page 7.08
FSBA - ***	Page 7.10
FSCA - ***	Page 7.10
FSBS - ***	Page 7.12
FSCS - ***	Page 7.12
FSCH - ***	Page 7.14
DSCH - ***	Page 10.06

Instructions for ordering complete cartridge and body assemblies. Page v

Pressure ratings, material specifications. Page 11.02

### Body for flow divider/combiner applications.

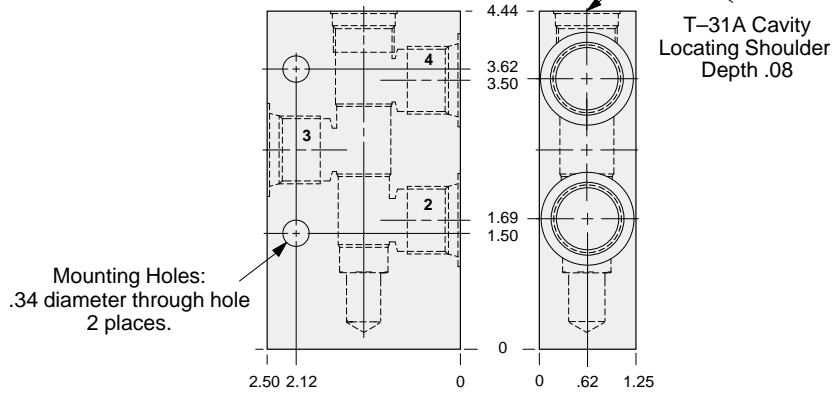

Ports 2, 3, & 4	ALUMINUM		DUCTILE IRON	
	Part Number	List Price	Part Number	List Price
.25 NPTF	MMA		MMA/S	
.375 NPTF	MMB		MMB/S	
.50 NPTF	MMC		MMC/S	
SAE-6	MMI		MMI/S	
SAE-8	MMJ		MMJ/S	
SAE-10	MMK		MMK/S	
.25 BSPP	MMT		MMT/S	
.375 BSPP	MMU		MMU/S	
.50 BSPP	MMV		MMV/S	

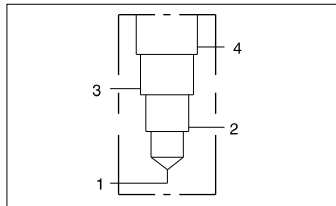

Instructions for ordering complete cartridge and body assemblies. Page v

Pressure ratings, material specifications. Page 11.02

### Four port body.

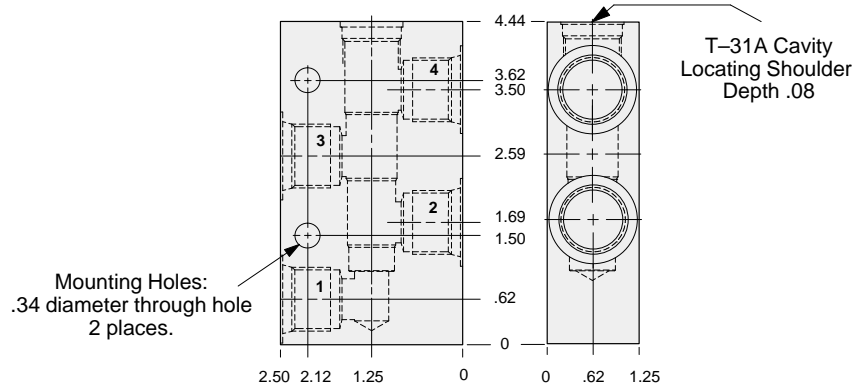

Ports 2, 3, & 4	ALUMINUM		DUCTILE IRON	
	Part Number	List Price	Part Number	List Price
.25 NPTF	MNA		MNA/S	
.375 NPTF	MNB		MNB/S	
.50 NPTF	MNC		MNC/S	
SAE-6	MNI		MNI/S	
SAE-8	MNJ		MNJ/S	
SAE-10	MNK		MNK/S	
.25 BSPP	MNT		MNT/S	
.375 BSPP	MNU		MNU/S	
.50 BSPP	MNV		MNV/S	

S1  
T31A