



LINE MOUNT BODIES



- Aluminum rated to 3000 psi.
- Ductile Iron rated to 5000 psi.

S2
T2A

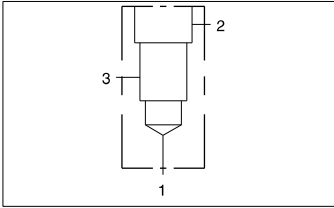

90 degree body.

Mounting Holes:
.42 diameter through hole.
2 places.

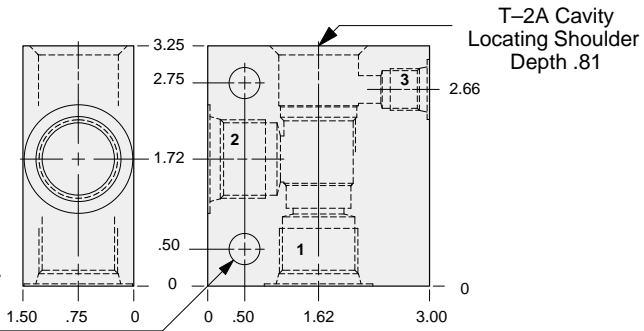

TYPICAL CARTRIDGES USED WITH THIS BODY

RVEA - ***	Page 1.18
RSFC - ***	Page 2.06
SQFB - ***	Page 2.08
RSFE - ***	Page 2.10
SCEA - ***	Page 2.12
PBFB - ***	Page 3.06
PBFC - ***	Page 3.08
CBEA - ***	Page 4.10
CBEG - ***	Page 4.12
CBEH - ***	Page 4.14
CKEB - ***	Page 4.16
LOFC - ***	Page 9.08
LKFC - ***	Page 9.10
LPFC - ***	Page 9.12
LRFC - ***	Page 9.14
COFA - ***	Page 10.12

Instructions for ordering complete cartridge and body assemblies. Page v

Pressure ratings, material specifications. Page 11.02

Ports 1 & 2	Port 3	ALUMINUM		DUCTILE IRON	
		Part Number	List Price	Part Number	List Price
.25 NPTF	.25 NPTF	BCA		BCA/S	
.375 NPTF	.25 NPTF	BCB		BCB/S	
.50 NPTF	.25 NPTF	BCC		BCC/S	
.75 NPTF	.25 NPTF	BCD		BCD/S	
SAE-6	SAE-6	BCI		BCI/S	
SAE-8	SAE-6	BCJ		BCJ/S	
SAE-10	SAE-6	BCK		BCK/S	
SAE-12	SAE-6	BCL		BCL/S	
.25 BSPP	.25 BSPP	BCT		BCT/S	
.375 BSPP	.25 BSPP	BCU		BCU/S	
.50 BSPP	.25 BSPP	BCV		BCV/S	
.75 BSPP	.25 BSPP	BCW		BCW/S	

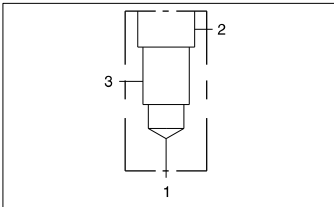

90 degree body with high capacity port 3.

Mounting Holes:
.42 diameter through hole.
2 places.

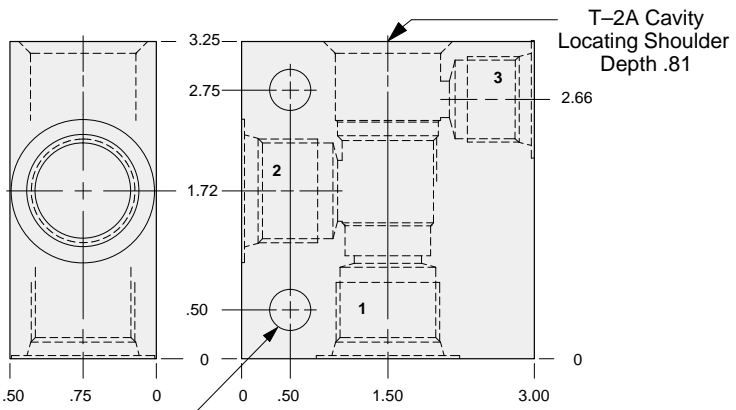

TYPICAL CARTRIDGES USED WITH THIS BODY

PPFB - ***	Page 3.10
PPFC - ***	Page 3.12
DPCA - ***	Page 6.02
DPCB - ***	Page 8.06
DPCC - ***	Page 8.07
DPCD - ***	Page 8.08
FRDA - ***	Page 8.09

Instructions for ordering complete cartridge and body assemblies. Page v

Pressure ratings, material specifications. Page 11.02

Ports 1 & 2	Port 3	ALUMINUM		DUCTILE IRON	
		Part Number	List Price	Part Number	List Price
.375 NPTF	.375 NPTF	BAB		BAB/S	
.50 NPTF	.50 NPTF	BAC		BAC/S	
.75 NPTF	.50 NPTF	BAD		BAD/S	
SAE-8	SAE-8	BAJ		BAJ/S	
SAE-10	SAE-10	BAK		BAK/S	
SAE-12	SAE-10	BAL		BAL/S	
.375 BSPP	.375 BSPP	BAU		BAU/S	
.50 BSPP	.50 BSPP	BAV		BAV/S	
.75 BSPP	.50 BSPP	BAW		BAW/S	



LINE MOUNT BODIES



- Aluminum rated to 3000 psi.
- Ductile Iron rated to 5000 psi.

S2
T2A

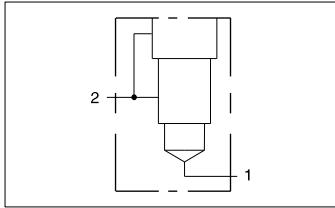

Body with port 3 connected to port 2.

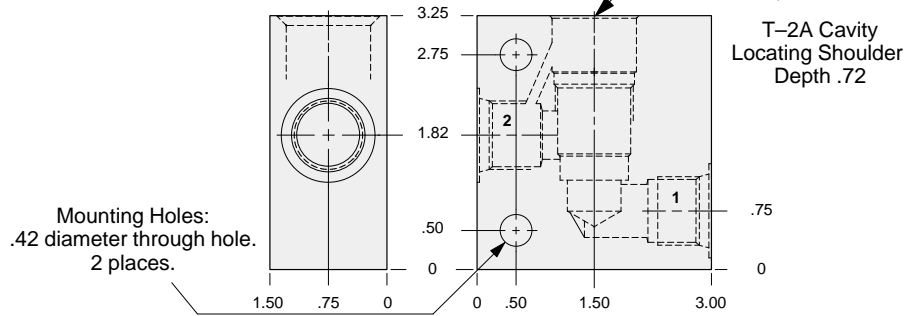

TYPICAL CARTRIDGES USED WITH THIS BODY

- CBEA - *** Page 4.10
 CBEG - *** Page 4.12
 CBEH - *** Page 4.14

Instructions for ordering complete cartridge and body assemblies. Page v

Pressure ratings, material specifications. Page 11.02

All Ports	ALUMINUM		DUCTILE IRON	
	Part Number	List Price	Part Number	List Price
.25 NPTF	BDA		BDA/S	
.375 NPTF	BDB		BDB/S	
.50 NPTF	BDC		BDC/S	
.75 NPTF	BDD		BDD/S	
SAE-6	BDI		BDI/S	
SAE-8	BDJ		BDJ/S	
SAE-10	BDK		BDK/S	
.25 BSPP	BDT		BDT/S	
.375 BSPP	BDU		BDU/S	
.50 BSPP	BDV		BDV/S	
.75 BSPP	BDW		BDW/S	



LINE MOUNT BODIES



- Aluminum rated to 3000 psi.
- Ductile Iron rated to 5000 psi.

S2
T2A

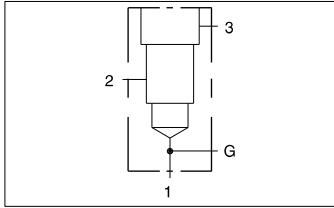

90 degree body with gage port.

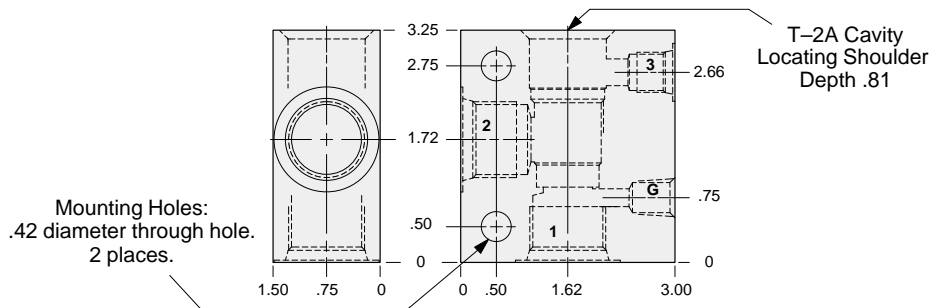

TYPICAL CARTRIDGES USED WITH THIS BODY

RVEA - ***	Page 1.18
RSFC - ***	Page 2.06
SQFB - ***	Page 2.08
RSFE - ***	Page 2.10
SCEA - ***	Page 2.12
PBFB - ***	Page 3.06
PBFC - ***	Page 3.08
LOFC - ***	Page 9.08
LKFC - ***	Page 9.10
LPFC - ***	Page 9.12
LRFC - ***	Page 9.14
COFA - ***	Page 10.12

Instructions for ordering complete cartridge and body assemblies. Page v

Pressure ratings, material specifications. Page 11.02

Ports 1 & 2	Port 3	Gage Port	ALUMINUM		DUCTILE IRON	
			Part Number	List Price	Part Number	List Price
.25 NPTF	.25 NPTF	.25 NPTF	BFA		BFA/S	
.375 NPTF	.25 NPTF	.25 NPTF	BFB		BFB/S	
.50 NPTF	.25 NPTF	.25 NPTF	BFC		BFC/S	
.75 NPTF	.25 NPTF	.25 NPTF	BFD		BFD/S	
SAE-6	SAE-6	.25 NPTF	BFI		BFI/S	
SAE-8	SAE-6	.25 NPTF	BFJ		BFJ/S	
SAE-10	SAE-6	.25 NPTF	BFK		BFK/S	
SAE-12	SAE-6	.25 NPTF	BFL		BFL/S	
.25 BSPP	.25 BSPP	.25 BSPP	BFT		BFT/S	
.375 BSPP	.25 BSPP	.25 BSPP	BFU		BFU/S	
.50 BSPP	.25 BSPP	.25 BSPP	BFV		BFV/S	
.75 BSPP	.25 BSPP	.25 BSPP	BFW		BFW/S	

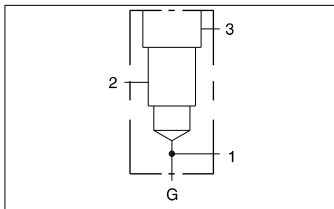

90 degree body with high capacity port 3 and gage port.

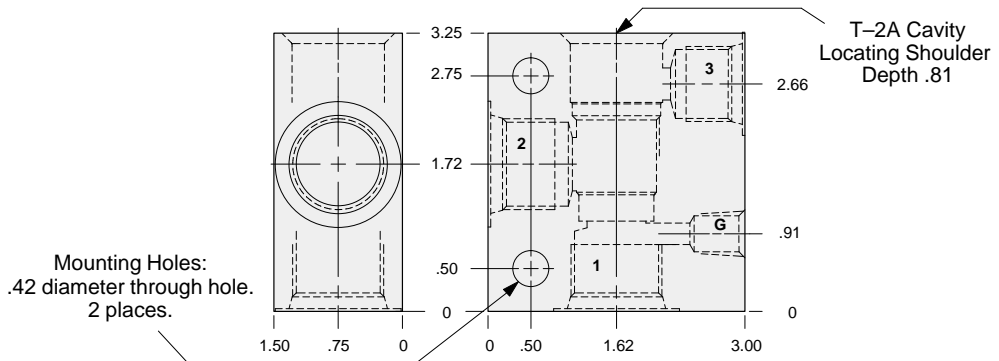

TYPICAL CARTRIDGES USED WITH THIS BODY

PPFB - ***	Page 3.10
PPFC - ***	Page 3.12
DPCA - ***	Page 8.06
DPCB - ***	Page 8.07
DPCD - ***	Page 8.08
DPCD - ***	Page 8.09

Instructions for ordering complete cartridge and body assemblies. Page v

Pressure ratings, material specifications. Page 11.02

Ports 1 & 2	Port 3	Gage Port	ALUMINUM		DUCTILE IRON	
			Part Number	List Price	Part Number	List Price
.375 NPTF	.375 NPTF	.25 NPTF	BLB		BLB/S	
.50 NPTF	.50 NPTF	.25 NPTF	BLC		BLC/S	
.75 NPTF	.50 NPTF	.25 NPTF	BLD		BLD/S	
SAE-6	SAE-6	.25 NPTF	BLI		BLI/S	
SAE-8	SAE-8	.25 NPTF	BLJ		BLJ/S	
SAE-10	SAE-10	.25 NPTF	BLK		BLK/S	
SAE-12	SAE-10	.25 NPTF	BLL		BLL/S	
.375 BSPP	.375 BSPP	.25 BSPP	BLU		BLU/S	
.50 BSPP	.50 BSPP	.25 BSPP	BLV		BLV/S	
.75 BSPP	.50 BSPP	.25 BSPP	BLW		BLW/S	



LINE MOUNT BODIES



- Aluminum rated to 3000 psi.
- Ductile Iron rated to 5000 psi.

S2
T2A

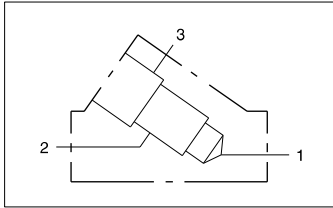

Inline body.

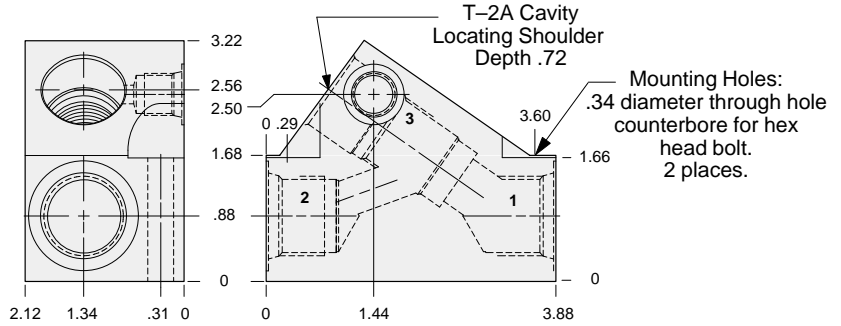

TYPICAL CARTRIDGES USED WITH THIS BODY

RVEA - ***	Page 1.18
RSFC - ***	Page 2.06
SQFB - ***	Page 2.08
RSFE - ***	Page 2.10
SCEA - ***	Page 2.12
PBFB - ***	Page 3.06
PBFC - ***	Page 3.08
CBEA - ***	Page 4.10
CBEG - ***	Page 4.12
CBEH - ***	Page 4.14
CKEB - ***	Page 4.16
LOFC - ***	Page 9.08
LKFC - ***	Page 9.10
LPFC - ***	Page 9.12
LRFC - ***	Page 9.14
COFA - ***	Page 10.12

Instructions for ordering complete cartridge and body assemblies. Page v

Pressure ratings, material specifications. Page 11.02

Ports 1 & 2	Port 3	ALUMINUM		DUCTILE IRON	
		Part Number	List Price	Part Number	List Price
.25 NPTF	.25 NPTF	BVA		BVA/S	
.375 NPTF	.25 NPTF	BVB		BVB/S	
.50 NPTF	.25 NPTF	BVC		BVC/S	
.75 NPTF	.25 NPTF	BVD		BVD/S	
SAE-6	SAE-6	BVI		BVI/S	
SAE-8	SAE-6	BVJ		BVJ/S	
SAE-10	SAE-6	BVK		BVK/S	
SAE-12	SAE-6	BVL		BVL/S	
.25 BSPP	.25 BSPP	BVT		BVT/S	
.375 BSPP	.25 BSPP	BVU		BVU/S	
.50 BSPP	.25 BSPP	BVV		BVV/S	
.75 BSPP	.25 BSPP	BVW		BVW/S	

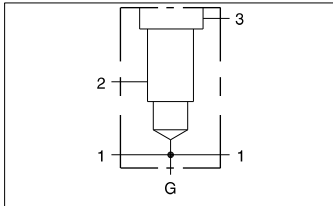

Through port body with gage port.

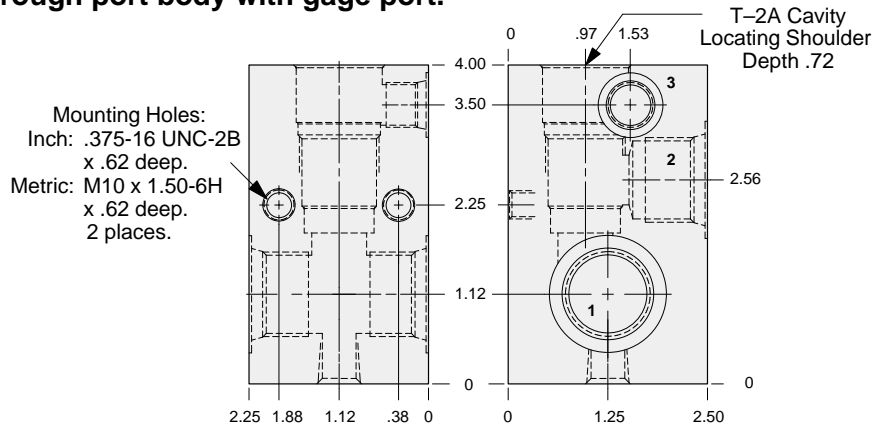

TYPICAL CARTRIDGES USED WITH THIS BODY

RVEA - ***	Page 1.18
RSFC - ***	Page 2.06
SQFB - ***	Page 2.08
RSFE - ***	Page 2.10
SCEA - ***	Page 2.12
PBFB - ***	Page 3.06
PBFC - ***	Page 3.08

Instructions for ordering complete cartridge and body assemblies. Page v

Pressure ratings, material specifications. Page 11.02

Mounting Hole Dimensions	Ports 1 & 2	Port 3	Gage Port	ALUMINUM		DUCTILE IRON	
				Part Number	List Price	Part Number	List Price
Inch	.375 NPTF	.25 NPTF	.25 NPTF	BHB		BHB/S	
Inch	.50 NPTF	.25 NPTF	.25 NPTF	BHC		BHC/S	
Inch	.75 NPTF	.25 NPTF	.25 NPTF	BHD		BHD/S	
Inch	SAE-8	SAE-6	.25 NPTF	BHJ		BHJ/S	
Inch	SAE-10	SAE-6	.25 NPTF	BHK		BHK/S	
Inch	SAE-12	SAE-6	.25 NPTF	BHL		BHL/S	
Metric	.375 BSPP	.25 BSPP	.25 BSPP	BHU		BHU/S	
Metric	.50 BSPP	.25 BSPP	.25 BSPP	BHV		BHV/S	
Metric	.75 BSPP	.25 BSPP	.25 BSPP	BHW		BHW/S	



LINE MOUNT BODIES



- Aluminum rated to 3000 psi.
- Ductile Iron rated to 5000 psi.

S2
T2A

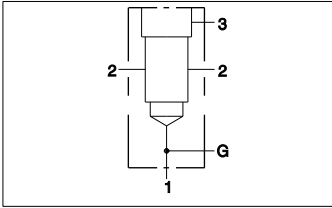

TYPICAL CARTRIDGES USED WITH THIS BODY

PBFB - *** Page 3.06
 PBFC - *** Page 3.08

Instructions for ordering complete cartridge and body assemblies. Page v

Pressure ratings, material specifications. Page 11.02

Through port body with gage port.

Mounting Holes:
 (opposite side)
 Inch: .375-16 UNC-2B
 x .62 deep.
 Metric: M10 x 1.50-6H
 x .62 deep.
 2 places.

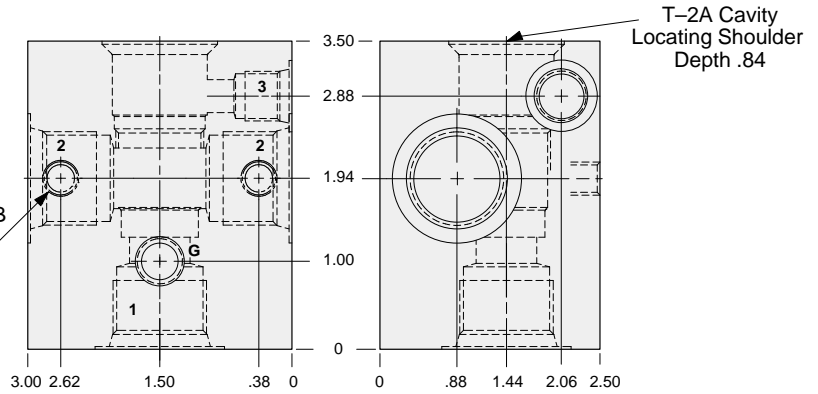

Mounting Hole Dimensions	Ports 1 & 2	Port 3	Gage Port	ALUMINUM		DUCTILE IRON	
				Part Number	List Price	Part Number	List Price
Inch	.375 NPTF	.25 NPTF	.25 NPTF	WSE		WSE/S	
Inch	.50 NPTF	.25 NPTF	.25 NPTF	WSF		WSF/S	
Inch	.75 NPTF	.25 NPTF	.25 NPTF	WSG		WSG/S	
Inch	SAE-8	SAE-6	.25 NPTF	WSH		WSH/S	
Inch	SAE-10	SAE-6	.25 NPTF	WSI		WSI/S	
Inch	SAE-12	SAE-6	.25 NPTF	WSJ		WSJ/S	
Metric	.375 BSPP	.25 BSPP	.25 BSPP	WSK		WSK/S	
Metric	.50 BSPP	.25 BSPP	.25 BSPP	WSL		WSL/S	
Metric	.75 BSPP	.25 BSPP	.25 BSPP	WSM		WSM/S	

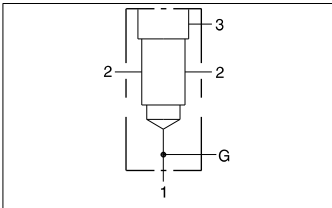

TYPICAL CARTRIDGES USED WITH THIS BODY

PPFB - *** Page 3.10
 PPFC - *** Page 3.12
 DPCA - *** Page 8.06
 DPCB - *** Page 8.07
 DPCC - *** Page 8.08
 DPCD - *** Page 8.09

Instructions for ordering complete cartridge and body assemblies. Page v

Pressure ratings, material specifications. Page 11.02

Through port body with high capacity port 3 and gage port.

Mounting Holes:
 (opposite side)
 Inch: .375-16 UNC-2B
 x .62 deep.
 Metric: M10 x 1.50-6H
 x .62 deep.
 2 places.

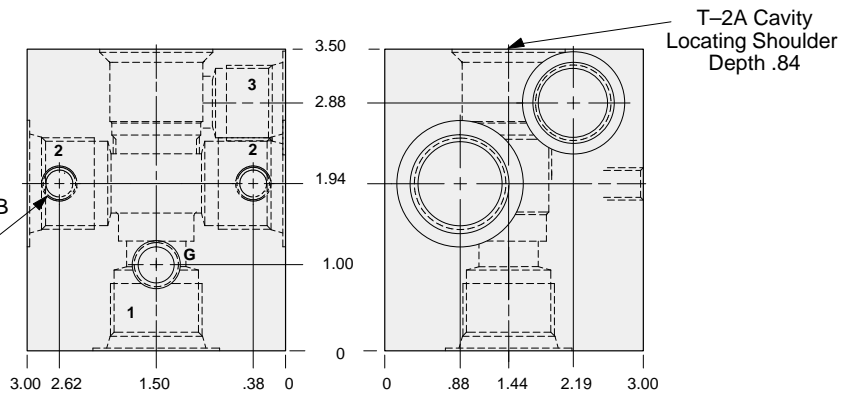

Mounting Hole Dimensions	Ports 1 & 2	Port 3	Gage Port	ALUMINUM		DUCTILE IRON	
				Part Number	List Price	Part Number	List Price
Inch	.375 NPTF	.375 NPTF	.25 NPTF	WSN		WSN/S	
Inch	.50 NPTF	.50 NPTF	.25 NPTF	WSO		WSO/S	
Inch	.75 NPTF	.50 NPTF	.25 NPTF	WSP		WSP/S	
Inch	SAE-8	SAE-8	.25 NPTF	WSQ		WSQ/S	
Inch	SAE-10	SAE-10	.25 NPTF	WSR		WSR/S	
Inch	SAE-12	SAE-10	.25 NPTF	WSS		WSS/S	
Metric	.375 BSPP	.375 BSPP	.25 BSPP	WST		WST/S	
Metric	.50 BSPP	.50 BSPP	.25 BSPP	WSU		WSU/S	
Metric	.75 BSPP	.50 BSPP	.25 BSPP	WSV		WSV/S	



LINE MOUNT BODIES



- Aluminum rated to 3000 psi.
- Ductile Iron rated to 5000 psi.

S2
T2A

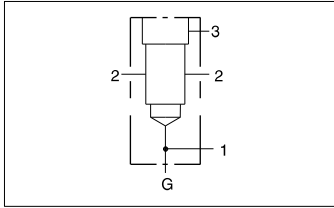

Sandwich mount through port 1.00" SAE Code 61 body with gage port.

TYPICAL CARTRIDGES USED WITH THIS BODY

- RVEA - *** Page 1.18
- RSFC - *** Page 2.06
- SQFB - *** Page 2.08
- RSFE - *** Page 2.10
- SCEA - *** Page 2.12

Cartridge seal type determines O-ring type.

Instructions for ordering complete cartridge and body assemblies. Page v

Pressure ratings, material specifications. Page 11.02

SAE Specifications Page 11.03

1.00" SAE Code 61
4-Bolt Flange Pattern
2 places.

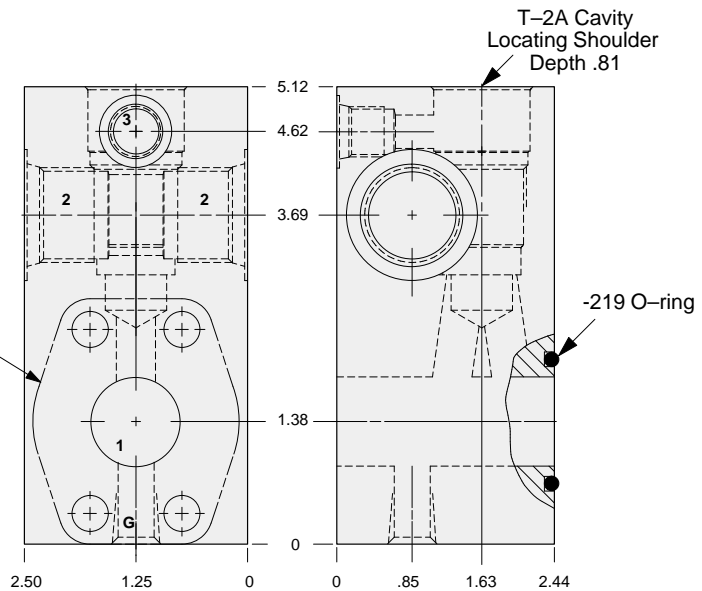

Mounting Hole Dimensions	Port 2	Port 3	Gage Port	ALUMINUM		DUCTILE IRON	
				Part Number	List Price	Part Number	List Price
Inch	.75 NPTF	.25 NPTF	.25 NPTF	ZMN		ZMN/S	
Inch	SAE-12	SAE-6	.25 NPTF	ZMP		ZMP/S	
Metric	.75 BSPP	.25 BSPP	.25 BSPP	ZMR/M		ZMR/T	

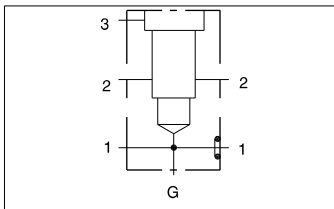

Sandwich mount through port 1.00" SAE Code 62 body with gage port.

TYPICAL CARTRIDGES USED WITH THIS BODY

- RVEA - *** Page 1.18
- RSFC - *** Page 2.06
- SQFB - *** Page 2.08
- RSFE - *** Page 2.10
- SCEA - *** Page 2.12

Cartridge seal type determines O-ring type.

Instructions for ordering complete cartridge and body assemblies. Page v

Pressure ratings, material specifications. Page 11.02

SAE Specifications Page 11.03

1.00" SAE Code 62
4-Bolt Flange Pattern
2 places.

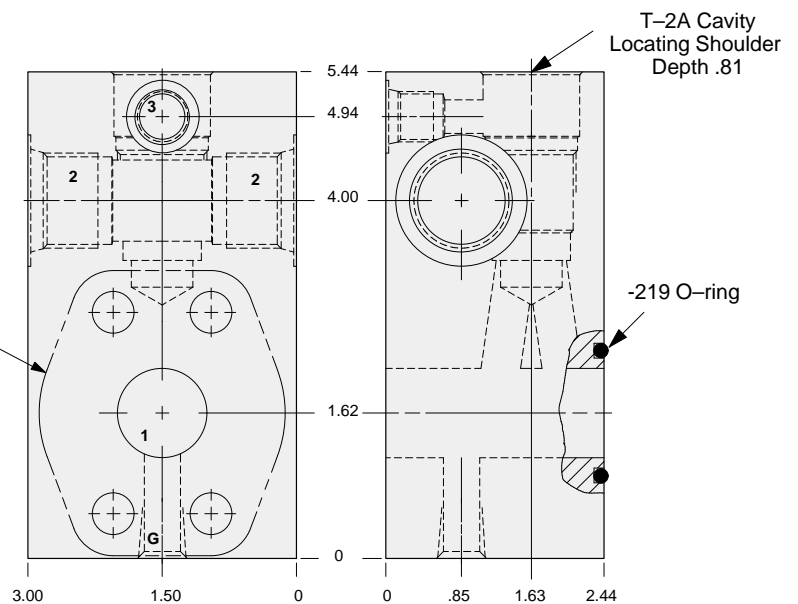

Mounting Hole Dimensions	Port 2	Port 3	Gage Port	ALUMINUM		DUCTILE IRON	
				Part Number	List Price	Part Number	List Price
Inch	SAE-12	SAE-6	.25 NPTF	WYG		WYG/S	
Inch	.75 NPTF	.25 NPTF	.25 NPTF	WYH		WYH/S	
Metric	.75 BSPP	.25 BSPP	.25 BSPP	WYF/M		WYF/T	



LINE MOUNT BODIES



- Aluminum rated to 3000 psi.
- Ductile Iron rated to 5000 psi.

S2
T2A

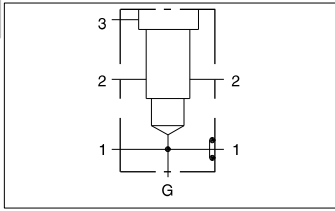

Flange mount through port 1.00" SAE Code 61 body with threaded outlet and gage port.

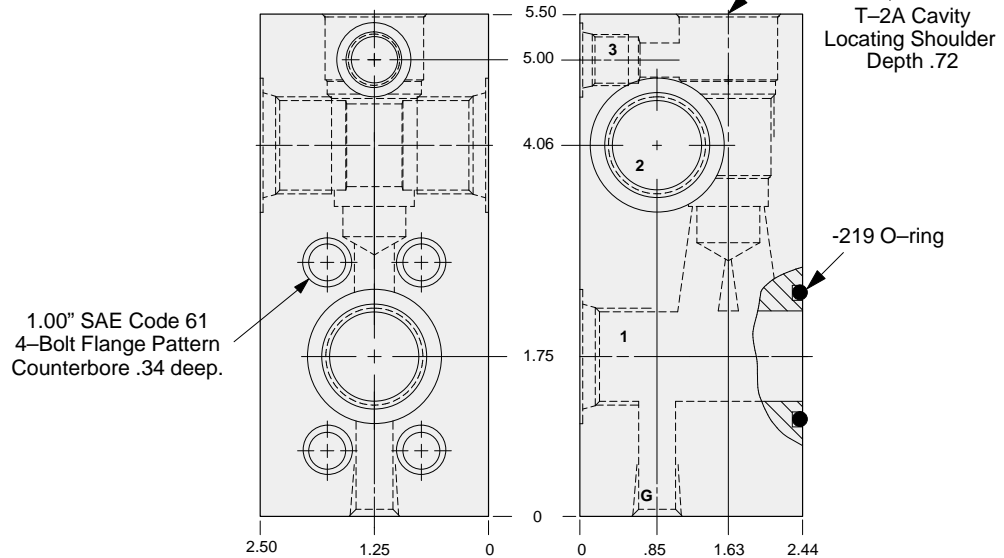

TYPICAL CARTRIDGES USED WITH THIS BODY

RVEA - ***	Page 1.18
RSFC - ***	Page 2.06
SQFB - ***	Page 2.08
RSFE - ***	Page 2.10
SCEA - ***	Page 2.12

Cartridge seal type determines O-ring type.

Instructions for ordering complete cartridge and body assemblies. Page v

Pressure ratings, material specifications. Page 11.02

SAE Specifications Page 11.03

Mounting Hole Dimensions	Ports 1 & 2	Port 3	Gage Port	ALUMINUM		DUCTILE IRON	
				Part Number	List Price	Part Number	List Price
Inch	.75 NPTF	.25 NPTF	.25 NPTF	WYW		WYW/S	
Inch	SAE-12	SAE-6	.25 NPTF	WYV		WYV/S	
Metric	.75 BSPP	.25 BSPP	.25 BSPP	WYU/M		WYU/T	

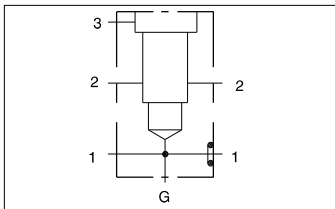

Flange mount through port 1.00" SAE Code 62 body with threaded outlet and gage port.

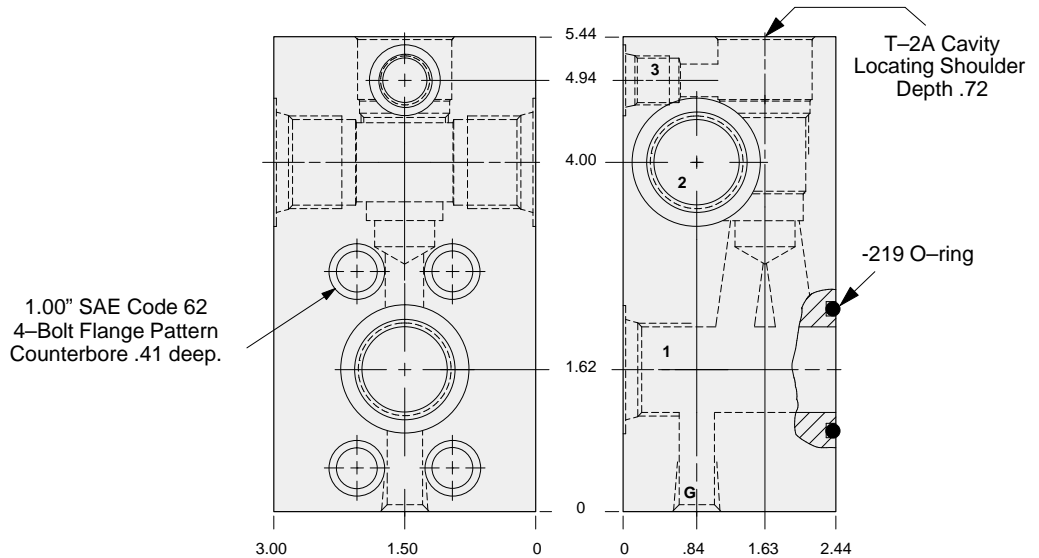

TYPICAL CARTRIDGES USED WITH THIS BODY

RVEA - ***	Page 1.18
RSFC - ***	Page 2.06
SQFB - ***	Page 2.08

Cartridge seal type determines O-ring type.

Instructions for ordering complete cartridge and body assemblies. Page v

Pressure ratings, material specifications. Page 11.02

SAE Specifications Page 11.03

Mounting Hole Dimensions	Ports 1 & 2	Port 3	Gage Port	ALUMINUM		DUCTILE IRON	
				Part Number	List Price	Part Number	List Price
Inch	.75 NPTF	.25 NPTF	.25 NPTF	WYE		WYE/S	
Inch	SAE-12	SAE-6	.25 NPTF	WYD		WYD/S	
Metric	.75 BSPP	.25 BSPP	.25 BSPP	WYC/M		WYC/T	



LINE MOUNT BODIES

- Aluminum rated to 3000 psi.
- Ductile Iron rated to 5000 psi.



S2
T2A

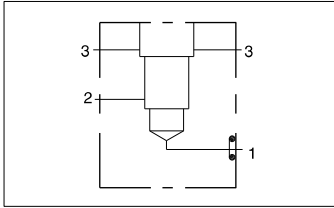

Direct mount .75" SAE Code 61 body with through pilot/drain port.

.75" SAE Code 61
4-Bolt Flange Pattern
2 places.
2 holes tapped
4 holes through

T-2A Cavity
Locating Shoulder
Depth .88

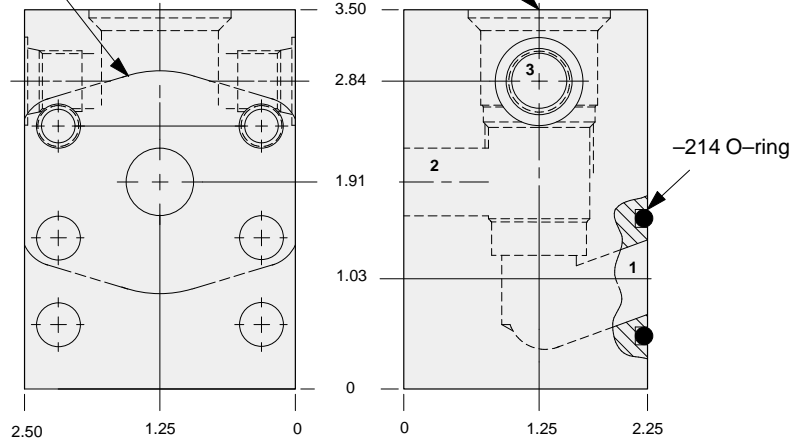

TYPICAL CARTRIDGES USED WITH THIS BODY

RVEA - ***	Page 1.18
RSFC - ***	Page 2.06
SQFB - ***	Page 2.08
RSFE - ***	Page 2.10
SCEA - ***	Page 2.12
CBEA - ***	Page 4.10
CBEG - ***	Page 4.12
CBEH - ***	Page 4.14
CKEB - ***	Page 4.16
LOFC - ***	Page 9.08
LKFC - ***	Page 9.10
LPFC - ***	Page 9.12
LRFC - ***	Page 9.14
COFA - ***	Page 10.12

Cartridge seal type determines O-ring type.

Instructions for ordering complete cartridge and body assemblies. Page v

Pressure ratings, material specifications. Page 11.02

SAE Specifications Page 11.03

Mounting Hole Dimensions	Port 3	ALUMINUM		DUCTILE IRON	
		Part Number	List Price	Part Number	List Price
Inch	SAE-6	ZNV		ZNV/S	
Metric	.25 BSPP	ZNV/M		ZNV/T	

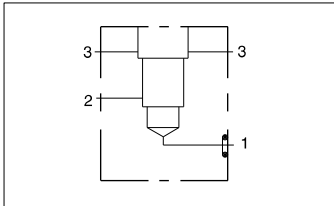

Direct mount .75" SAE Code 62 body with through pilot/drain port.

.75" SAE Code 62
4-Bolt Flange Pattern
2 places.
2 holes tapped
4 holes through

T-2A Cavity
Locating Shoulder
Depth .72

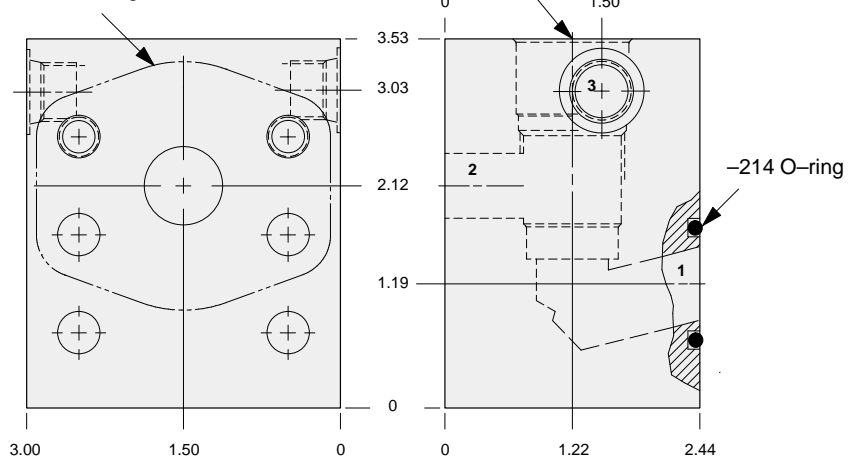

TYPICAL CARTRIDGES USED WITH THIS BODY

RVEA - ***	Page 1.18
RSFC - ***	Page 2.06
SQFB - ***	Page 2.08
RSFE - ***	Page 2.10
SCEA - ***	Page 2.12
CBEA - ***	Page 4.10
CBEG - ***	Page 4.12
CBEH - ***	Page 4.14
CKEB - ***	Page 4.16
LOFC - ***	Page 9.08
LKFC - ***	Page 9.10
LPFC - ***	Page 9.12
LRFC - ***	Page 9.14
COFA - ***	Page 10.12

Cartridge seal type determines O-ring type.

Instructions for ordering complete cartridge and body assemblies. Page v

Pressure ratings, material specifications. Page 11.02

SAE Specifications Page 11.03

Mounting Hole Dimensions	Port 3	ALUMINUM		DUCTILE IRON	
		Part Number	List Price	Part Number	List Price
Inch	SAE-6	ZDS		ZDS/S	
Metric	.25 BSPP	ZDS/M		ZDS/T	



LINE MOUNT BODIES



- Aluminum rated to 3000 psi.
- Ductile Iron rated to 5000 psi.

S2
T2A

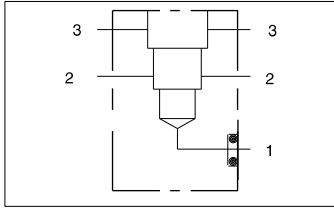

Flange mount through port .75" SAE Code 62 body with through pilot/drain port.

TYPICAL CARTRIDGES USED WITH THIS BODY

- RVEA - *** Page 1.18
 RSFC - *** Page 2.06
 SQFB - *** Page 2.08
 RSFE - *** Page 2.10
 SCEA - *** Page 2.12

Cartridge seal type determines O-ring type.

Instructions for ordering complete cartridge and body assemblies. Page v

Pressure ratings, material specifications. Page 11.02

SAE Specifications Page 11.03

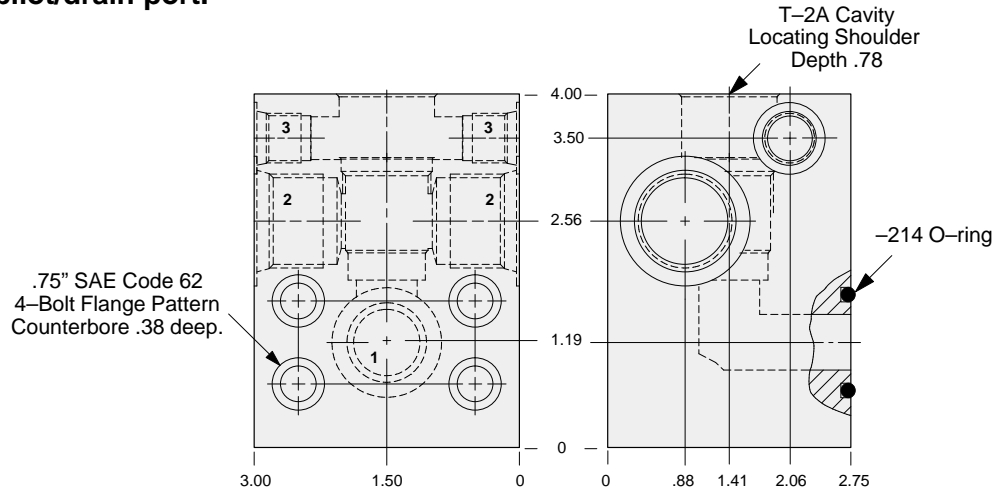

Mounting Hole Dimensions	Port 2	Port 3	ALUMINUM		DUCTILE IRON	
			Part Number	List Price	Part Number	List Price
Inch	.50 NPTF	.25 NPTF	WRA		WRA/S	
Inch	.75 NPTF	.25 NPTF	WRB		WRB/S	
Inch	SAE-10	SAE-6	WRC		WRC/S	
Inch	SAE-12	SAE-6	WRD		WRD/S	
Metric	.50 BSPP	.25 BSPP	WRE/M		WRE/T	
Metric	.75 BSPP	.25 BSPP	WRF/M		WRF/T	

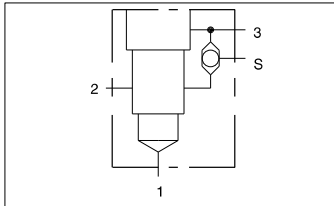

90 degree body with shuttle.

TYPICAL CARTRIDGES USED WITH THIS BODY

- CBEA - *** Page 4.10
 CBEG - *** Page 4.12
 CBEH - *** Page 4.14
 CKEB - *** Page 4.16

Instructions for ordering complete cartridge and body assemblies. Page v

Pressure ratings, material specifications. Page 11.02

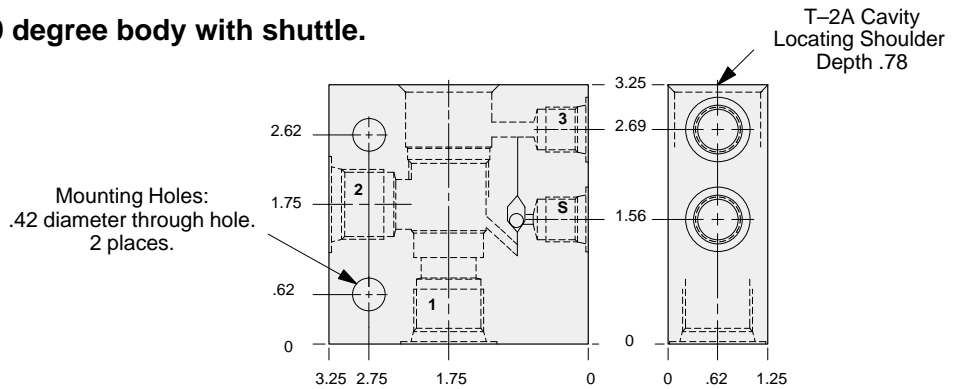

Ports 1 & 2	Ports 3 & S	ALUMINUM		DUCTILE IRON	
		Part Number	List Price	Part Number	List Price
.25 NPTF	.25 NPTF	BGA		BGA/S	
.375 NPTF	.25 NPTF	BGB		BGB/S	
.50 NPTF	.25 NPTF	BGC		BGC/S	
.75 NPTF	.25 NPTF	BGD		BGD/S	
SAE-6	SAE-6	BGI		BGI/S	
SAE-8	SAE-6	BGJ		BGJ/S	
SAE-10	SAE-6	BGK		BGK/S	
.25 BSPP	.25 BSPP	BGT		BGT/S	
.375 BSPP	.25 BSPP	BGU		BGU/S	
.50 BSPP	.25 BSPP	BGV		BGV/S	
.75 BSPP	.25 BSPP	BGW		BGW/S	



LINE MOUNT BODIES



- Aluminum rated to 3000 psi.
- Ductile Iron rated to 5000 psi.

S2
T2A

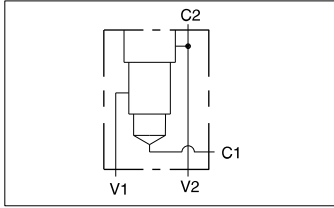

Nipple mount body for load control applications.

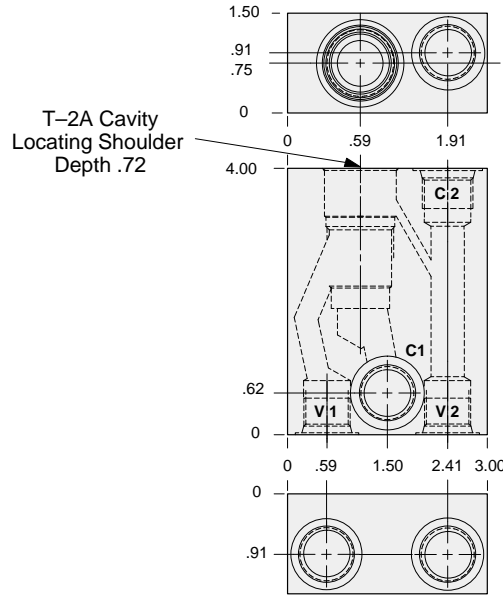

TYPICAL CARTRIDGES USED WITH THIS BODY

- CBEA - *** Page 4.10
- CBEG - *** Page 4.12
- CBEH - *** Page 4.14
- CKEB - *** Page 4.16

Instructions for ordering complete cartridge and body assemblies. Page v

Pressure ratings, material specifications. Page 11.02

All Ports	ALUMINUM		DUCTILE IRON	
	Part Number	List Price	Part Number	List Price
.50 NPTF	ZTX		ZTX/S	
SAE-8	ZRM		ZRM/S	

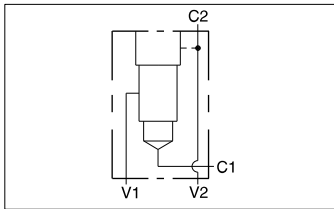

Gasket mount body for load control applications.

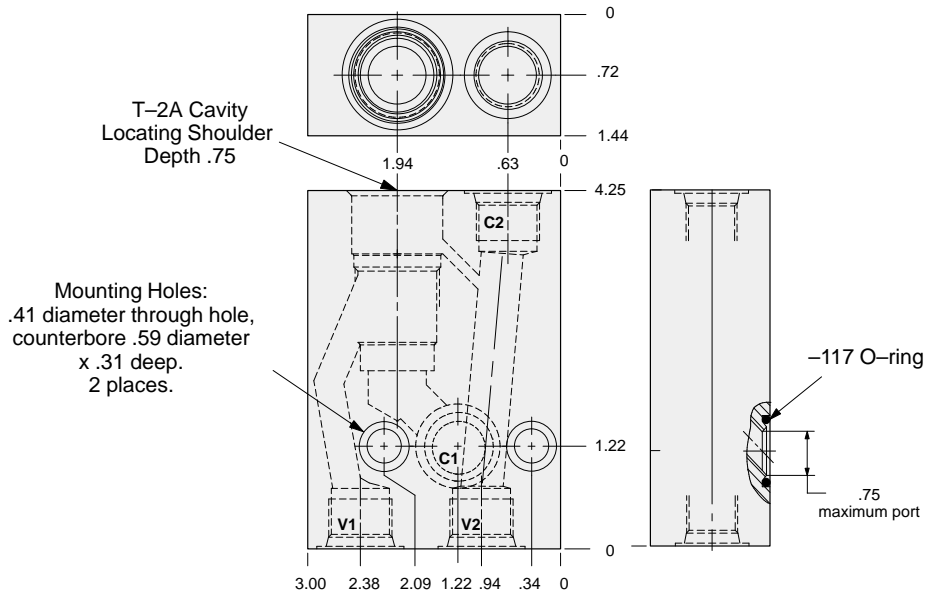

TYPICAL CARTRIDGES USED WITH THIS BODY

- CBEA - *** Page 4.10
- CBEG - *** Page 4.12
- CBEH - *** Page 4.14
- CKEB - *** Page 4.16

Cartridge seal type determines O-ring type.

Instructions for ordering complete cartridge and body assemblies. Page v

Pressure ratings, material specifications. Page 11.02

Ports C2, V1, & V2	ALUMINUM		DUCTILE IRON	
	Part Number	List Price	Part Number	List Price
.50 NPTF	ZTF		ZTF/S	
SAE-8	ZTG		ZTG/S	
.50 BSPP	ZTH		ZTH/S	



LINE MOUNT BODIES



- Aluminum rated to 3000 psi.
- Ductile Iron rated to 5000 psi.

S2
T2A

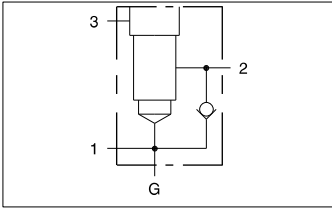

Body with reverse free flow check and gage port for reducing and reducing/relieving applications.

TYPICAL CARTRIDGES USED WITH THIS BODY

- | | |
|------------|-----------|
| PBFB - *** | Page 3.06 |
| PBFC - *** | Page 3.08 |
| PPFB - *** | Page 3.10 |
| PPFC - *** | Page 3.12 |

Cartridge seal type determines check valve seal type.

Instructions for ordering complete cartridge and body assemblies. Page v

Pressure ratings, material specifications. Page 11.02

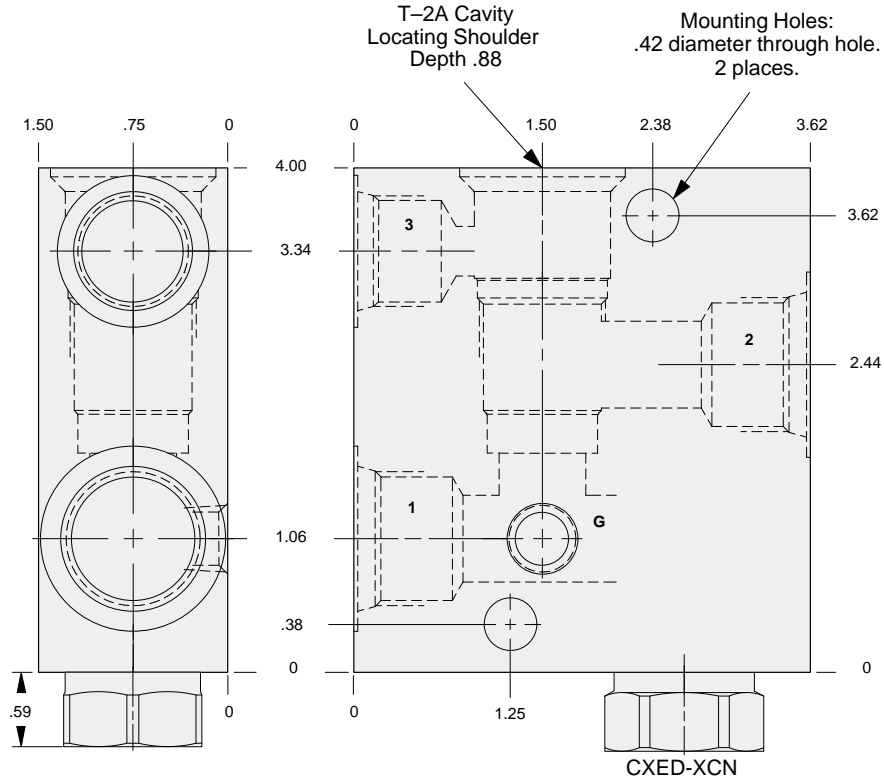

Ports 1 & 2	Port 3	Gage Port	ALUMINUM		DUCTILE IRON	
			Part Number	List Price	Part Number	List Price
.25 NPTF	.25 NPTF	.25 NPTF	B2A		B2A/S	
.375 NPTF	.25 NPTF	.25 NPTF	B2B		B2B/S	
.50 NPTF	.25 NPTF	.25 NPTF	B2C		B2C/S	
.75 NPTF	.25 NPTF	.25 NPTF	B2D		B2D/S	
SAE-6	SAE-6	.25 NPTF	B2I		B2I/S	
SAE-8	SAE-6	.25 NPTF	B2J		B2J/S	
SAE-10	SAE-6	.25 NPTF	B2K		B2K/S	
.375 BSPP	.25 BSPP	.25 BSPP	B2U		B2U/S	
.50 BSPP	.25 BSPP	.25 BSPP	B2V		B2V/S	
.75 BSPP	.25 BSPP	.25 BSPP	B2W		B2W/S	
.375 NPTF	.375 NPTF	.25 NPTF	B4B		B4B/S	
.50 NPTF	.50 NPTF	.25 NPTF	B4C		B4C/S	
.75 NPTF	.50 NPTF	.25 NPTF	B4D		B4D/S	
SAE-8	SAE-8	.25 NPTF	B4J		B4J/S	
SAE-10	SAE-10	.25 NPTF	B4K		B4K/S	
SAE-12	SAE-10	.25 NPTF	B4L		B4L/S	
.375 BSPP	.375 BSPP	.25 BSPP	B4U		B4U/S	
.50 BSPP	.50 BSPP	.25 BSPP	B4V		B4V/S	
.75 BSPP	.50 BSPP	.25 BSPP	B4W		B4W/S	



LINE MOUNT BODIES



- Aluminum rated to 3000 psi.
- Ductile Iron rated to 5000 psi.

S2
T2A

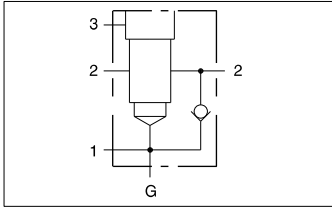

Through port body with reverse free flow check and gage port for reducing applications.

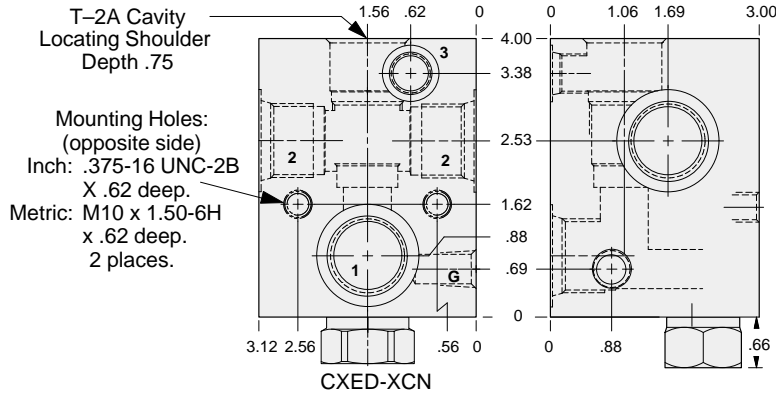

TYPICAL CARTRIDGES USED WITH THIS BODY

PBFB - *** Page 3.06
 PBFC - *** Page 3.08

Cartridge seal type determines check valve seal type.

Instructions for ordering complete cartridge and body assemblies. Page v

Pressure ratings, material specifications. Page 11.02

Mounting Hole Dimensions	Ports 1 & 2	Port 3	Gage Port	ALUMINUM		DUCTILE IRON	
				Part Number	List Price	Part Number	List Price
Inch	.375 NPTF	.25 NPTF	.25 NPTF	B3B		B3B/S	
Inch	.50 NPTF	.25 NPTF	.25 NPTF	B3C		B3C/S	
Inch	.75 NPTF	.25 NPTF	.25 NPTF	B3D		B3D/S	
Inch	SAE-8	SAE-6	.25 NPTF	B3J		B3J/S	
Inch	SAE-10	SAE-6	.25 NPTF	B3K		B3K/S	
Inch	SAE-12	SAE-6	.25 NPTF	B3L		B3L/S	
Metric	.375 BSPP	.25 BSPP	.25 BSPP	B3U		B3U/S	
Metric	.50 BSPP	.25 BSPP	.25 BSPP	B3V		B3V/S	
Metric	.75 BSPP	.25 BSPP	.25 BSPP	B3W		B3W/S	

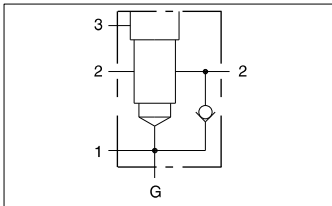

Through port body with high capacity port 3.

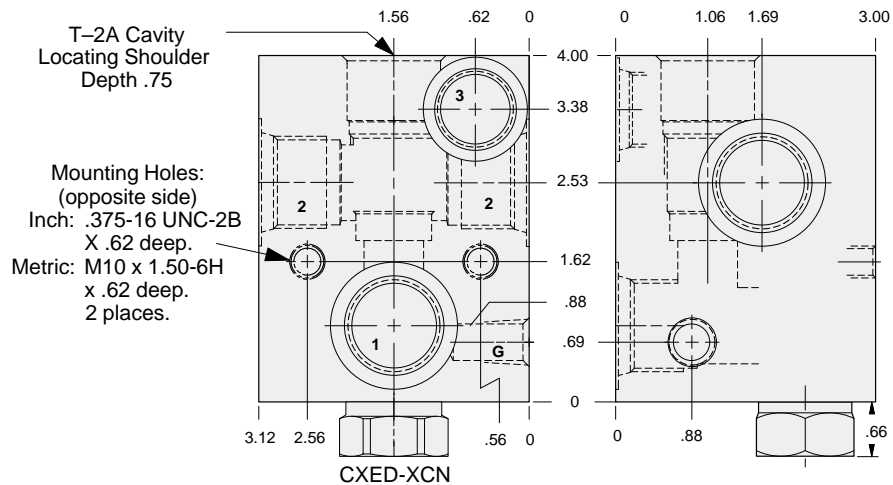

TYPICAL CARTRIDGES USED WITH THIS BODY

PPFB - *** Page 3.10
 PPFC - *** Page 3.12

Cartridge seal type determines check valve seal type.

Instructions for ordering complete cartridge and body assemblies. Page v

Pressure ratings, material specifications. Page 11.02

Mounting Hole Dimensions	Ports 1 & 2	Port 3	Gage Port	ALUMINUM		DUCTILE IRON	
				Part Number	List Price	Part Number	List Price
Inch	.50 NPTF	.50 NPTF	.25 NPTF	B5C		B5C/S	
Inch	.75 NPTF	.50 NPTF	.25 NPTF	B5D		B5D/S	
Inch	SAE-10	SAE-10	.25 NPTF	B5K		B5K/S	
Inch	SAE-12	SAE-10	.25 NPTF	B5L		B5L/S	
Metric	.50 BSPP	.50 BSPP	.25 BSPP	B5V		B5V/S	
Metric	.75 BSPP	.50 BSPP	.25 BSPP	B5W		B5W/S	



LINE MOUNT BODIES



- Aluminum rated to 3000 psi.
- Ductile Iron rated to 5000 psi.

S2
T2A

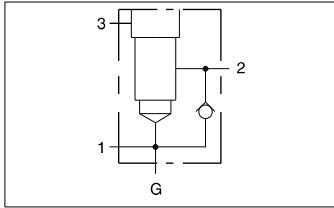

Body with reverse free flow check and gage port.

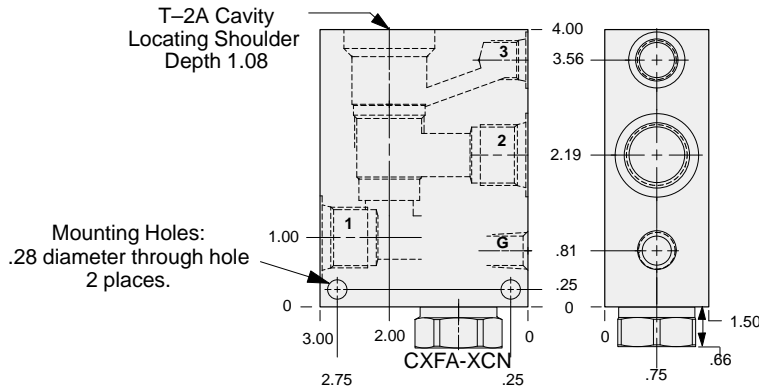

TYPICAL CARTRIDGES USED WITH THIS BODY

- RVEA - *** Page 1.18
 RSFC - *** Page 2.06
 SQFB - *** Page 2.08
 RSFE - *** Page 2.10

Cartridge seal type determines check valve seal type.

Instructions for ordering complete cartridge and body assemblies. Page v

Pressure ratings, material specifications. Page 11.02

Ports 1 & 2	Port 3	Gage Port	ALUMINUM		DUCTILE IRON	
			Part Number	List Price	Part Number	List Price
.25 NPTF	.25 NPTF	.25 NPTF	B6A		B6A/S	
.375 NPTF	.25 NPTF	.25 NPTF	B6B		B6B/S	
.50 NPTF	.25 NPTF	.25 NPTF	B6C		B6C/S	
.75 NPTF	.25 NPTF	.25 NPTF	B6D		B6D/S	
SAE-6	SAE-6	.25 NPTF	B6I		B6I/S	
SAE-8	SAE-6	.25 NPTF	B6J		B6J/S	
SAE-10	SAE-6	.25 NPTF	B6K		B6K/S	
.375 BSPP	.25 BSPP	.25 BSPP	B6U		B6U/S	
.50 BSPP	.25 BSPP	.25 BSPP	B6V		B6V/S	
.75 BSPP	.25 BSPP	.25 BSPP	B6W		B6W/S	

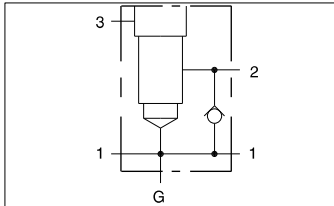

Through port body with reverse free flow check and gage port.

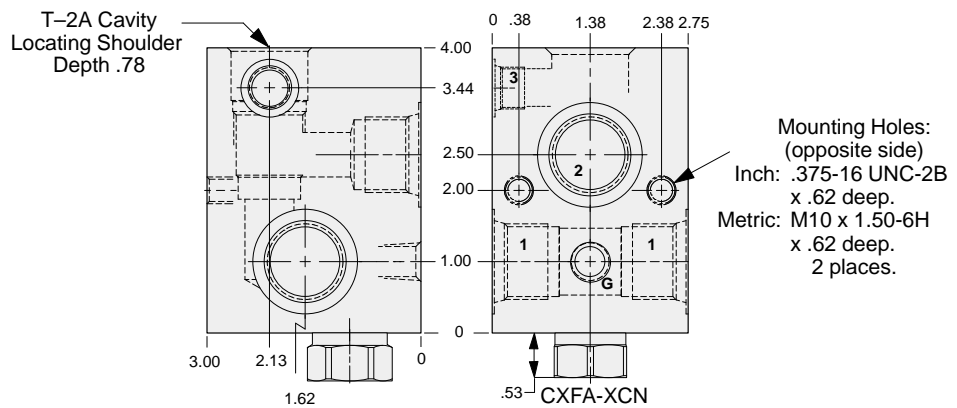

TYPICAL CARTRIDGES USED WITH THIS BODY

- RVEA - *** Page 1.18
 RSFC - *** Page 2.06
 SQFB - *** Page 2.08
 RSFE - *** Page 2.10

Cartridge seal type determines check valve seal type.

Instructions for ordering complete cartridge and body assemblies. Page v

Pressure ratings, material specifications. Page 11.02

Mounting Hole Dimensions	Ports 1 & 2	Port 3	Gage Port	ALUMINUM		DUCTILE IRON	
				Part Number	List Price	Part Number	List Price
Inch	.375 NPTF	.25 NPTF	.25 NPTF	B7B		B7B/S	
Inch	.50 NPTF	.25 NPTF	.25 NPTF	B7C		B7C/S	
Inch	.75 NPTF	.25 NPTF	.25 NPTF	B7D		B7D/S	
Inch	SAE-8	SAE-6	.25 NPTF	B7J		B7J/S	
Inch	SAE-10	SAE-6	.25 NPTF	B7K		B7K/S	
Inch	SAE-12	SAE-6	.25 NPTF	B7L		B7L/S	
Metric	.375 BSPP	.25 BSPP	.25 BSPP	B7U		B7U/S	
Metric	.50 BSPP	.25 BSPP	.25 BSPP	B7V		B7V/S	
Metric	.75 BSPP	.25 BSPP	.25 BSPP	B7W		B7W/S	



LINE MOUNT BODIES



- Aluminum rated to 3000 psi.
- Ductile Iron rated to 5000 psi.

S2
T2A

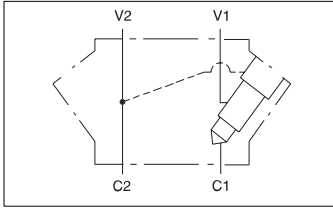

TYPICAL CARTRIDGES USED WITH THIS BODY

- CBEA - *** Page 4.10
- CBEG - *** Page 4.12
- CBEH - *** Page 4.14
- CKEB - *** Page 4.16

Instructions for ordering complete cartridge and body assemblies. Page v

Pressure ratings, material specifications. Page 11.02

Inline body for load control applications.

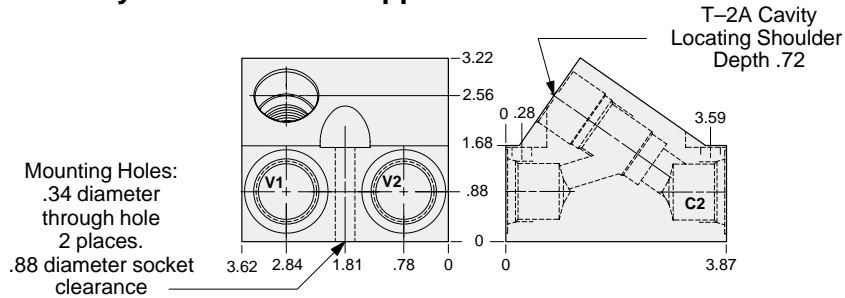

Ports C1, C2, & V1, V2	ALUMINUM		DUCTILE IRON	
	Part Number	List Price	Part Number	List Price
.25 NPTF	WPO		WPO/S	
.375 NPTF	WPP		WPP/S	
.50 NPTF	WPQ		WPQ/S	
.75 NPTF	WPR		WPR/S	
SAE-6	WPS		WPS/S	
SAE-8	WPT		WPT/S	
SAE-10	WPU		WPU/S	
SAE-12	WPV		WPV/S	
.25 BSPP	WPW		WPW/S	
.375 BSPP	WPX		WPX/S	
.50 BSPP	WPY		WPY/S	
.75 BSPP	WPZ		WPZ/S	

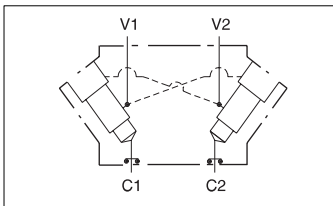

TYPICAL CARTRIDGES USED WITH THIS BODY

- CBEA - *** Page 4.10
- CBEG - *** Page 4.12
- CBEH - *** Page 4.14
- CKEB - *** Page 4.16

Cartridge seal type determines O-ring type.

Instructions for ordering complete cartridge and body assemblies. Page v

Pressure ratings, material specifications. Page 11.02

Two cavity inline gasket mount cross-piloted body for load control applications.

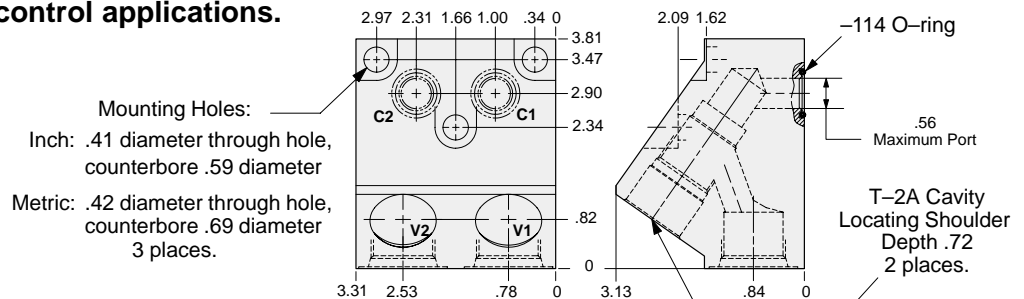

Ports V 1 & V 2	ALUMINUM		DUCTILE IRON	
	Part Number	List Price	Part Number	List Price
.25 NPTF	VYA		VYA/S	
.375 NPTF	VYB		VYB/S	
.50 NPTF	VYC		VYC/S	
.75 NPTF	VYD		VYD/S	
SAE-6	VYI		VYI/S	
SAE-8	VYJ		VYJ/S	
SAE-10	VYK		VYK/S	
SAE-12	VYL		VYL/S	
.25 BSPP	VYT		VYT/S	
.375 BSPP	VYU		VYU/S	
.50 BSPP	VYV		VYV/S	
.75 BSPP	VYW		VYW/S	



LINE MOUNT BODIES



- Aluminum rated to 3000 psi.
- Ductile Iron rated to 5000 psi.

S2
T2A

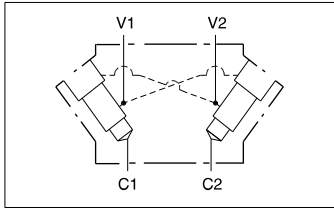

Two cavity inline cross-piloted body for load control applications.

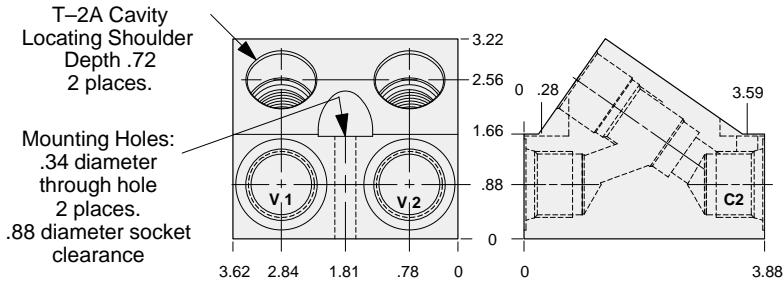

TYPICAL CARTRIDGES USED WITH THIS BODY

- CBEA - *** Page 4.10
 CBEG - *** Page 4.12
 CBEH - *** Page 4.14
 CKEB - *** Page 4.16

Instructions for ordering complete cartridge and body assemblies. Page v

Pressure ratings, material specifications. Page 11.02

Ports C1, C2, & V1, V2	ALUMINUM		DUCTILE IRON	
	Part Number	List Price	Part Number	List Price
.25 NPTF	XAA		XAA/S	
.375 NPTF	XAB		XAB/S	
.50 NPTF	XAC		XAC/S	
.75 NPTF	XAD		XAD/S	
SAE-6	XAI		XAI/S	
SAE-8	XAJ		XAJ/S	
SAE-10	XAK		XAK/S	
SAE-12	XAL		XAL/S	
.25 BSPP	XAT		XAT/S	
.375 BSPP	XAU		XAU/S	
.50 BSPP	XAV		XAV/S	
.75 BSPP	XAW		XAW/S	

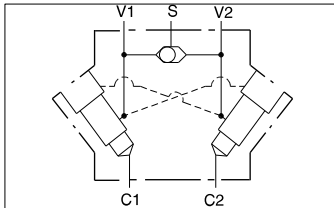

Two cavity inline cross-piloted body with shuttle for load control applications.

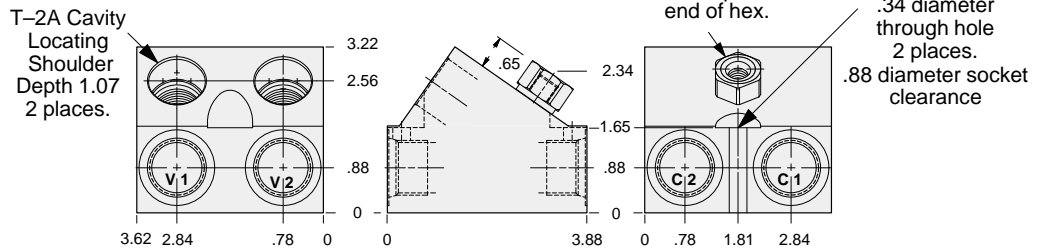

TYPICAL CARTRIDGES USED WITH THIS BODY

- CBEA - *** Page 4.10
 CBEG - *** Page 4.12
 CBEH - *** Page 4.14
 CKEB - *** Page 4.16

Cartridge seal type determines shuttle valve seal type.

Instructions for ordering complete cartridge and body assemblies. Page v

Pressure ratings, material specifications. Page 11.02

Ports C1, C2, & V1, V2	Shuttle Cartridge	Shuttle Port	ALUMINUM		DUCTILE IRON	
			Part Number	List Price	Part Number	List Price
.25 NPTF	CSAA - EXN	SAE-4	XHA		XHA/S	
.375 NPTF	CSAA - EXN	SAE-4	XHB		XHB/S	
.50 NPTF	CSAA - EXN	SAE-4	XHC		XHC/S	
.75 NPTF	CSAA - EXN	SAE-4	XHD		XHD/S	
SAE-6	CSAA - EXN	SAE-4	XHI		XHI/S	
SAE-8	CSAA - EXN	SAE-4	XHJ		XHJ/S	
SAE-10	CSAA - EXN	SAE-4	XHK		XHK/S	
SAE-12	CSAA - EXN	SAE-4	XHL		XHL/S	
.25 BSPP	CSAA - BXN	.25 BSPP	XHT		XHT/S	
.375 BSPP	CSAA - BXN	.25 BSPP	XHU		XHU/S	
.50 BSPP	CSAA - BXN	.25 BSPP	XHV		XHV/S	
.75 BSPP	CSAA - BXN	.25 BSPP	XHW		XHW/S	



LINE MOUNT BODIES



- Aluminum rated to 3000 psi.
- Ductile Iron rated to 5000 psi.

S2
T2A

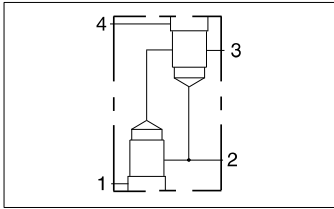

Two cavity body for flow control applications.

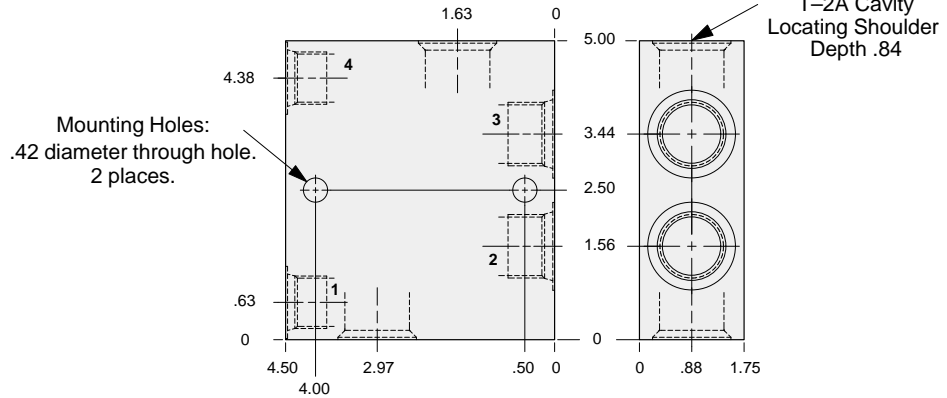

TYPICAL CARTRIDGES USED WITH THIS BODY

FRDA - *** Page 6.02

Instructions for ordering complete cartridge and body assemblies. Page v

Pressure ratings, material specifications. Page 11.02

Port 2 & 3	Port 1 & 4	ALUMINUM		DUCTILE IRON	
		Part Number	List Price	Part Number	List Price
.375 NPTF	.375 NPTF	VXN		VXN/S	
.50 NPTF	.50 NPTF	VXP		VXP/S	
.75 NPTF	.50 NPTF	VXQ		VXQ/S	
SAE-8	SAE-8	VXR		VXR/S	
SAE-10	SAE-10	VXS		VXS/S	
SAE-12	SAE-10	VXT		VXT/S	
.375 BSPP	.375 BSPP	VXU		VXU/S	
.50 BSPP	.50 BSPP	VXV		VXV/S	
.75 BSPP	.50 BSPP	VXW		VXW/S	

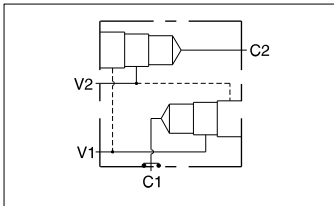

Two cavity gasket mount body for load control applications.

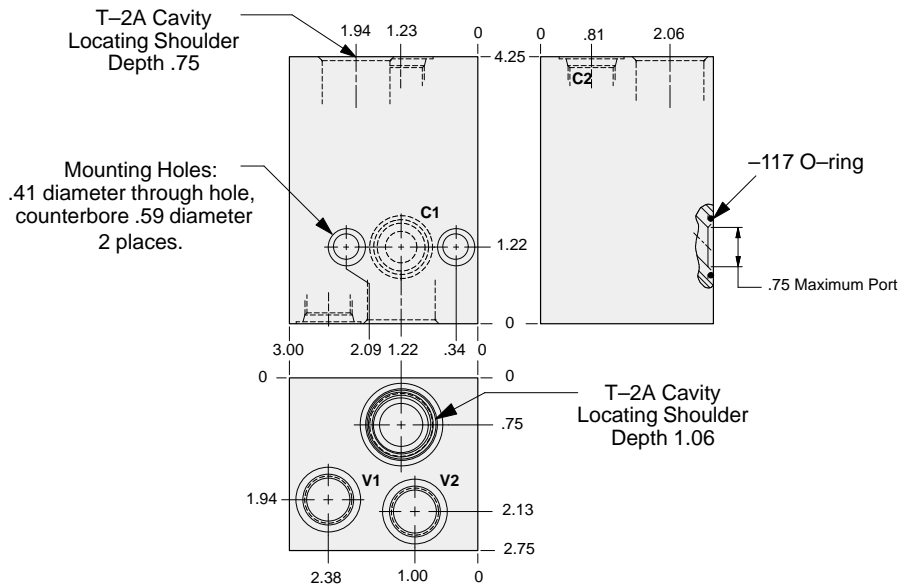

TYPICAL CARTRIDGES USED WITH THIS BODY

CBEA - *** Page 4.10
 CBEG - *** Page 4.12
 CBEH - *** Page 4.14
 CKEB - *** Page 4.16

Cartridge seal type determines O-ring type.

Instructions for ordering complete cartridge and body assemblies. Page v

Pressure ratings, material specifications. Page 11.02

Ports C2, V1 & V2	ALUMINUM		DUCTILE IRON	
	Part Number	List Price	Part Number	List Price
.50 NPTF	YVW		YVW/S	
SAE-8	YVV		YVV/S	
.50 BSPP	YVU		YVU/S	



LINE MOUNT BODIES



- Aluminum rated to 3000 psi.
- Ductile Iron rated to 5000 psi.

S2
T2A

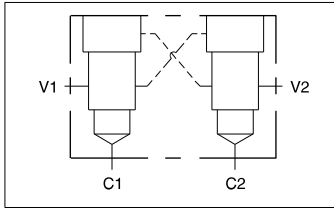

Two cavity 90 degree cross-piloted body for load control applications.

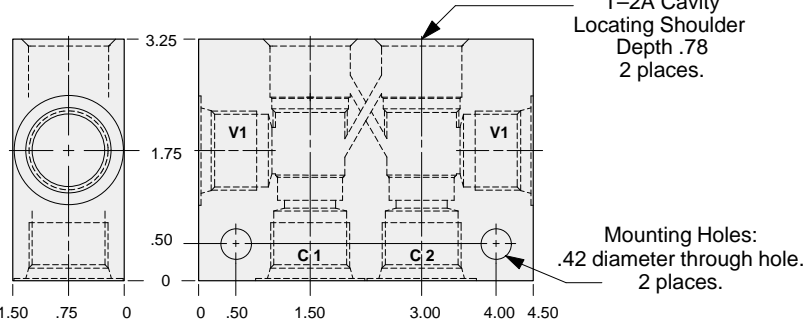

TYPICAL CARTRIDGES USED WITH THIS BODY

- CBEA - *** Page 4.10
 CBEG - *** Page 4.12
 CBEH - *** Page 4.14
 CKEB - *** Page 4.16

Instructions for ordering complete cartridge and body assemblies. Page v

Pressure ratings, material specifications. Page 11.02

Ports C1, C2, & V1, V2	ALUMINUM		DUCTILE IRON	
	Part Number	List Price	Part Number	List Price
.25 NPTF	YAA		YAA/S	
.375 NPTF	YAB		YAB/S	
.50 NPTF	YAC		YAC/S	
.75 NPTF	YAD		YAD/S	
SAE-6	YAI		YAI/S	
SAE-8	YAJ		YAJ/S	
SAE-10	YAK		YAK/S	
SAE-12	YAL		YAL/S	
.25 BSPP	YAT		YAT/S	
.375 BSPP	YAU		YAU/S	
.50 BSPP	YAV		YAV/S	

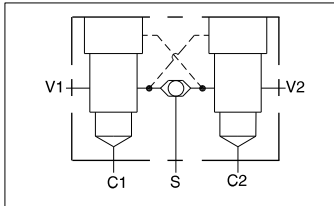

Two cavity 90 degree cross-piloted body with shuttle for load control applications.

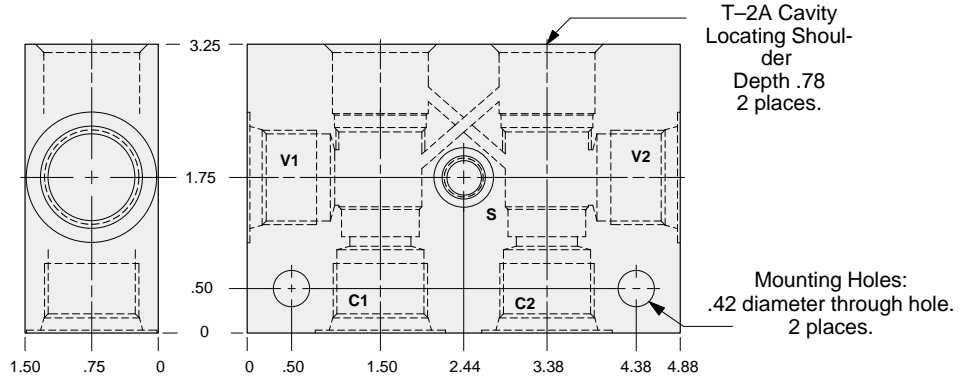

TYPICAL CARTRIDGES USED WITH THIS BODY

- CBEA - *** Page 4.10
 CBEG - *** Page 4.12
 CBEH - *** Page 4.14
 CKEB - *** Page 4.16

Instructions for ordering complete cartridge and body assemblies. Page v

Pressure ratings, material specifications. Page 11.02

Ports C1, C2, & V1, V2	Port S	ALUMINUM		DUCTILE IRON	
		Part Number	List Price	Part Number	List Price
.50 NPTF	.25 NPTF	YHC		YHC/S	
.75 NPTF	.25 NPTF	YHD		YHD/S	
SAE-10	SAE-4	YHK		YHK/S	
SAE-12	SAE-4	YHL		YHL/S	
.50 BSPP	.25 BSPP	YHV		YHV/S	
.75 BSPP	.25 BSPP	YHW		YHW/S	



LINE MOUNT BODIES



- Aluminum rated to 3000 psi.
- Ductile Iron rated to 5000 psi.

S2
T2A

Two cavity dual load control body with checks.

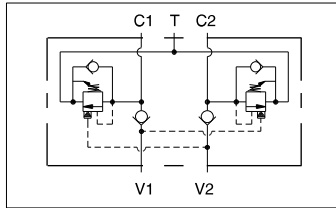
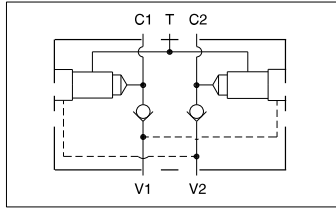

TYPICAL CARTRIDGES USED WITH THIS BODY

- CBEA - *** Page 4.10
 CBEG - *** Page 4.12
 CBEH - *** Page 4.14

Cartridge seal type determines check valve seal type.

Instructions for ordering complete cartridge and body assemblies. Page v

Pressure ratings, material specifications. Page 11.02

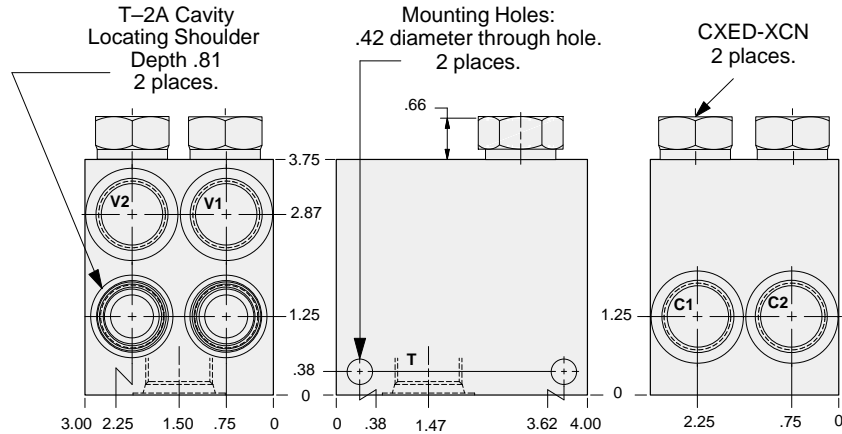

Ports C1, C2, & V1, V2	Port T	ALUMINUM		DUCTILE IRON	
		Part Number	List Price	Part Number	List Price
.50 NPTF	.75 NPTF	BMC		BMC/S	
.75 NPTF	.75 NPTF	BMD		BMD/S	
SAE-10	SAE-12	BMK		BMK/S	
SAE-12	SAE-12	BML		BML/S	
.50 BSPP	.75 BSPP	BMV		BMV/S	
.75 BSPP	.75 BSPP	BMW		BMW/S	

Discharge oil returns to tank through port T.

Two cavity dual load control body with checks and shuttle.

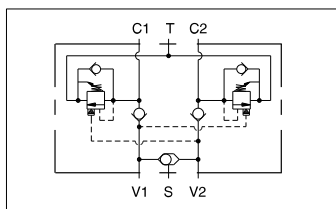
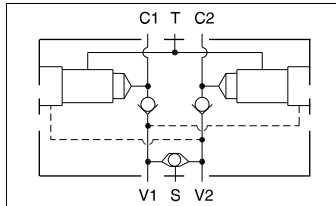

TYPICAL CARTRIDGES USED WITH THIS BODY

- CBEA - *** Page 4.10
 CBEG - *** Page 4.12
 CBEH - *** Page 4.14

Cartridge seal type determines check valve seal type.

Instructions for ordering complete cartridge and body assemblies. Page v

Pressure ratings, material specifications. Page 11.02

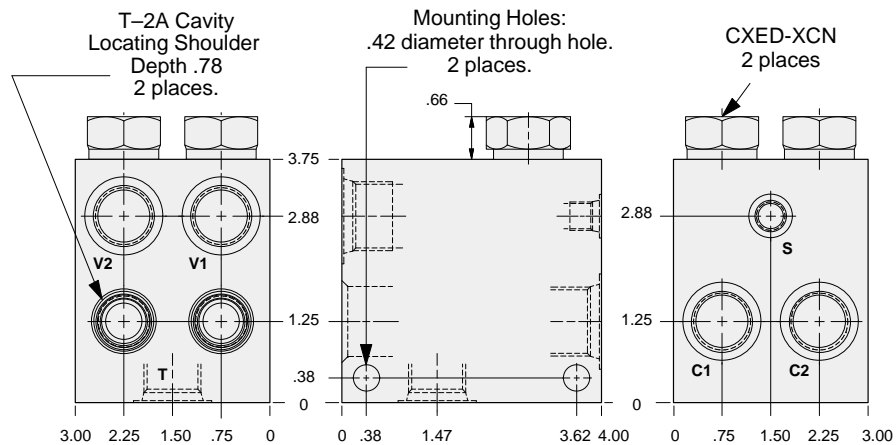

Ports C1, C2, & V1, V2	Port T	Port S	ALUMINUM		DUCTILE IRON	
			Part Number	List Price	Part Number	List Price
.50 NPTF	.75 NPTF	.25 NPTF	BNC		BNC/S	
.75 NPTF	.75 NPTF	.25 NPTF	BND		BND/S	
SAE-10	SAE-12	SAE-4	BNK		BNK/S	
SAE-12	SAE-12	SAE-4	BNL		BNL/S	
.50 BSPP	.75 BSPP	.25 BSPP	BNV		BNV/S	
.75 BSPP	.75 BSPP	.25 BSPP	BNW		BNW/S	

Discharge oil returns to tank through port T.



LINE MOUNT BODIES



- Aluminum rated to 3000 psi.
- Ductile Iron rated to 5000 psi.

S2
T2A

Two cavity dual load control body with make-up checks.

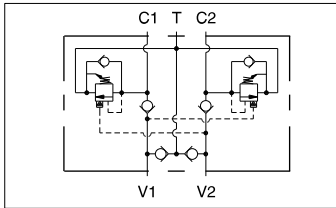
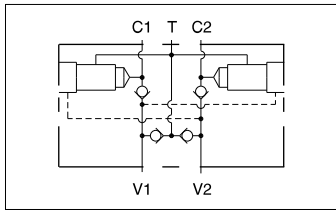

TYPICAL CARTRIDGES USED WITH THIS BODY

- CBEA - *** Page 4.10
 CBEG - *** Page 4.12
 CBEH - *** Page 4.14

Cartridge seal type determines check valve seal type.

Instructions for ordering complete cartridge and body assemblies. Page v

Pressure ratings, material specifications. Page 11.02

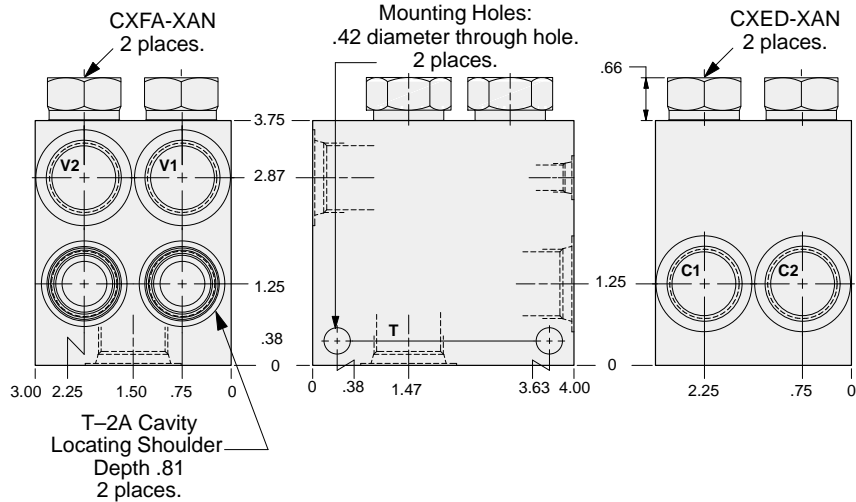

Ports C1, C2, & V1, V2	Port T	ALUMINUM		DUCTILE IRON	
		Part Number	List Price	Part Number	List Price
.50 NPTF	.75 NPTF	BPC		BPC/S	
.75 NPTF	.75 NPTF	BPD		BPD/S	
SAE-10	SAE-12	BPK		BPK/S	
SAE-12	SAE-12	BPL		BPL/S	
.50 BSPP	.75 BSPP	BPV		BPV/S	
.75 BSPP	.75 BSPP	BPW		BPW/S	

Discharge oil returns to tank through directional valve or port T.

Two cavity dual load control body with make-up checks and shuttle.

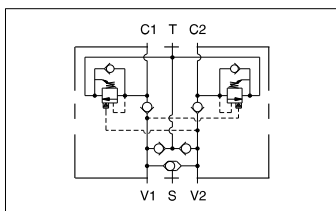
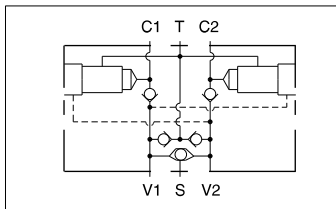

TYPICAL CARTRIDGES USED WITH THIS BODY

- CBEA - *** Page 4.10
 CBEG - *** Page 4.12
 CBEH - *** Page 4.14

Cartridge seal type determines check valve seal type.

Instructions for ordering complete cartridge and body assemblies. Page v

Pressure ratings, material specifications. Page 11.02

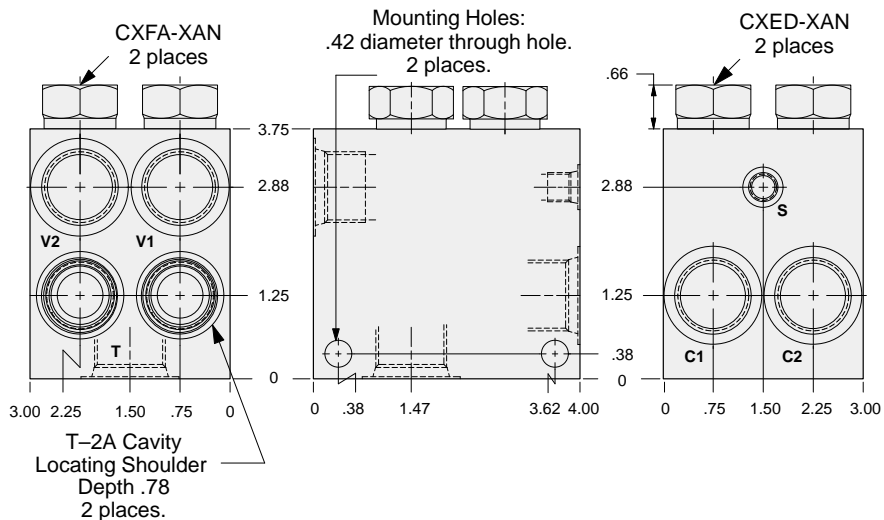

Ports C1, C2, & V1, V2	Port T	Port S	ALUMINUM		DUCTILE IRON	
			Part Number	List Price	Part Number	List Price
.50 NPTF	.75 NPTF	.25 NPTF	BQC		BQC/S	
.75 NPTF	.75 NPTF	.25 NPTF	BQD		BQD/S	
SAE-10	SAE-12	SAE-4	BQK		BQK/S	
SAE-12	SAE-12	SAE-4	BQL		BQL/S	
.50 BSPP	.75 BSPP	.25 BSPP	BQV		BQV/S	
.75 BSPP	.75 BSPP	.25 BSPP	BQW		BQW/S	

Discharge oil returns to tank through directional valve or port T.



LINE MOUNT BODIES



- Aluminum rated to 3000 psi.
- Ductile Iron rated to 5000 psi.

S2
T2A

Two cavity dual sequence body with reverse free flow checks.

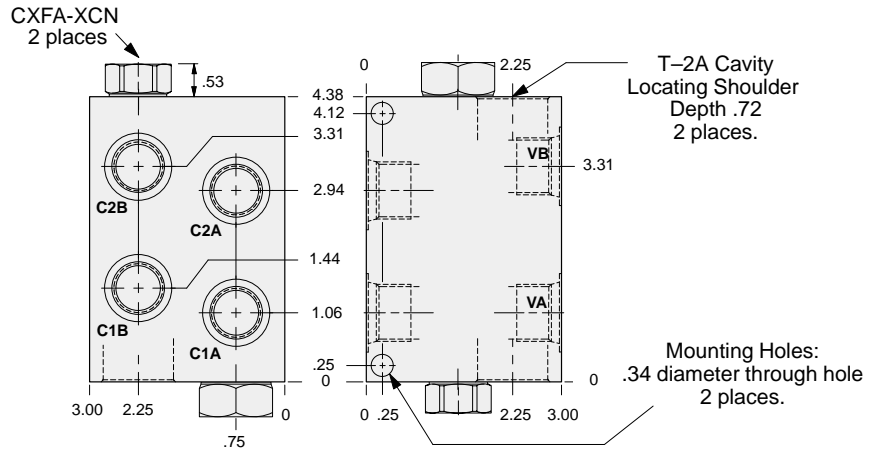
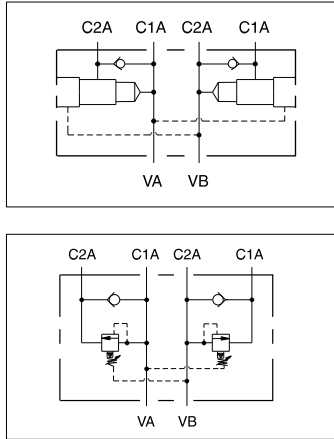

TYPICAL CARTRIDGES USED WITH THIS BODY

RSFC - *** Page 2.06
SQFB - *** Page 2.08

Cartridge seal type determines check valve seal type.

Instructions for ordering complete cartridge and body assemblies. Page v

Pressure ratings, material specifications. Page 11.02

All Ports	ALUMINUM		DUCTILE IRON	
	Part Number	List Price	Part Number	List Price
.375 NPTF	B8B		B8B/S	
.50 NPTF	B8C		B8C/S	
.75 NPTF	B8D		B8D/S	
SAE-8	B8J		B8J/S	
SAE-10	B8K		B8K/S	
.375 BSPP	B8U		B8U/S	
.50 BSPP	B8V		B8V/S	
.75 BSPP	B8W		B8W/S	

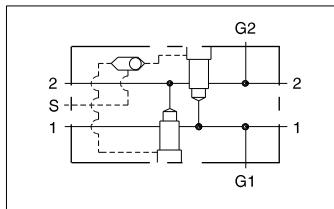

Two cavity through port body with shuttle and gage ports.

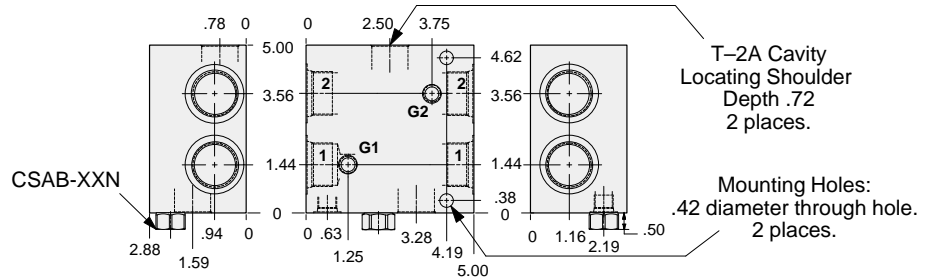

TYPICAL CARTRIDGES USED WITH THIS BODY

RVEA - *** Page 1.18

Cartridge seal type determines shuttle valve seal type.

Instructions for ordering complete cartridge and body assemblies. Page v

Pressure ratings, material specifications. Page 11.02

Ports 1 & 2	Ports G1 & G2	Port V	ALUMINUM		DUCTILE IRON	
			Part Number	List Price	Part Number	List Price
.375 NPTF	.25 NPTF	.25 NPTF	XBB		XBB/S	
.50 NPTF	.25 NPTF	.25 NPTF	XBC		XBC/S	
.75 NPTF	.25 NPTF	.25 NPTF	XBD		XBD/S	
1.00 NPTF	.25 NPTF	.25 NPTF	XBE		XBE/S	
SAE-6	.25 NPTF	SAE-6	XBI		XBI/S	
SAE-8	.25 NPTF	SAE-6	XBJ		XBJ/S	
SAE-10	.25 NPTF	SAE-6	XBK		XBK/S	
SAE-12	.25 NPTF	SAE-6	XBL		XBL/S	
SAE-16	.25 NPTF	SAE-6	XBM		XBM/S	
.375 BSPP	.25 BSPP	.25 BSPP	XBU		XBU/S	
.50 BSPP	.25 BSPP	.25 BSPP	XBV		XBV/S	
.75 BSPP	.25 BSPP	.25 BSPP	XBW		XBW/S	
1.00 BSPP	.25 BSPP	.25 BSPP	XBX		XBX/S	



LINE MOUNT BODIES



- Aluminum rated to 3000 psi.
- Ductile Iron rated to 5000 psi.

S2
T2A

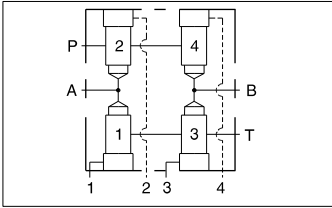

Four cavity four-way logic body for directional applications.

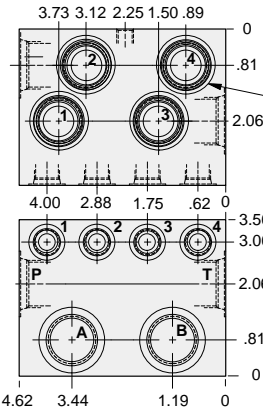

T-2A Cavity
Locating Shoulder
Depth .72
4 places.

Mounting Holes:
Inch: .375-16 UNC-2B
x .62 deep.
Metric: M10 x 1.50-6H
x .62 deep.
2 places.

TYPICAL CARTRIDGES USED WITH THIS BODY

- LOFC - *** Page 9.08
LKFC - *** Page 9.10
LPFC - *** Page 9.12
LRFC - *** Page 9.14

Instructions for ordering complete cartridge and body assemblies. Page v

Pressure ratings, material specifications. Page 11.02

Mounting Hole Dimensions	Ports A & B P & T	Ports 1 & 2, 3 & 4	ALUMINUM		DUCTILE IRON	
			Part Number	List Price	Part Number	List Price
Inch	.375 NPTF	.25 NPTF	YPZ		YPZ/S	
Inch	.50 NPTF	.25 NPTF	YPY		YPY/S	
Inch	.75 NPTF	.25 NPTF	YPX		YPX/S	
Inch	SAE-8	SAE-6	YPW		YPW/S	
Inch	SAE-10	SAE-6	YPV		YPV/S	
Inch	SAE-12	SAE-6	YPT		YPT/S	
Metric	.375 BSPP	.25 BSPP	YPP		YPP/S	
Metric	.50 BSPP	.25 BSPP	YPM		YPM/S	
Metric	.75 BSPP	.25 BSPP	YPQ		YPQ/S	

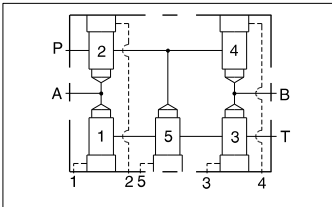

Five cavity four-way logic body for directional applications.

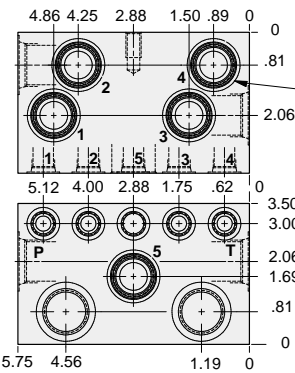

T-2A Cavity
Locating Shoulder
Depth .72
5 places.

Mounting Holes:
Inch: .375-16 UNC-2B
x .62 deep.
Metric: M10 x 1.50-6H
x .62 deep.
2 places.

TYPICAL CARTRIDGES USED WITH THIS BODY

- LOFC - *** Page 9.08
LKFC - *** Page 9.10
LPFC - *** Page 9.12
LRFC - *** Page 9.14

Instructions for ordering complete cartridge and body assemblies. Page v

Pressure ratings, material specifications. Page 11.02

Mounting Hole Dimensions	Ports A & B P & T	Ports 1, 2, 3, 4, & 5	ALUMINUM		DUCTILE IRON	
			Part Number	List Price	Part Number	List Price
Inch	.375 NPTF	.25 NPTF	YPO		YPO/S	
Inch	.50 NPTF	.25 NPTF	YPN		YPN/S	
Inch	.75 NPTF	.25 NPTF	YPS		YPS/S	
Inch	SAE-8	SAE-6	YPL		YPL/S	
Inch	SAE-10	SAE-6	YPK		YPK/S	
Inch	SAE-12	SAE-6	YPJ		YPJ/S	
Metric	.375 BSPP	.25 BSPP	YPH		YPH/S	
Metric	.50 BSPP	.25 BSPP	YPG		YPG/S	
Metric	.75 BSPP	.25 BSPP	YPF		YPF/S	