



LINE MOUNT BODIES



- Aluminum rated to 3000 psi.
- Ductile Iron rated to 5000 psi.

S2
T32A

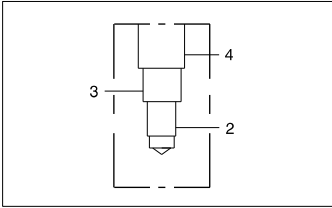

Body for flow divider/combiner applications.

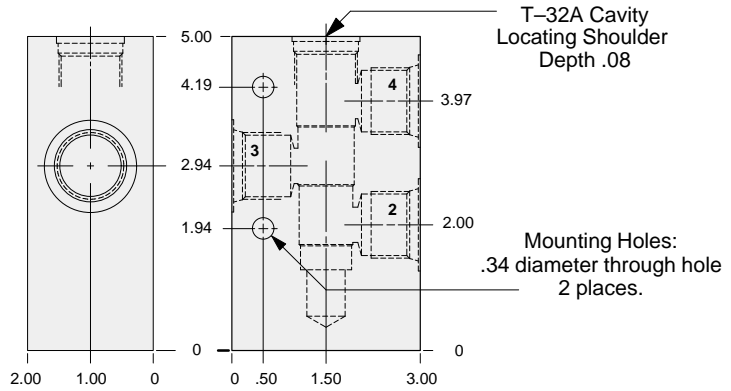

TYPICAL CARTRIDGES USED WITH THIS BODY

- FSDD - *** Page 7.08
- FSDA - *** Page 7.10
- FSDS - *** Page 7.12
- FSDH - *** Page 7.14

Instructions for ordering complete cartridge and body assemblies. Page v

Pressure ratings, material specifications. Page 11.02

Ports 2, 3, & 4	ALUMINUM		DUCTILE IRON	
	Part Number	List Price	Part Number	List Price
.375 NPTF	NMB		NMB/S	
.50 NPTF	NMC		NMC/S	
.75 NPTF	NMD		NMD/S	
SAE-8	NMJ		NMJ/S	
SAE-10	NMK		NMK/S	
SAE-12	NML		NML/S	
.375 BSPP	NMU		NMU/S	
.50 BSPP	NMV		NMV/S	
.75 BSPP	NMW		NMW/S	

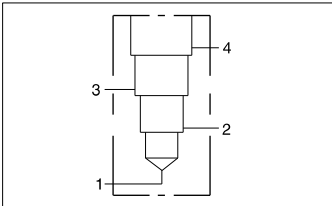

Four port body.

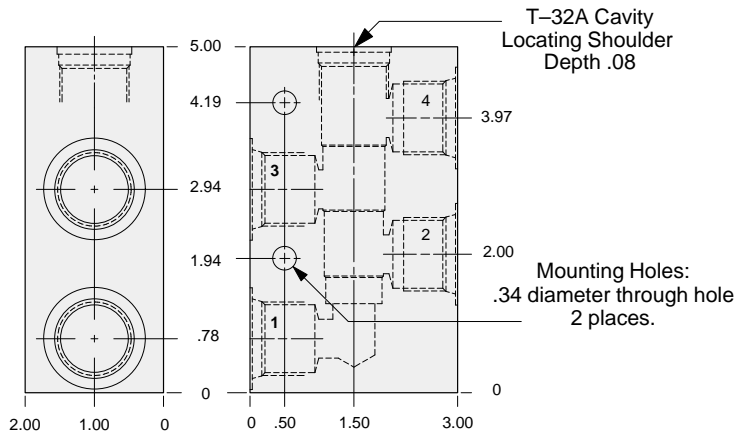

Instructions for ordering complete cartridge and body assemblies. Page v

Pressure ratings, material specifications. Page 11.02

Ports 1, 2, 3, 4, & 5	ALUMINUM		DUCTILE IRON	
	Part Number	List Price	Part Number	List Price
.375 NPTF	NNB		NNB/S	
.50 NPTF	NNC		NNC/S	
.75 NPTF	NND		NND/S	
SAE-8	NNJ		NNJ/S	
SAE-10	NNK		NNK/S	
SAE-12	NNL		NNL/S	
.375 BSPP	NNU		NNU/S	
.50 BSPP	NNV		NNV/S	
.75 BSPP	NNW		NNW/S	