

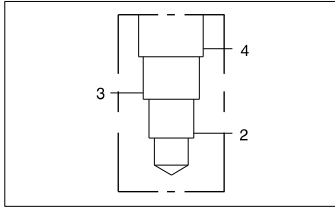

# LINE MOUNT BODIES



- Aluminum rated to 3000 psi.
- Ductile Iron rated to 5000 psi.



## Body for flow divider/combiner applications

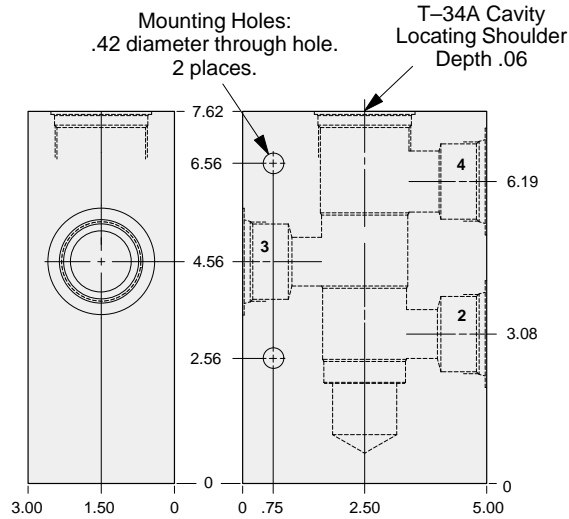

### TYPICAL CARTRIDGES USED WITH THIS BODY

FSFD - ***	Page 7.09
FSFA - ***	Page 7.11
FSFS - ***	Page 7.13
FSFH - ***	Page 7.15
DSIH - ***	Page 10.07

Instructions for ordering complete cartridge and body assemblies. Page v

Pressure ratings, material specifications. Page 11.02

Ports 2, 3, & 4	ALUMINUM		DUCTILE IRON	
	Part Number	List Price	Part Number	List Price
1.00 NPTF	QME		QME/S	
1.25 NPTF	QMF		QMF/S	
SAE-16	QMM		QMM/S	
SAE-20	QMN		QMN/S	
1.00 BSPP	QMX		QMX/S	
1.25 BSPP	QMY		QMY/S	

S4  
T34A

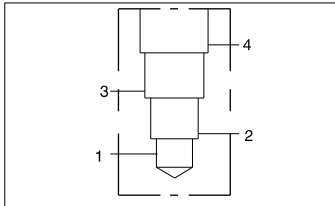

## Four port body.

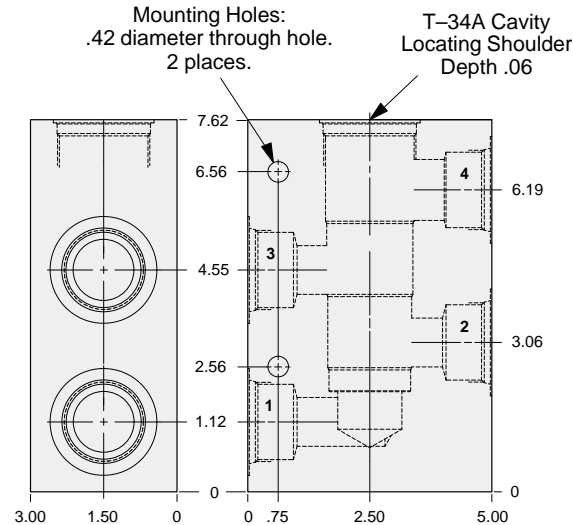

Instructions for ordering complete cartridge and body assemblies. Page v

Pressure ratings, material specifications. Page 11.02

Ports 2, 3, & 4	ALUMINUM		DUCTILE IRON	
	Part Number	List Price	Part Number	List Price
1.00 NPTF	QNE		QNE/S	
1.25 NPTF	QNF		QNF/S	
SAE-16	QNM		QNM/S	
SAE-20	QNN		QNN/S	
1.00 BSPP	QNX		QNX/S	
1.25 BSPP	QNY		QNY/S	



# LINE MOUNT BODIES



- Aluminum rated to 3000 psi.
- Ductile Iron rated to 5000 psi.

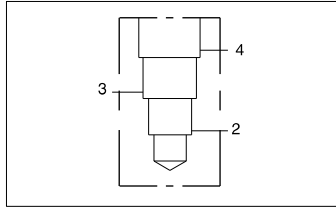

## 1.00" SAE Code 61 flange port body for flow divider/combiner applications.

1.00" SAE Code 61  
4-Bolt Flange Pattern  
3 places.

T-34A Cavity  
Locating Shoulder  
Depth .06

Mounting Holes:  
Inch: .375-16 UNC-2B  
x .62 deep.  
Metric: M10 x 1.50-6H  
x .62 deep.  
2 places.

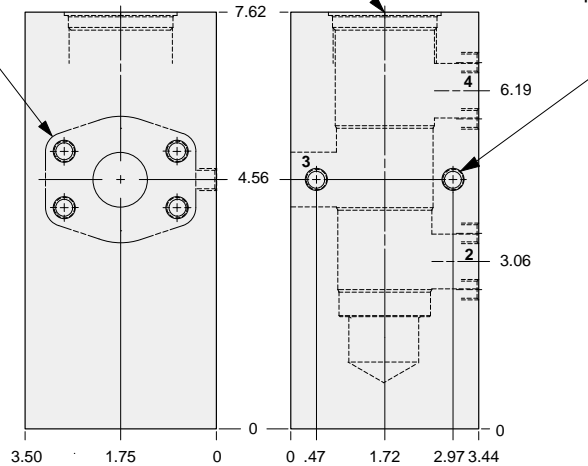

### TYPICAL CARTRIDGES USED WITH THIS BODY

- FSFD - \*\*\* Page 7.09
- FSFA - \*\*\* Page 7.11
- FSFS - \*\*\* Page 7.13
- FSFH - \*\*\* Page 7.15
- DSIH - \*\*\* Page 10.07

Instructions for ordering complete cartridge and body assemblies. Page v

Pressure ratings, material specifications. Page 11.02

SAE Specifications Page 11.03

Mounting Hole Dimensions	ALUMINUM		DUCTILE IRON	
	Part Number	List Price	Part Number	List Price
Inch	<b>QMP</b>		<b>QMP/S</b>	
Metric	<b>QMP/M</b>		<b>QMP/T</b>	

S4  
T34A

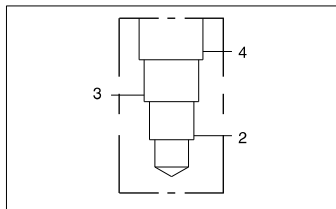

## 1.00" SAE Code 62 flange port body for flow divider/combiner applications.

1.00" SAE Code 62  
4-Bolt Flange Pattern  
3 places.

T-34A Cavity  
Locating Shoulder  
Depth .06

Mounting Holes:  
Inch: .375-16 UNC-2B  
x .62 deep.  
Metric: M10 x 1.50-6H  
x .62 deep.  
2 places.

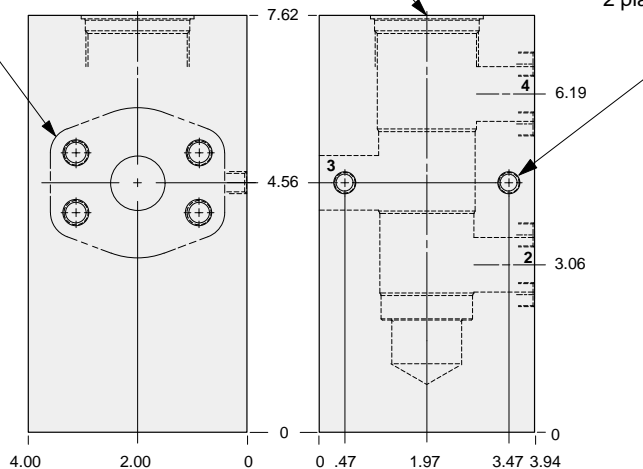

### TYPICAL CARTRIDGES USED WITH THIS BODY

- FSFD - \*\*\* Page 7.09
- FSFA - \*\*\* Page 7.11
- FSFS - \*\*\* Page 7.13
- FSFH - \*\*\* Page 7.15
- DSIH - \*\*\* Page 10.07

Instructions for ordering complete cartridge and body assemblies. Page v

Pressure ratings, material specifications. Page 11.02

SAE Specifications Page 11.03

Mounting Hole Dimensions	ALUMINUM		DUCTILE IRON	
	Part Number	List Price	Part Number	List Price
Inch	<b>QM4</b>		<b>QM4/S</b>	
Metric	<b>QM4/M</b>		<b>QM4/T</b>	



# LINE MOUNT BODIES



- Aluminum rated to 3000 psi.
- Ductile Iron rated to 5000 psi.

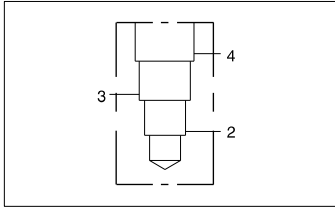

## 1.25" SAE Code 61 flange port body for flow divider/combiner applications.

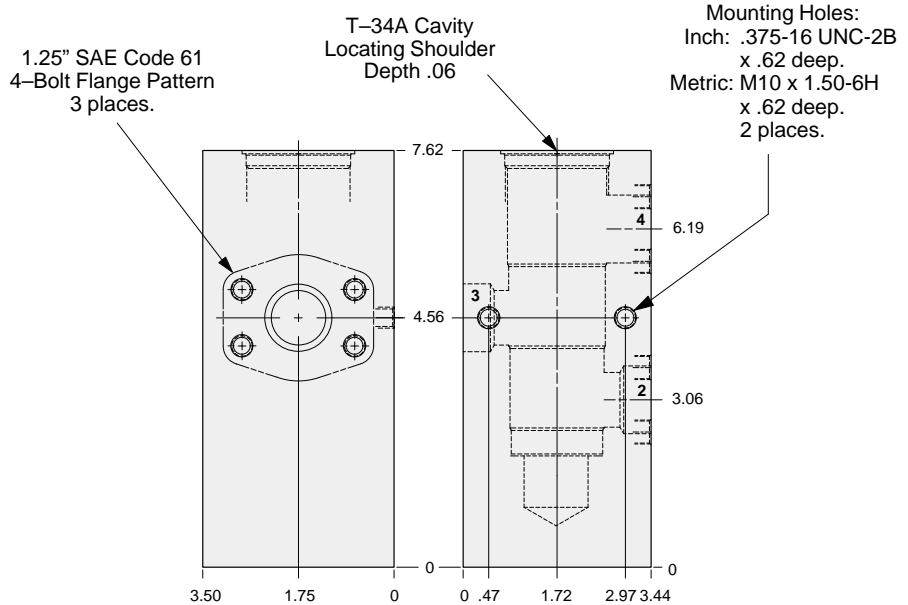

### TYPICAL CARTRIDGES USED WITH THIS BODY

- FSFD - \*\*\* Page 7.09
- FSFA - \*\*\* Page 7.11
- FSFS - \*\*\* Page 7.13
- FSFH - \*\*\* Page 7.15
- DSIH - \*\*\* Page 10.07

Instructions for ordering complete cartridge and body assemblies. Page v

Pressure ratings, material specifications. Page 11.02

SAE Specifications Page 11.03

Mounting Hole Dimensions	ALUMINUM		DUCTILE IRON	
	Part Number	List Price	Part Number	List Price
Inch	QM <sub>Q</sub>		QM <sub>Q/S</sub>	
Metric	QM <sub>Q/M</sub>		QM <sub>Q/T</sub>	

S4  
T34A

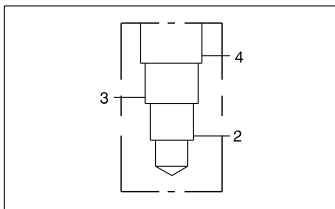

## 1.25" SAE Code 62 flange port body for flow divider/combiner applications.

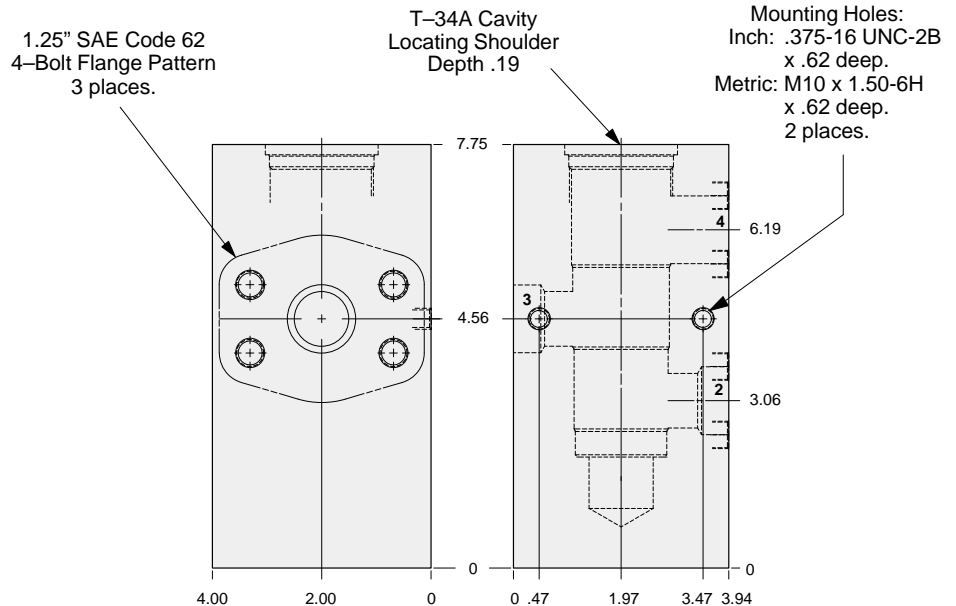

### TYPICAL CARTRIDGES USED WITH THIS BODY

- FSFD - \*\*\* Page 7.09
- FSFA - \*\*\* Page 7.11
- FSFS - \*\*\* Page 7.13
- FSFH - \*\*\* Page 7.15
- DSIH - \*\*\* Page 10.07

Instructions for ordering complete cartridge and body assemblies. Page v

Pressure ratings, material specifications. Page 11.02

SAE Specifications Page 11.03

Mounting Hole Dimensions	ALUMINUM		DUCTILE IRON	
	Part Number	List Price	Part Number	List Price
Inch	QM <sub>5</sub>		QM <sub>5/S</sub>	
Metric	QM <sub>5/M</sub>		QM <sub>5/T</sub>	



# LINE MOUNT BODIES



- Aluminum rated to 3000 psi.
- Ductile Iron rated to 5000 psi.

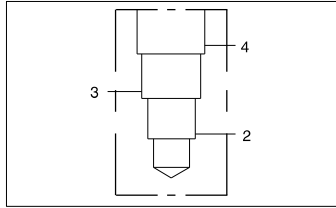

## 1.50" SAE Code 61 flange port body for flow divider/combiner applications.

### TYPICAL CARTRIDGES USED WITH THIS BODY

- FSFD - \*\*\* Page 7.09
- FSFA - \*\*\* Page 7.11
- FSFS - \*\*\* Page 7.13
- FSFH - \*\*\* Page 7.15
- DSIH - \*\*\* Page 10.07

Instructions for ordering complete cartridge and body assemblies. Page v

Pressure ratings, material specifications. Page 11.02

SAE Specifications Page 11.03

1.50" SAE Code 61 4-Bolt Flange Pattern

T-34A Cavity Locating Shoulder Depth .06

Mounting Holes:  
Inch: .375-16 UNC-2B x .62 deep.  
Metric: M10 x 1.50-6H x .62 deep.  
2 places.

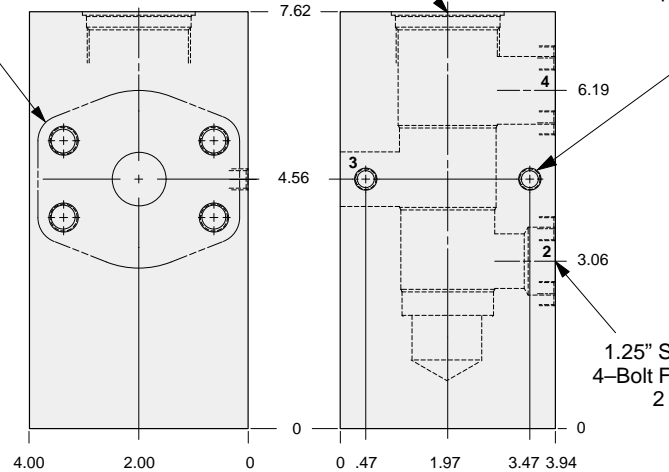

1.25" SAE Code 61 4-Bolt Flange Pattern 2 places.

Mounting Hole Dimensions	ALUMINUM		DUCTILE IRON	
	Part Number	List Price	Part Number	List Price
Inch	QMR		QMR/S	
Metric	QMR/M		QMR/T	

S4 T34A

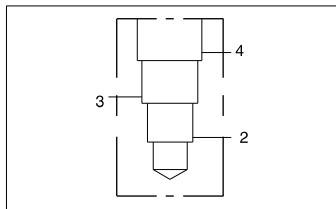

## 1.50" SAE Code 62 flange port body for flow divider/combiner applications.

### TYPICAL CARTRIDGES USED WITH THIS BODY

- FSFD - \*\*\* Page 7.09
- FSFA - \*\*\* Page 7.11
- FSFS - \*\*\* Page 7.13
- FSFH - \*\*\* Page 7.15
- DSIH - \*\*\* Page 10.07

Instructions for ordering complete cartridge and body assemblies. Page v

Pressure ratings, material specifications. Page 11.02

SAE Specifications Page 11.03

1.50" SAE Code 62 4-Bolt Flange Pattern

T-34A Cavity Locating Shoulder Depth .19

Mounting Holes:  
Inch: .375-16 UNC-2B x .62 deep.  
Metric: M10 x 1.50-6H x .62 deep.  
2 places.

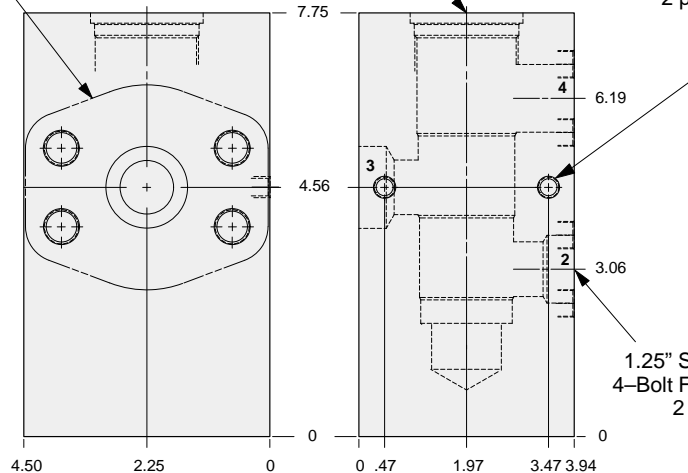

1.25" SAE Code 62 4-Bolt Flange Pattern 2 places.

Mounting Hole Dimensions	ALUMINUM		DUCTILE IRON	
	Part Number	List Price	Part Number	List Price
Inch	QM6		QM6/S	
Metric	QM6/M		QM6/T	